

2022
February

HOOK UP

SPECIFICATION GUIDE

three h

General Information	3-6
General Information	3
Terms & Conditions of Sales	4
Limited Lifetime Warranty	5
Environmental Sustainability	6
Specifications	7-17
Title Page	7
General Furniture Specs	8
Hook Up Finishes	9
Main Features	10-11
Constructions Specs	12
Accessory Mounting	13
Power Specifications	14-17
Typicals	18-21

Prices subject to change without notice.

H00K UP

EFFECTIVE FEBRUARY 1, 2022

Hook Up

Specification Guide

Hook Up is built for agility. Every table and privacy panel connects through a rail, making it a snap to reconfigure workplaces by hooking them together or breaking them apart on the fly.

Tables in the Hook Up collection cover a range of working spaces, including lounge/meeting, team/meeting, flexible closed and open spaces, multi-functional/collaborative meeting and training rooms.

Available on CET Designer.

Please contact customer service for assistance.
quotes@three-h.com

Visit www.three-h.com for downloadable marketing material & images

QUOTATIONS

Three H can only provide quotations to registered dealers. Standard quotations are valid for a period of thirty (30) days unless otherwise specified. Registered project quotations are valid for a period of sixty (60) days unless otherwise specified.

PRICING

All pricing is subject to change without notice. Prices are subject to any provincial or state taxes & are confirmed at time of invoice.

ORDER SUBMISSION

An official purchase order is required for all purchases. PO's may be submitted by email to orders@three-h.com or by fax at 1-888-484-5786. The following information is required on all purchase orders:

Company name, purchase order number, delivery address & contract number, Three H quotation number(s) or project registration number (if applicable), décor selections (tops, fronts, décor, trim, fabric), total net pricing including dealer discounts and any applicable freight & tax amounts.

CONFIRMATIONS

After receiving a purchase order, Three H will provide a confirmation along with estimated ship dates. If any discrepancies exist, Three H will provide a deficiency report outlining the details. If you do not receive a confirmation within 48 hours of submission, please contact customer service for verification.

DEPOSIT REQUIREMENTS

Deposits may be required on large volume orders & can be requested by Three H at quotation stage or at time of purchase order.

ORDER CHANGES AND CANCELLATIONS

Canceled orders may be subject to re-stocking fees. Re-stocking fees are a percentage net (including full amount) depending on their status in production. All Three H is product is 'made to order' and does not come from a stocking program. Product returns must be authorized by Three H prior to being sent back. A return authorization number will be issued by our warranty/claims department upon approval. All product being returned must be packaged securely in a similar manner as it was delivered. Product returned damaged will be refused.

REPLACEMENTS

Replacement components can be requested from replacements@three-h.com or by calling 1.800.767.5374 ext. 235. Please have original Three H order number available when requesting replacements parts. Any installation and labor charges related to warranty replacements must be reviewed & approved by Three H prior to being reimbursed. Three H does not reimburse for concealed freight damages or damages that occur during installation.

WARRANTY

Three H Furniture Systems offers a limited lifetime warranty on all products. For detailed information, please review our full warranty policy.

FREIGHT INFORMATION

MINIMUM FREIGHT CHARGES

Quotes exceeding \$5000 List will be subject to a 4% freight surcharge to Net pricing. Quotes under \$5000 List will have a \$175 charge applied.

ALTERNATE SHIP TO LOCATIONS

If alternate ship to locations other than dealer dock is required, additional freight charges may apply. Please contact Three H Customer Service to verify prior to submitting PO.

ADDITIONAL CHARGES

Additional shipping charges may also apply for direct to site delivery, weekend delivery, storage fees, gate services, call ahead notices, excessive unload times or other custom freight requests. Please contact customer service for any freight related questions.

DAMAGED PRODUCT

All merchandise is inspected and packed prior to shipment. It is the responsibility for the dealer to inspect packaging thoroughly upon delivery for any damages prior to accepting delivery. Obvious damages or shortages should be noted on the freight bill (bill of lading) and a claim filed immediately with Three H. Concealed damage should be reported to Three H immediately upon discovery. Any claims against Three H for apparent defects, errors or shortages must be made by the purchaser, in writing, within ten (10) working days after delivery. Failure to make a claim within ten (10) days shall constitute acceptance of the goods and a waiver of any apparent defects, errors or shortages.

Limited Lifetime Warranty

HOOK UP

Three H Furniture Systems Limited ('Three H') provides a limited lifetime warranty on all products sold to the original purchaser by a Three H authorized dealer. Three H warrants that its product will remain functional¹ for as long as the original purchaser owns the product. The obligation of Three H under this warranty is to repair or replace with a comparable product or component determined to be defective by Three H at no cost to the original purchaser, FOB purchaser's destination.

¹ Remain Functional refers to the products ability to fulfill its original purpose or function.

Updated November 2018

EXCEPTIONS TO THIS WARRANTY MAY INCLUDE:

- Three H provides a full warranty on our bullnose, wavecrest and prestige wood trim and finish for a period of 3 years after date of delivery. After 3 years, the warranty applies to the wood edge only. General wear and fading of the finish after a 3 year period is not considered a defect.
- Three H provides a full warranty on our Workshelf wood legs and finish for a period of 3 years after date of delivery. After 3 years, the warranty applies to the leg only. General wear and fading of the finish after a 3 year period is not considered a defect.
- Variation in laminate finish characteristic including color and texture is not considered a defect.
- All fabrics including tackboards, panels & cushions are warranted for a period of 5 years after date of delivery.
- All lighting products including bulbs, tubes, ballasts and LEDs do not carry a warranty.
- All power related products & components carry a 1 year warranty.
- All electric height adjustable components carry a 5 year warranty.
- Product & components which are not directly manufactured by Three H. In this case warranty is determined by what is offered from the manufacturer of the defective product or component.
- Product that is not sold by a Three H authorized dealer.
- Product that is not installed & maintained in accordance with Three H's guidelines & instructions.
- Product that is damaged by the end user due to misuse, accident, abuse, negligence or shipping.
- Incidental wear to product including scratches & dents occurring from everyday use.
- Product that has been altered or re-configured in any way prior to written approval by Three H.
- Product which has received excessive exposure to U.V rays, heat, water or harsh chemicals.
- Product that has been damaged due to re-installation without the assistance of an authorized Three H dealer or installer.
- Product that has been subject to conditions that exceed the BIFMA/ANSI standards applicable to that product.
- Product that is being used for rental purposes.
- Customers own material (COM) provided at the request of the user is not covered by the Three H warranty.

WARRANTY CLAIM PROCEDURE

- All warranty claims must be authorized by Three H prior to approval.
- Claims can be directed to Three H's warranty & replacement officer by contacting 1.800.767.5374 or by emailing claims@three-h.com.
- Claims must include original order number, as well as a description of return request.
- Three H reserves the right to investigate any of the above mentioned exceptions, request digital photos of the product in question, as well as proof of original ownership prior to warranty approval.

THIS WARRANTY LIABILITY IS LIMITED TO THE REPLACEMENT OF PRODUCT. THREE H WILL NOT BE HELD LIABLE FOR ANY PERSONAL OR PROPERTY DAMAGE AS WELL AS ANY CONSEQUENTIAL OR INCIDENTAL DAMAGE. THIS WARRANTY EFFECTIVE JANUARY 2017 SUPERSEDES ALL PREVIOUS WARRANTIES OFFERED BY THREE H FURNITURE SYSTEMS LIMITED.

CARE & MAINTENANCE

- Three H laminates can be easily cleaned with warm water and mild soaps. Do not use cleansers which contain abrasives, acids or alkalis.

Cleaners such as Lysol® Brand Clean & Fresh Multi-Surface Cleaner, Lysol® Disinfectant Spray, Clorox™ Disinfecting Wipes, Clorox™ Everest, etc.* can be safely used on melamine laminates to protect against COVID 19.

* Products containing Quaternary Ammonium are recommended for melamine surfaces

* Full EPA List N available at: <https://bit.ly/2UEQOUc>

EXECUTIVE COMMITMENT

Three H is committed to becoming an increasingly more sustainable company by employing policies and practices that look to protect our natural environment, support our local economy and engage with our communities. We aim to make consistent progress towards sustainability in all facets of our operations. We respect the natural, economic and human resources that help sustain our business and strive to communicate our sustainability commitments and progress to our key stakeholders.

SUSTAINABILITY POLICY

Three H understands that becoming a more sustainable company is our corporate responsibility. We will strive to operate a business that will not compromise future generations. This policy is used as a framework and guides the Three H decision making process. It is reviewed and revised regularly to ensure that it reflects our commitment to sustainability for all facets of our business operations.

Three H has identified seven (7) environmental aspects, that, along with supporting goals, are the priorities for us as a company as we strive for a sustainable future.

1. Waste Management

- Reduce the amount of waste generated by our business operations.
- Reduce the amount of waste we send to the landfill.
- Reduce the amount of waste we leave our clients and end-users in shipping our products.

2. Energy Efficiency

- Conserve energy and improve the energy efficiency of our business operations.
- Explore ways to increase the use of renewable and clean energy sources.

3. Social Responsibility

- Support the local communities in Northern Ontario by actively participating in initiatives and providing the region with local job opportunities.
- Support local suppliers and services where possible.

4. Water Efficiency

- Reduce the amount of potable water used at our facilities.

5. Our Products

- Reduce the impacts our products have on the environment in all stages of our products' life-cycle.

6. Stakeholder + Employee Engagement

- Engage our employees and other stakeholders in our sustainability goals and objectives.
- Provide our employees with a safe and healthy place to work.

7. Legal and Other Requirements

- Meet all environmental regulations applicable to our business operations.

SPECIFICATIONS

The Hook Up Tables Collection is constructed using 5/8" thick laminate with 1/4" thick HDF sub surface, steel legs and frame.

Edge Styles & Laminate Thickness

All Hook Up tables use a 1mm PVC Edge Style.

Standard Grain Direction

Table Tops: Standard grain runs parallel to the table length.

Available Laminate & Trim Finishes

All Hook Up Table Collection is available in 20+ standard laminates and 6 textured laminates with matching 1mm PVC trim.

Now offering High Pressure Laminate (HPL) for tops only in 10 specific finishes.

Matte/Fingerprint-less laminate finishes are available upon custom request by contacting our Customer Service Team. Additional upcharges and extended lead time may apply.

Fabrics

Desk mounted Privacy Screens are available 2 specific standard finish options.

For larger quantities, COM can be requested. All COM requests, Three H requires providing a sample in advance of order to qualify suitability and reserves the right to refuse fabric for any reason. Extended lead time may apply to COM orders.

Felt

18mm Rigid Felt on Fabric Privacy Screens, available in 2 standard finishes.

9mm Rigid Felt on Wrap Around Privacy Screen is available in 1 standard finish.

Standard Paints

3 standard finish options: Black, Silver & White

Premium Paints

7 upcharge finish options: Aged Copper, Carob, Koko, Graphite, Oyster, Chestnut Brown & Steel Blue.

Wire Management

All tables with grommets include black plastic J channel wire managers that can be attached to the underside of the surface.

Power

Plug in desktop power modules can be integrated into worksurfaces or are available as undermount modules. Modules are available with USB ports.

Tables grouped together in a benching application have the option of daisy-chained plug and play power to be added to the underside of the table.

Table Tops

15.875mm (5/8") thick thermally fused laminate with 6.35mm (1/4") thick HDF sub surface. Standard 1mm PVC edgeband all sides.

Post Legs

Powder coated steel

Desk Heights

Height is measured from the bottom of fully retracted levelers to the top surface. The Clearance Height is measured from the floor to Table Frame.

30"H= 27"H Clearance

36"H= 33"H Clearance

42"H= 39"H Clearance

Glide Adjustment

1 1/4"

Grommets

Cut out in surface is 63mm (2.48") diameter. Grommet cover overall size is 76mm (3") diameter. Cover is available Black, grey or white.

Powered Grommets

Rectangle 55.6mm (2.19") x 152.4mm (6") black, silver or white

Hook Up offers 3 Standard Paint Finishes and 7 Premium Paint finishes to choose from for the Table Frame, Legs & Accessories.

The Hook Up Table Collection is available in 20+ standard laminates and 6 textured laminates with matching 1mm PVC trim. Now offering High Pressure Laminate (HPL) for tops only in 10 specific finishes. Matte/Fingerprint-less laminate finishes are available upon custom request by contacting our Customer Service Team. Additional upcharges and extended lead time may apply.

Learn more at three-h.com/hook-up

Standard Paint Colors

Black
White
Silver

Premium Paint Colors

Aged Copper
Carob
Koko
Graphite
Oyster
Chestnut Brown
Steel Blue

Fabrics

Grade 2 | Guilford of Maine

Jane 9085 Jet 4040
Jane 9085 Natural 4061

Felts

18mm Felt Privacy Screens

Grey
Marble

9mm Felt Wrap Around Privacy Screens

Grey

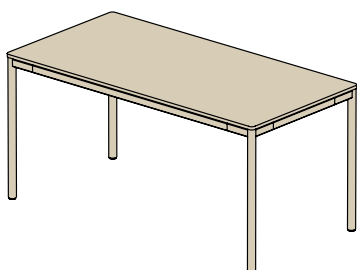
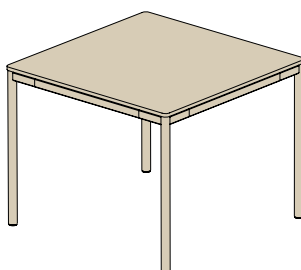
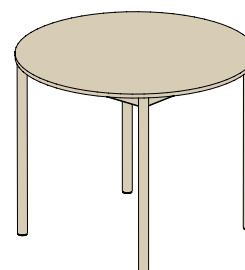
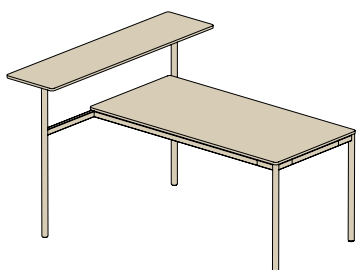
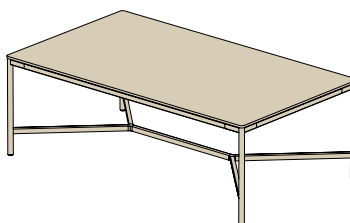
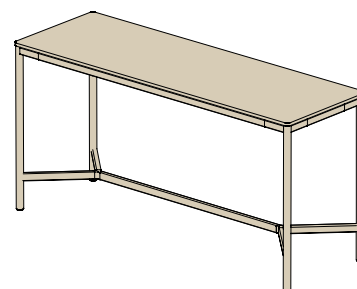
**Rectangular Table | HKDR****Lengths:** 48" · 54" · 60" · 66" · 72"**Depths:** 24" · 30"**Heights:** 29" · 36" · 42"**Grommets:** Yes**Power:** Yes**Mobile:** Yes (HKDM)**Square Table | HKTS****Lengths:** 36" · 42" · 48" · 54" · 60"**Depths:** 36" · 42" · 48" · 54" · 60"**Heights:** 29"**Grommets:** No**Power:** Yes**Mobile:** Yes (HKMS)**Round Table | HKTR****Lengths:** 36" · 42" · 48" · 54" · 60"**Depths:** 36" · 42" · 48" · 54" · 60"**Heights:** 29"**Grommets:** No**Power:** Yes**Mobile:** Yes (HKMR)**Transaction Table | HKDT****Lengths:** 48" · 60" · 72"**Depths:** 30" Main Desk /
60" Transaction Top**Heights:** 29" Main Desk /
42" Transaction Top**Grommets:** Yes**Power:** Yes**Mobile:** No**Community Table | HKTC****Lengths:** 72" · 84" · 96" · 108"**Depths:** 48" · 60"**Heights:** 29"**Grommets:** No**Power:** Yes**Mobile:** No**High Table | HKTH****Lengths:** 72" · 84" · 96" ·**Depths:** 24"**Heights:** 36" · 42"**Grommets:** No**Power:** Yes**Mobile:** No

Privacy Screens

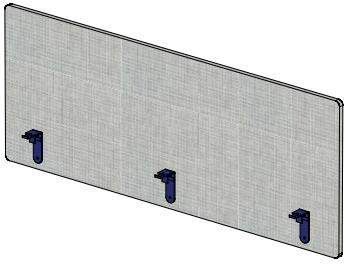
**Fabric Privacy Screen | HKPS**

Lengths: 24" - 72" (6" increments)
Depths: 3/4" screen (18mm)
Heights: 24"
Tackable: Yes
Grommets: Yes
Sided: Single · Double

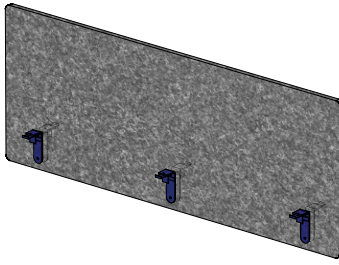
**Fabric Privacy Screen | HKPS**

Lengths: 24" - 72" (6" increments)
Depths: 3/4" screen (18mm)
Heights: 24"
Tackable: Yes
Grommets: Yes
Sided: Single · Double

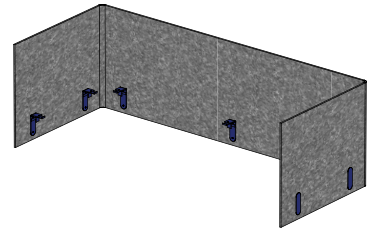
**Wrap Around Felt Privacy Screen | HKPW**

Lengths: 48" · 54" · 60" · 66" · 72"
Depths: 24" · 30"
Material Depth: 3/8" (9mm)
Tackable: Yes
Heights: 24"
Grommets: Yes
Sided: Single

Power Modules / Systems

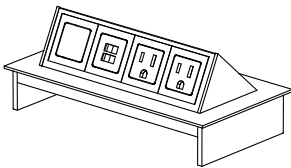
**Generic Power Modules**

Styles: 2" Round Power Inserts · 3" Round Insert · Flush Mount · Pop Up

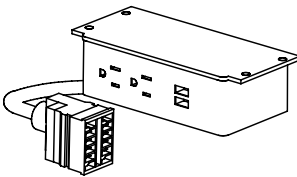
**Power Systems**

Styles: Undermount - Direct Plugin · Undermount - Perimeter System

Accessories

**18"L Planter Box | HKAL****36"L Planter Box | HKAL****Letter Tray | HKAT****Letter Box | HKAB****Coat Hook | HKAH****Cup Holder | HKAC****USB Power | HKAP****Simplex Power | HKAP**

TABLE TOP

15.875mm (5/8") thick thermally fused laminate. Standard 1mm PVC edgeband all sides.

SUB TOP

6.35mm (1/4") HDF sub surface. Standard 1mm PVC edgeband all sides to match Table Top.

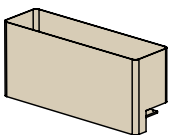
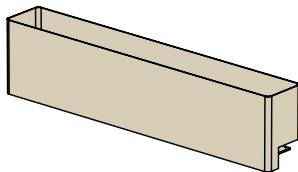
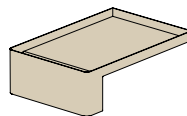
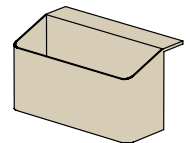
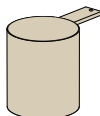
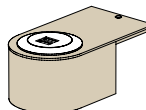
FRAME

Powder-coated steel

LEG

Powder-coated steel



Accessory¹

Powder-coated steel

L Bracket²

Powder-coated steel

Thumb Screw³

No Tools Required



The Accessory¹ will slide in between the worksurface and frame, sitting flush with the front of the frame. Align the "L" Bracket² hole to the hole on the Accessory "Tab" under the worksurface. Fasten the Thumb Screw³ through the L Bracket and Accessory with fingers only, no tools are required. The Accessory can slide along the frame into a desired position.

*All Privacy Screens are mounted using the same hardware as above.



GROMMETS / POWER

Hook Up Power Accessories

The Hook Up specific Power Accessories provide great flexibility, giving control to the user to decide where to place the power module. The module is mounted the same as other accessories; by sliding the tab between the worksurface and frame. The module is cantilevered away from the desk, keeping the worksurface clean.

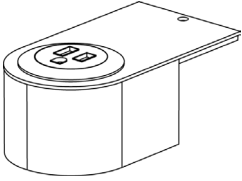

Simplex Module

- (1) 15A/120V AC Tamper Resistant Power Receptacle
- 72"L In-Feed Cord with standard 3-prong plug
- 4.6"L x 2.5"D x 1.8"H (3"L once installed)
- Housing is available in any of our Standard or Premium powder coat paint finishes.
- Simplex Module face is available in black, white or grey.

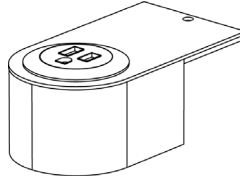

Dual USB Module

- (2) 2.1A/10.5W USB, Dual Charging Port
- 72"L In-Feed Cord with standard 3-prong plug
- 4.6"L x 2.5"D x 1.8"H (3"L once installed)
- Housing is available in any of our Standard or Premium powder coat paint finishes.
- Dual USB Module face is available in black, white or grey.

Positions

These modules can be fixed to any side of the worksurface. Each corner is home to a 6" bracket meaning ALL Modules, Accessories and Screens must be mounted 6" from the corner.

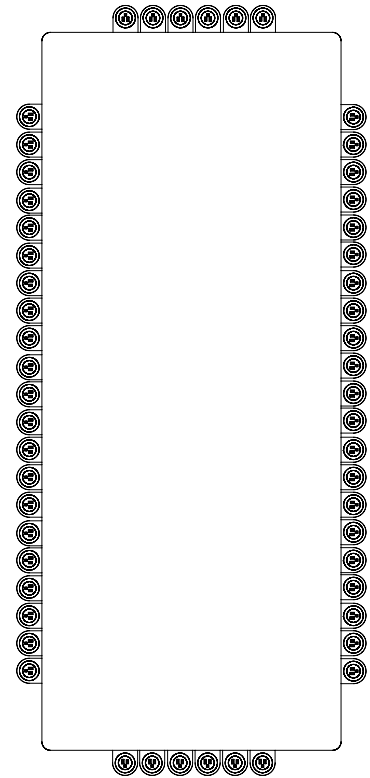
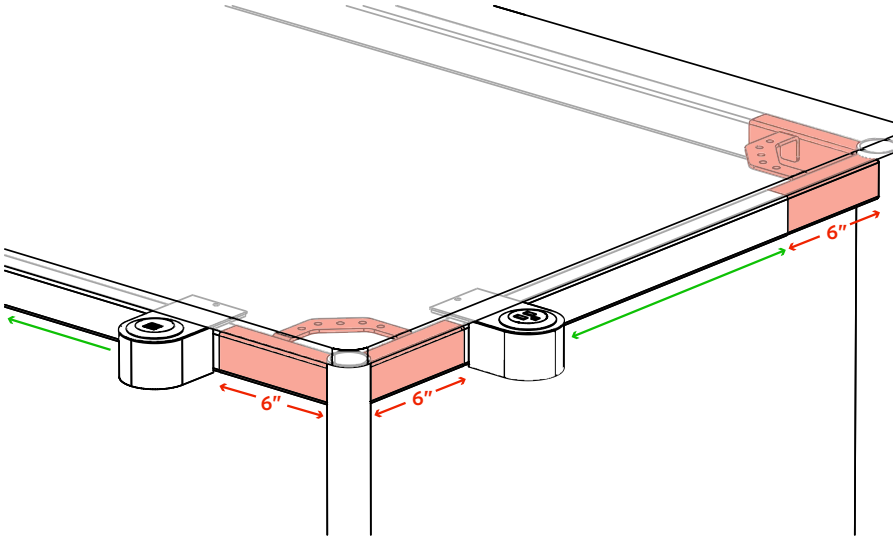

Possible positions

DESKTOP POWER

The Desktop Power modules fit into our standard round 2.48" grommet cut out. The Grommet Cover, USB Insert and Simplex Insert are available in Grey, Black or White. The Wireless Charger is black with a faux leather texture.

Round Grommet Cover

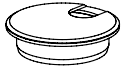

Grommet

- 2.62" Dia x 3.51"L
- Fits our 2" Grommet hole
- Available Grey, Black & White

Round Power Inserts

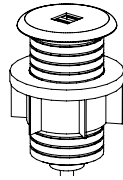

USB

- (2) 2.1A/10.5W USB, Dual Charging Port
- 72"L Standard Cord with NEMA 5-15 Straight Plug
- 2.62" Dia x 3.51"L
- Available Grey, Black & White

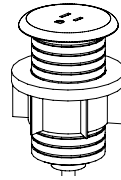

Simplex

- (1) 15A/120V AC Tamper Resistant Power Receptacle
- 72"L Standard Cord with NEMA 5-15 Straight Plug
- 2.62" Dia x 3.51"L
- Available Grey, Black & White

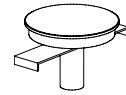

Wireless Charger

- 10-Watt Qi Fast-Charging Platform
- 1.8A/9V Input; 2A/9V Output AC Adapter
- 66-inch AC Adapter Included
- Black faux leather texture

TABLE TOP POWER

Table Top Power modules require specific cut outs in the surface and the specific location should be provided at the order stage. All Table Top modules are available in Grey, Black or White.

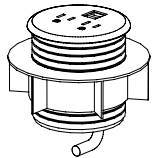

3" Round Insert - Simplex & USB

- (2) 2.1A/10.5W USB, Dual Charging Port
- (2) 15A/120V AC Tamper Resistant Power Receptacle
- 72"L Standard Cord with NEMA 5-15 Straight Plug
- 3.33" Dia x 3.51"L

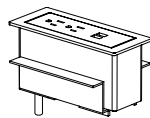

Flush Mount

- (2) 15A/120V AC Tamper Resistant Power Receptacle
- (2) 2.1A/10.5W USB, Dual Charging Port
- 6.52"L x 2.80"W

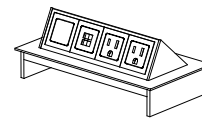

Pop Up Power

- (2) 2.1A/10.5W USB, Dual Charging Port
- (2) 15A/120V AC Tamper Resistant Power Receptacle
- (1) Blank module
- 72"L Standard Cord with NEMA 5-15 Straight Plug

POWER SYSTEMS

Power Systems provide options to allow for connectivity under the surface. In a direct plugin option or with our Perimeter Power system.

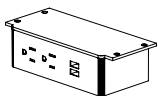

Undermount - Direct Plugin

- (2) 2.1A/10.5W USB, Dual Charging Port
- (2) 15A/120V AC Tamper Resistant Power Receptacle
- 72"L Standard Cord with NEMA 5-15 Straight Plug
- Available Black & White

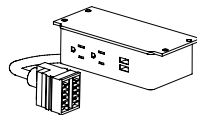

Undermount - Perimeter Power

- (2) 2.1A/10.5W USB, Dual Charging Port
- (2) 15A/120V AC Tamper Resistant Power Receptacle
- Duo Plug Adapter to daisy-chain desks together
- Available in Black & White

Hook Up Perimeter Power

Hook Up power utilizes the simple plug & play capabilities provided by a Perimeter System. Our Round Power Modules include a 72"L, 3 prong power feed. All other Power Modules include a 120"L, 3 prong power feed.

The power feeds will be plugged directly into a power source (A) or into an Undersurface Mounted Power Module called Duo* (B). The Duo is connected to a 120"L infeed.

*Available as a Trio, 3 power modules can be plugged into 1 Trio.

The Duo creates the possibility of daisy-chaining power together (C) between multiple tables using Jumpers. Jumpers can be passed through modesty Grommet holes. (D)

There is one infeed for tables that are ganged together (E). Community Tables have an optional Trough (F) to feed wires through. Community Tables can use an Undersurface Mount with an infeed. 2 power modules can be plugged into 1 Duo (G).

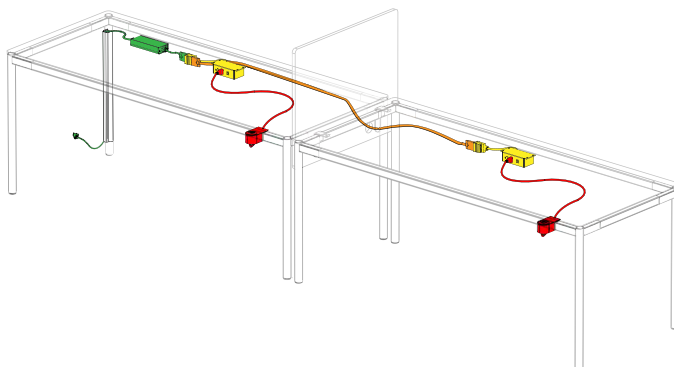

D. Jumper between daisy-chained Power Modules

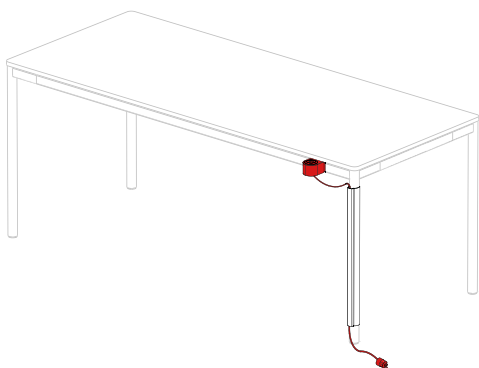

A. Power Module ready to be plugged into Power Source

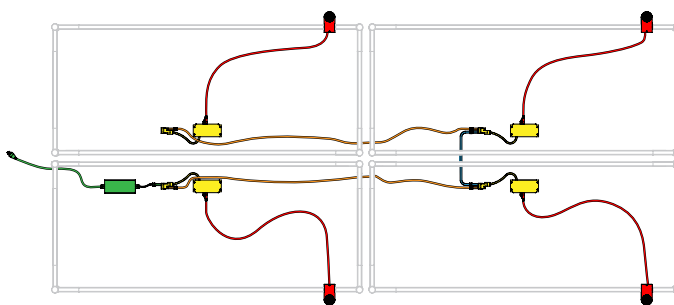

E. XRay overview of the Hook Up Perimeter Power System on a 4 pod

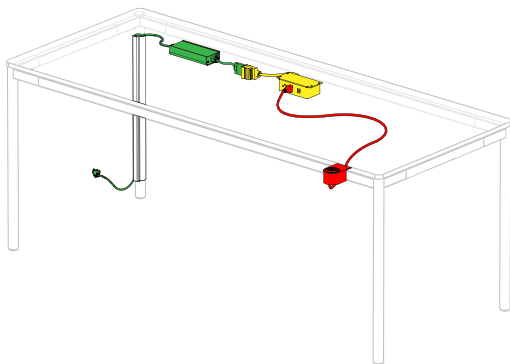

B. Power Module plugged into an Undersurface Power "Duo"

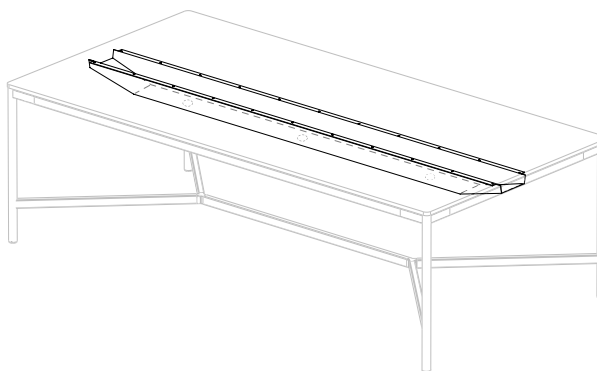

F. Community Table Wire Trough

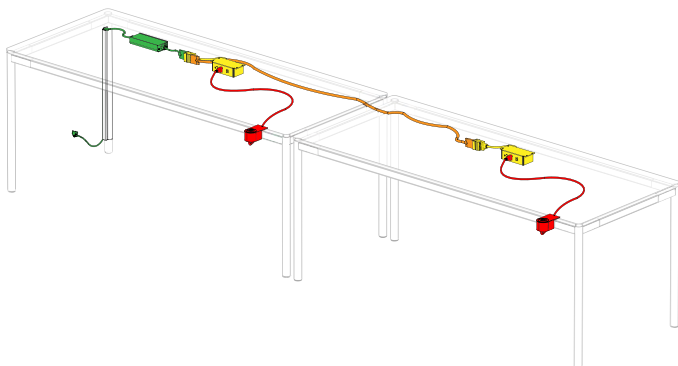

C. Daisy-chained Power between 2 Tables

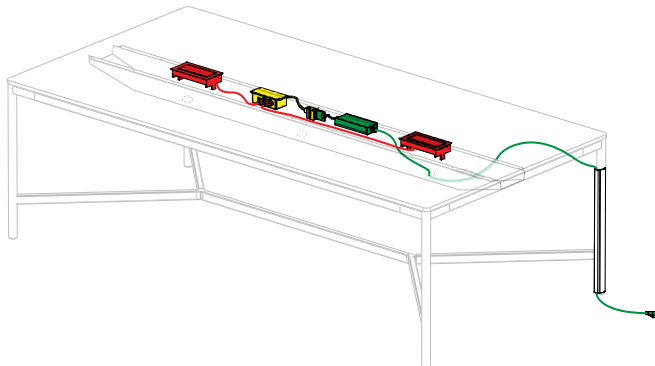

G. Community Table XRay Power Overview



Typicals

(USD prices)

484361

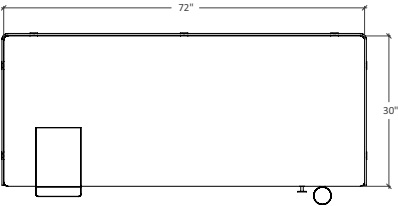
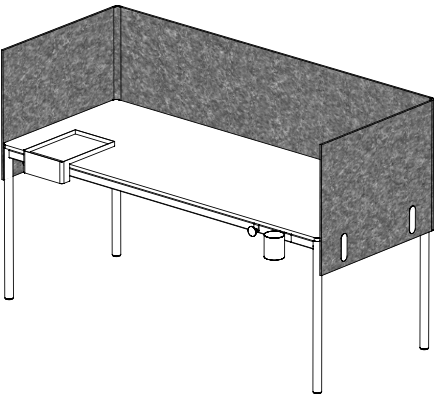

ITEM	L x D x H
Product / Qty. / SKU	(inches)
Rectangular Desk x1 HKDR723029-W021	72 x 30 x 29
Wrap Around Felt Privacy Screen x1 HKPW723024F-W01	72 x 30 x 24
Accessories Paper Tray x1 HKAT0913-1	09 x 13 x 04
Accessories Coat Hook x1 HKAHC-1	04 x 2 x 1.75
Accessories Cup Holder x1 HKAC0304-1	3.5 x 5.5 x 4

USD TOTAL LIST: \$5,235

484362

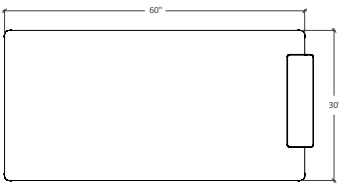
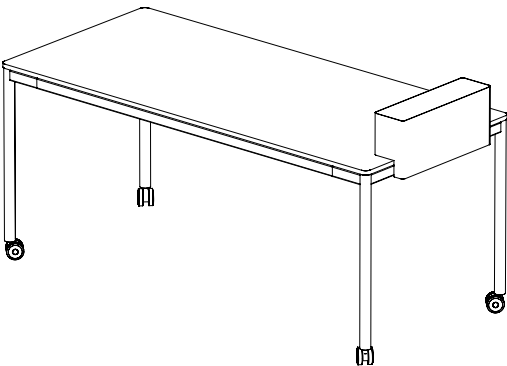

ITEM	L x D x H
Product / Qty. / SKU	(inches)
Mobile Rectangular Desk x1 HKDM603029-W021	60 x 30 x 29
Accessories Planter Box x1 PSDR4224LF-W0SO22	18 x 05 x 08

USD TOTAL LIST: \$3,465

484363

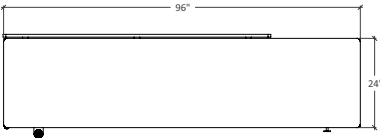
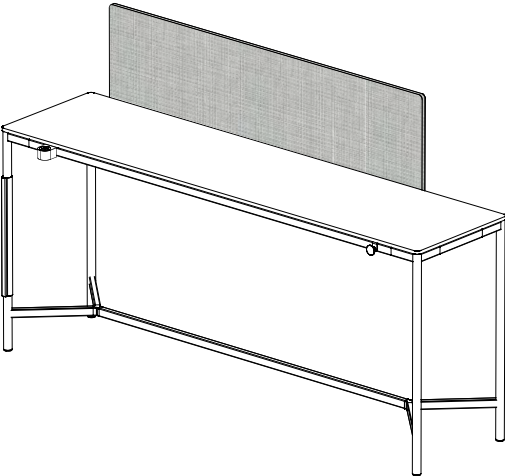

ITEM	L x D x H
Product / Qty. / SKU	(inches)
High Table x1 HKTH0962442-0021	96 x 24 x 42
Single Sided Fabric Privacy Screen x1 HKPS7224S-W011	72 x 01 x 24
Accessories Simplex Power Module x1 HKAP0202PB-1	2.5 x 02 x 02
Accessories Coat Hook x1 HKAHC-1	1.75 x 3 x 2
Accessories Wire Manager x1 HKAW22-B	22"H

USD TOTAL LIST: \$6,680

484364

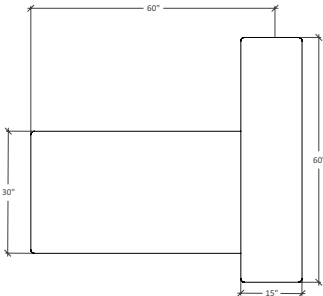
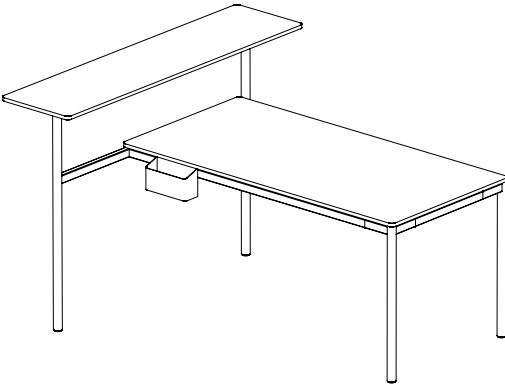

ITEM	L x D x H
Product / Qty. / SKU	(inches)
Transaction Table 42"H Transaction x1 HKDT603029L-W021	60 x 60 x 29
Accessories Letter Box x1 HKAB0905-1	09 x 05 x 05

USD TOTAL LIST: \$3,735

484365

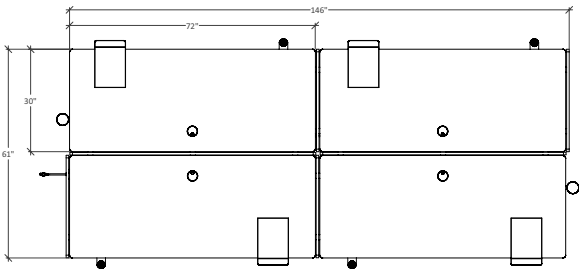
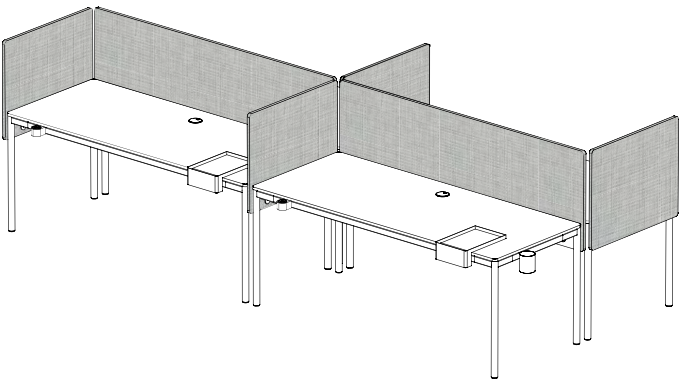

ITEM Product / Qty. / SKU	L x D x H (inches)
Rectangular Desk with Centered Grommet x4 HKDR723029-W321	72 x 30 x 29
Double Sided Fabric Privacy Screen x2 HKPS7224D-W011	72 x 1 x 24
Doubled Sided Fabric Privacy Screen x2 HKPS3024D-W011	30 x 1 x 24
Single Sided Fabric Privacy Screen x2 HKPS3024S-W011	30 x 1 x 24
Accessories Paper Tray x4 HKAT0913-1	9 x 13 x 4
Accessories Simplex Power Module x4 HKAP0202PB-1	2.5 x 2 x 2
Perimeter Power Systems Undermount Duo Module x4 HKAP0202PB-1	6.5 x 3 x 2
Perimeter Power Systems In Feed Power x1 GEPI12001	120"L
Perimeter Power Systems Jumpers x3 GEPW07201	72"L

USD TOTAL LIST: **\$24,110**

484366

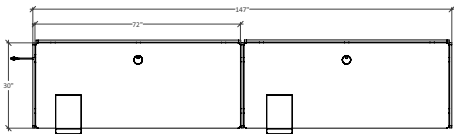
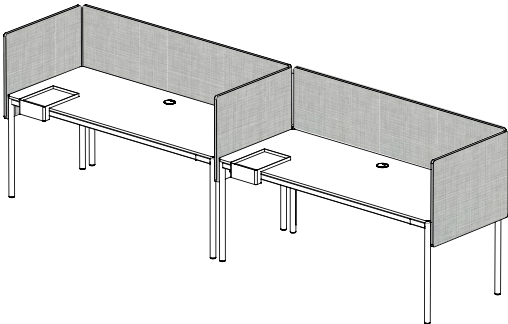

ITEM Product / Qty. / SKU	L x D x H (inches)
Rectangular Desk with Centered Grommet x2 HKDR723029-W321	72 x 30 x 29
Double Sided Privacy Screen HKPS3024D-W011	30 x 01 x 24
Single Sided Privacy Screen x2 HKPS3024S-W011	30 x 01 x 24
Single Sided Privacy Screen x2 HKPS7224S-W011	72 x 01 x 24
Accessories Paper Tray x2 HKAT0913-1	09 x 13 x 04
Perimeter Power Systems Undermount Duo Module x2 HKAP0202PB-1	6.5 x 3 x 2
Perimeter Power Systems In Feed Power x1 GEPI12001	120"L
Perimeter Power Systems Jumpers x1 GEPW07201	72"L

USD TOTAL LIST: **\$13,480**

Three H Furniture Systems Limited

156462 Clover Valley Rd.

New Liskeard, ON

Canada POJ 1P0

T. 1.800.767.5374

F. 1.888.484.5786

customer.service@three-h.com

www.three-h.com

Prices subject to change without notice

Revision 1 | February 1, 2022

© 2022 Three H Furniture Systems Limited. All rights reserved.