

2021
October

Workshelf™

SPECIFICATION GUIDE

three h

WORK-SHELF™

Specification Guide

Workshelf is a desking system that spans the open plan and private office with the clean lines of benching and the privacy and storage options of a panel system.

The design team extended the notion of working with a primary power-beam by building creative storage and open access components within additional shelving above the core beam. The stacking and layering of Workshelf individual and shared storage modules within the two-inch shelves is a signature element of the product line.

The cantilever and open asymmetrical shelves offer freedom to place items and objects in an orderly but creative fashion. Workshelf storage includes: cabinetry with lock options is a personal spot to secure laptops, phones, tablets etc.; storage cabinets can be arranged in a shared fashion with the option of four new colorful acrylic fascia; book and binder slots offer arms reach flexibility; paper trays are a nod to the in-out baskets of traditional offices and smoked acrylic privacy dividers offer a handsome design touch.

Each feature has been developed within a set of standardized components making it easy to specify. The ability to arrange them in various and shared configurations make it highly personalized and uniquely functional for a variety of work tasks. The result is an architecturally engaging workplace that adapts to the ever-evolving needs of individuals.

Powershell™ became the object of new thinking and innovation. The proprietary design is discreet, elegantly simple and directed to multiple and expected locations. The functionality is impressive, with power access for the user directly into the sides or top of Powershell and extending out to the worksurfaces as well.

The solid wood leg is built on the Three H tradition of hand crafted solid wood detailing. The angular steel support structure is multi-functional for desking and tables and was also styled to compliment the progressive aesthetics of the furniture. Together with the knife edge organic shaped tops, Workshelf is that rareness in design and quality that is immediately recognizable.

3	General Furniture Specifications
4	3H Limited Lifetime Warranty
5	3H Terms and Conditions
6	Finish Guide
7-11	STATEMENT OF LINE <hr/>
12-34	SPECIFICATION GUIDE <hr/>
13-16	Powershelf Specs
17	Return Specs
18-19	Worksurface Specs
20	Worksurface/ Table Leg Stains
21	Under Powershelf Storage Specs
22	Mobile Storage Specs
23-27	Storage Stackers Specs
28	Accessory Shelf Specs
29	Accessory Divides Specs
30	Low Storage Single Bay Specs
31	Low Storage Double Bay Specs
32	Wardrobe Specs
33	Tall Storage Quick Specs
34-55	WORKSHELF TYPICALS <hr/>

General Furniture Specifications

Workshelf is constructed of thermofused melamine laminated on an industry standard particleboard core. All laminate material is finished with a decorative face on both sides and is available in over 36 woodgrain, solid and composite colors & 5 HPL accent colors.

Worksurface tops are 1" thick, and are available with a 1mm PVC and knife edge, finished to match or complement the selected laminate finish.

Powershell and Powershell Returns are 2" thick gables and 1" thick tops. Laminate construction with integrated rail for adjustable Surface Storage Box connection. Modesty panels, where specified, are 5/8" laminate. All edges finished with 1mm PVC trim.

Platform Shelf is 2" thick laminate construction with integrated top and/or bottom rail for adjustable Surface Storage Box connection. Available as middle or top stackers. All edges finished with 1mm PVC trim.

Surface Storage Boxes are constructed of 5/8" laminate and finished with 1mm PVC edge.

Pedestals and other storage cabinet shells are constructed of 5/8" laminate. Cabinet base and shelves are 1" laminate. All edges trimmed with 1mm PVC. Box drawers, file drawers and lateral file drawers all utilize full extension slides.

File drawer inside depth=15.75"

Box drawer inside depth=15.75"

Scratch resistant acrylic is an available option on door fronts.

Nominal dimensions represent actual outside dimensions.

Aluminum Components

Powershell, Return and Accessory Shelf aluminum connecting rails have a clear anodized finish.

Worksurface underframe is available White or Grey powder coated steel.

Wood Components

Worksurface legs are solid European beech hardwood. Available in 14 stained finishes or 3 paint colors.

Standard Grain Direction

Worksurfaces: Grain runs parallel to the desk length

Upright Leg: Vertical grain

Door fronts: Vertical grain or high gloss acrylic

Drawer fronts: Option for horizontal or *vertical grain

*matched between multiple drawers on same cabinet

Power

1. Four duplex (2 facing out & 2 facing in) power access + 1x data per Workshelf side.

2. Two duplex 'Snap In' (facing out) receptacles with 6' cord and standard 110V plug and surge arrest power bar with 8 outlets + 6' cord.

8 wire four circuit systems are the standard power modules utilized. Desktop power modules are available for use on worksurfaces and Powershell.

Glide / Leveler Adjustment

Powershell: 2" adjustment

Worksurfaces: 3/4" adjustment

Credenzas and pedestals: 3/4" adjustment

(Longer stem glides available. Order separately.)

Available Fabrics

Select stock fabrics, in varying grades, available from Maharam, Guilford of Maine and Momentum.

(some limitations and additional lead time may apply)

Standard Pulls

Workshelf Pull: Solid extruded aluminum profile available in White, Grey or Orange powder coated paint.

SCS Indoor Air Quality Certified®

Workshelf™ components meet LEED requirements for Low Emitting Materials – Systems Furniture and Seating.

Three H Furniture Systems Limited ('Three H') provides a limited lifetime warranty on all products sold to the original purchaser by a Three H authorized dealer. Three H warrants that its product will remain functional¹ for as long as the original purchaser owns the product. The obligation of Three H under this warranty is to repair or replace with a comparable product or component determined to be defective by Three H at no cost to the original purchaser, FOB purchaser's destination.

¹ Remain Functional refers to the products ability to fulfill its original purpose or function.

Updated November 2018

EXCEPTIONS TO THIS WARRANTY MAY INCLUDE:

- Three H provides a full warranty on our bullnose, wavecrest and prestige wood trim and finish for a period of 3 years after date of delivery. After 3 years, the warranty applies to the wood edge only. General wear and fading of the finish after a 3 year period is not considered a defect.
- Three H provides a full warranty on our Workshelf wood legs and finish for a period of 3 years after date of delivery. After 3 years, the warranty applies to the leg only. General wear and fading of the finish after a 3 year period is not considered a defect.
- Variation in laminate finish characteristic including color and texture is not considered a defect.
- All fabrics including tackboards, panels & cushions are warranted for a period of 5 years after date of delivery.
- All lighting products including bulbs, tubes, ballasts and LEDs do not carry a warranty.
- All power related products & components carry a **1 year** warranty.
- All electric height adjustable components carry a **5 year** warranty.
- Product & components which are not directly manufactured by Three H. In this case warranty is determined by what is offered from the manufacturer of the defective product or component.
- Product that is not sold by a Three H authorized dealer.
- Product that is not installed & maintained in accordance with Three H's guidelines & instructions.
- Product that is damaged by the end user due to misuse, accident, abuse, negligence or shipping.
- Incidental wear to product including scratches & dents occurring from everyday use.
- Product that has been altered or re-configured in any way prior to written approval by Three H.
- Product which has received excessive exposure to U.V rays, heat, water or harsh chemicals.
- Product that has been damaged due to re-installation without the assistance of an authorized Three H dealer or installer.
- Product that has been subject to conditions that exceed the BIFMA/ANSI standards applicable to that product.
- Product that is being used for rental purposes.
- Customers own material (COM) provided at the request of the user is not covered by the Three H warranty.

WARRANTY CLAIM PROCEDURE

- All warranty claims must be authorized by Three H prior to approval.
- Claims can be directed to Three H's warranty & replacement officer by contacting 1.800.767.5374 or by emailing claims@three-h.com.
- Claims must include original order number, as well as a description of return request.
- Three H reserves the right to investigate any of the above mentioned exceptions, request digital photos of the product in question, as well as proof of original ownership prior to warranty approval.

THIS WARRANTY LIABILITY IS LIMITED TO THE REPLACEMENT OF PRODUCT. THREE H WILL NOT BE HELD LIABLE FOR ANY PERSONAL OR PROPERTY DAMAGE AS WELL AS ANY CONSEQUENTIAL OR INCIDENTAL DAMAGE. THIS WARRANTY EFFECTIVE JANUARY 2017 SUPERSEDES ALL PREVIOUS WARRANTIES OFFERED BY THREE H FURNITURE SYSTEMS LIMITED.

CARE & MAINTENANCE

- Three H laminates can be easily cleaned with warm water and mild soaps. Do not use cleansers which contain abrasives, acids or alkalis.
- Cleaners such as Lysol™ Brand Clean & Fresh Multi-Surface Cleaner, Lysol™ Disinfectant Spray, Clorox™ Disinfecting Wipes, Clorox™ Everest, etc.* can be safely used on melamine laminates to protect against COVID 19.
- *Products containing Quaternary Ammonium are recommended for melamine surfaces
- *Full EPA List N available at: <https://bit.ly/2UEQOUc>

QUOTATIONS

Three H can only provide quotations to registered dealers. Standard quotations are valid for a period of thirty (30) days unless otherwise specified. Registered project quotations are valid for a period of sixty (60) days unless otherwise specified.

PRICING

All pricing is subject to change without notice. Prices are subject to any provincial or state taxes & are confirmed at time of invoice.

ORDER SUBMISSION

An official purchase order is required for all purchases. PO's may be submitted by email to orders@three-h.com or by fax at 1-888-484-5786. The following information is required on all purchase orders:

Company name, purchase order number, delivery address & contract number, Three H quotation number(s) or project registration number (if applicable), décor selections (tops, fronts, décor, trim, fabric), total net pricing including dealer discounts and any applicable freight & tax amounts.

CONFIRMATIONS

After receiving a purchase order, Three H will provide a confirmation along with estimated ship dates. If any discrepancies exist, Three H will provide a deficiency report outlining the details. If you do not receive a confirmation within 48 hours of submission, please contact customer service for verification.

DEPOSIT REQUIREMENTS

Deposits may be required on large volume orders & can be requested by Three H at quotation stage or at time of purchase order.

ORDER CHANGES AND CANCELLATIONS

Canceled orders may be subject to re-stocking fees. Re-stocking fees are a percentage net (including full amount) depending on their status in production. All Three H is product is 'made to order' and does not come from a stocking program. Product returns must be authorized by Three H prior to being sent back. A return authorization number will be issued by our warranty/claims department upon approval. All product being returned must be packaged securely in a similar manner as it was delivered. Product returned damaged will be refused.

REPLACEMENTS

Replacement components can be requested from replacements@three-h.com or by calling 1.800.767.5374 ext. 235. Please have original Three H order number available when requesting replacements parts. Any installation and labor charges related to warranty replacements must be reviewed & approved by Three H prior to being reimbursed. Three H does not reimburse for concealed freight damages or damages that occur during installation.

WARRANTY

Three H Furniture Systems offers a limited lifetime warranty on all products. For detailed information, please review our full warranty policy.

FREIGHT INFORMATION**MINIMUM FREIGHT CHARGES**

Unless otherwise specified, freight is included to dealer dock on all orders when combined shipment values exceed \$5000 list. In certain locations, zone freight premiums may apply. Combined orders under the minimum list will have a \$150 net freight charge applied. Three H is not responsible for consolidating or holding orders in order to meet the minimum requirements. This is the responsibility of the dealer.

ALTERNATE SHIP TO LOCATIONS

If alternate ship to locations other than dealer dock is required, additional freight charges may apply. Please contact Three H Customer Service to verify prior to submitting PO.

ADDITIONAL CHARGES

Additional shipping charges may also apply for direct to site delivery, weekend delivery, storage fees, gate services, call ahead notices, excessive unload times or other custom freight requests. Please contact customer service for any freight related questions.

DAMAGED PRODUCT

All merchandise is inspected and packed prior to shipment. It is the responsibility for the dealer to inspect packaging thoroughly upon delivery for any damages prior to accepting delivery. Obvious damages or shortages should be noted on the freight bill (bill of lading) and a claim filed immediately with Three H. Concealed damage should be reported to Three H immediately upon discovery. Any claims against Three H for apparent defects, errors or shortages must be made by the purchaser, in writing, within ten (10) working days after delivery. Failure to make a claim within ten (10) days shall constitute acceptance of the goods and a waiver of any apparent defects, errors or shortages.

LAMINATES · FABRICS · PULLS · EDGES

Visit www.three-h.com/workshelf for more details on this product line and to view our broad selection of finishes.

Finishes not listed can be made available upon request.

All Specifications are subject to change without notice.



STATEMENT OF LINE

Powershell™ Power/Data

Visit three-h.com/workshelf for video animation demo of Powershell and Workshelf construction

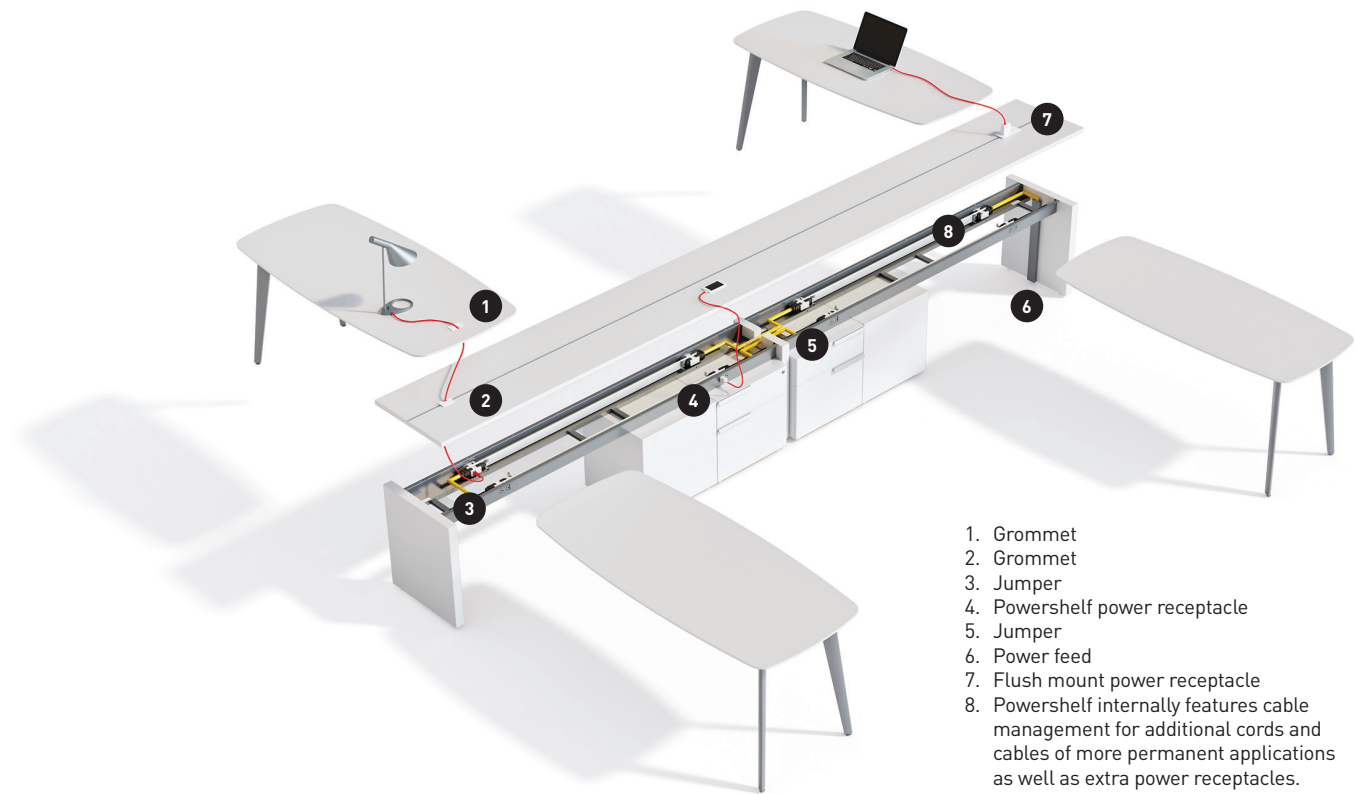

Workshelf™ Component Assembly

1. Worksurface
2. Legs
3. Support frame
4. Under powershelf storage
5. Powershelf
6. Middle stackers
7. Shelf (with top and bottom groove)
8. Middle stackers
9. Shelf (with top and bottom groove)
10. Top stacker
11. Acrylic partition



Workshelf™ Storage Options

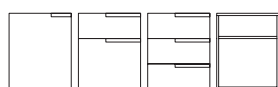

Under Powershelf Storage

Height – 21"
[fits under Powershelf]
Width – 16" (Letter), 19" (Legal),
21", 24", 30", 36"

Depth – 19"
Drawers: Left & Right pull position
for 18", 21", 24" only
Center Pull option for all widths
Doors: Small pull

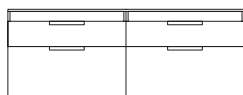

Low Storage

Height – 25.5"
[same height as Powershelf]
Width – 42", 48", 54", 60", 66", 72"

Depth – 21"
Drawers: Left & Right pull position
for 42", 48" only
Center Pull option for all widths
Doors: Small pull



Low Storage

Height – 25.5"
Width – 16" (Letter), 19" (Legal),
21", 24", 30", 36"

Depth – 21"
Drawers: Left & Right pull position
for 18", 21", 24" only
Center Pull option for all widths
Doors: Small pull

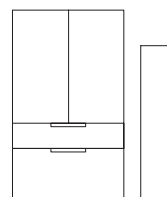

Tall Storage

Heights – 43", 57", 64", 71", 78", 85"
Widths – 18", 21", 24", 30", 36"

Depth – 15", 21"
Drawers: Left & Right pull position
for 18", 21", 24" only
Center pull option for all widths
Doors: Small pull
12" & 18" wide in single and
double sided wardrobe
Full door or open

Workshelf™ Statement of Line

Available in Top Stacker & Middle Stacker versions, unless specified otherwise.

Surface Storage Boxes

3.5 inch height / 15 inch depth

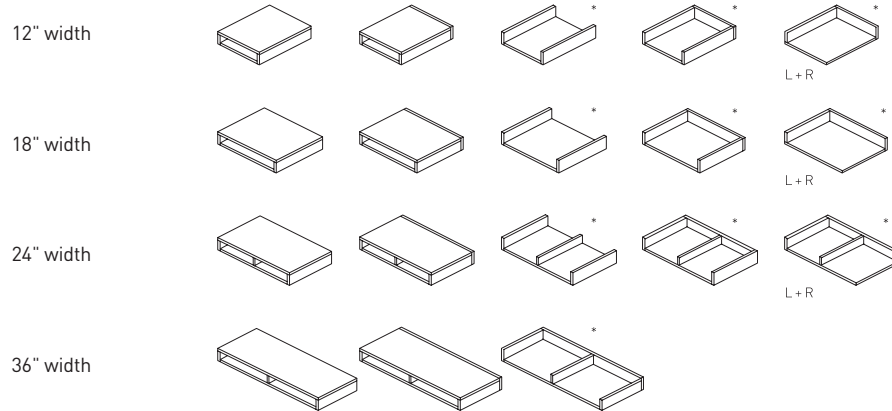

7 inch height / 15 inch depth

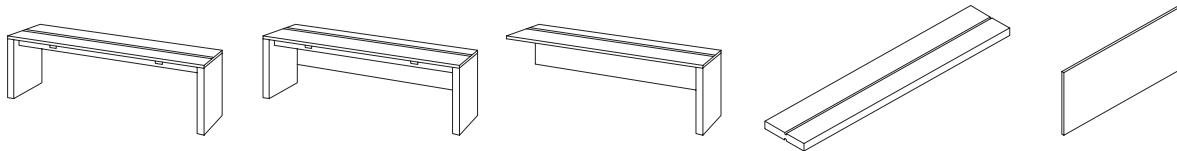
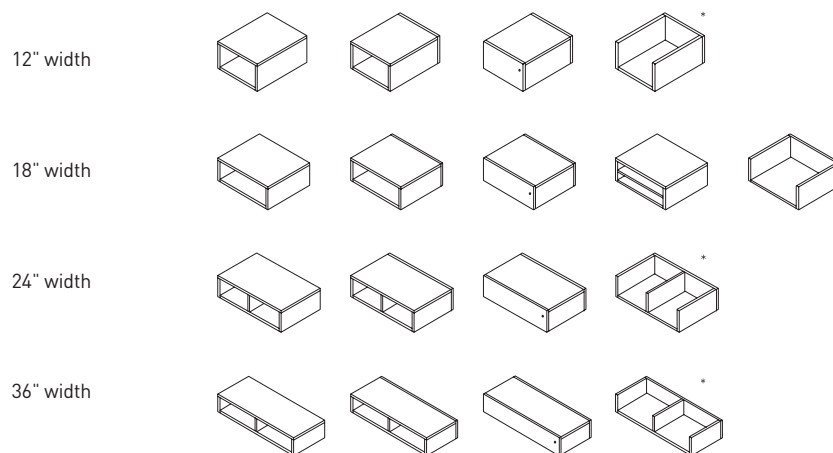

Powershelf – Double Side

Height – 25.5"
Depth – 21"
Length – 48" to 96"
With or without extrusion
Grommet or face up modules
With or without center extrusion
to receive storage centered

Powershelf – Single Side

Height – 25.5"
Depth – 21"
Length – 48" to 96"
With or without extrusion
Half or full modesty options
Grommet or face up modules
With or without center
extrusion to receive storage
flush with back edge

Return

Height – 25.5"
Depth – 21"
Length – Max 72"
Left & Right, half or
full modesty panel
Grommet or face up modules
With or without center
extrusion to receive storage
flush with back edge

Platform Shelf

Height – 2"
Depth – 15"
Width – 42, 48, 54, 60, 66, 72, 78, 84"
One or two side aluminum extrusion

Acrylic Partition

Height – 8" & 15"
Thickness – 1/4"
Width – 18, 24, 30, 36, 42, 48, 54, 60"
Finish – Clear, frosted & smoke

Workshelf™ Component Assembly

Surface Storage Boxes
10.5 inch height / 15 inch depth

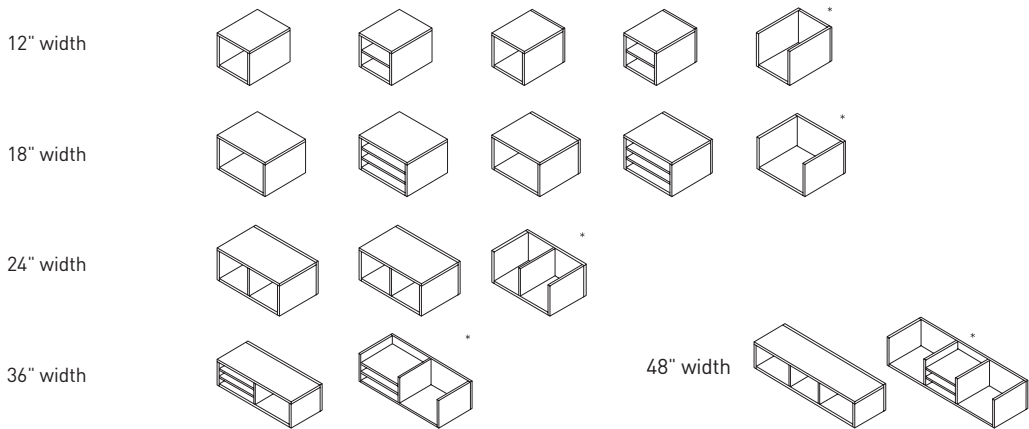

14 inch height / 15 inch depth

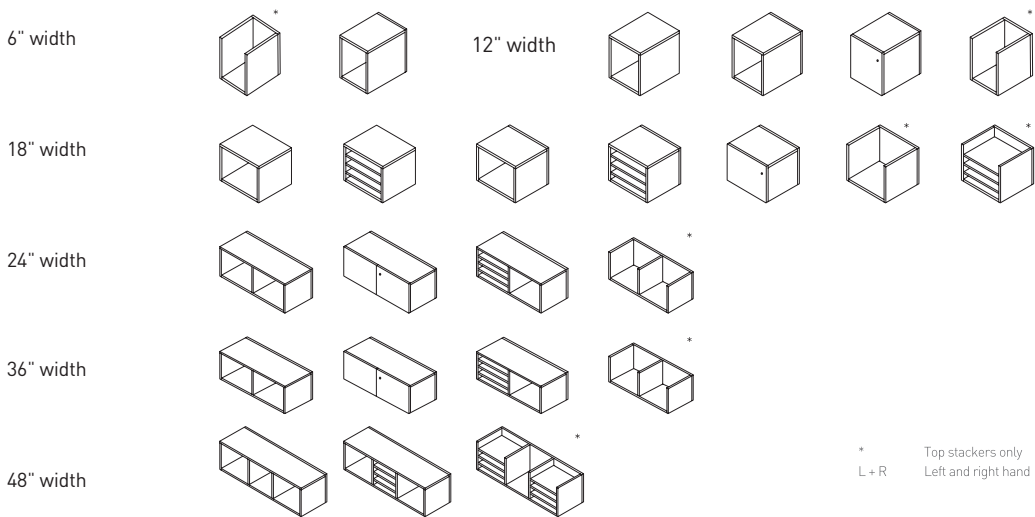

* Top stackers only
L + R Left and right hand

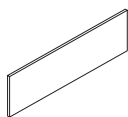

Modesty Panel

Height – 10.5"
Laminate or fabric
For freestanding
and run off tables
Laminate or accent
color available



Rectangle Worksurface

48"x 24" 66"x 30" 66"x 36"
54"x 24" 72"x 30" 72"x 36"
60"x 24" 78"x 30" 78"x 36"
66"x 24" 84"x 36"
72"x 24"



Boat Worksurface

66"x 30" 66"x 36"
72"x 30" 72"x 36"
78"x 30" 78"x 36"
84"x 36"



Tapered Worksurface

66"x 36/24" 66"x 42/30"
72"x 36/24" 72"x 42/30"
78"x 36/24" 78"x 42/30"
84"x 36/24" 84"x 42/30"



Wing Worksurface

72"x 39/24"
78"x 41/24"
84"x 42/24"



Wing Worksurface

72"x 39/24"
78"x 41/24"
84"x 42/24"



SPECIFICATION GUIDE

DOUBLE SIDED POWER

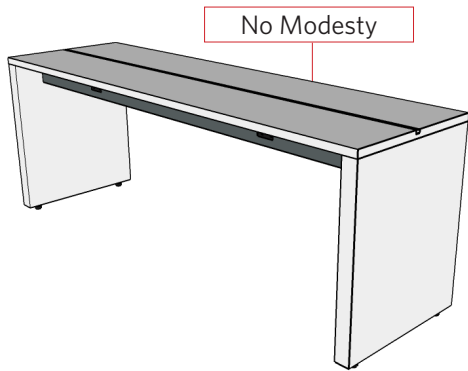

Connecting Rail is centered on Doubled Sided application. Centering the rail creates centered storage stackers with room for workspaces off both sides.

SINGLE SIDED POWER

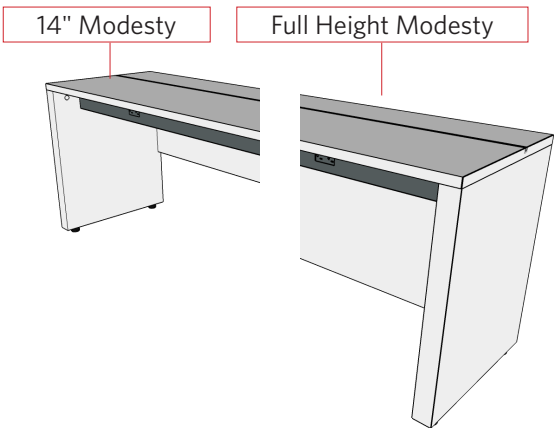

Connecting Rail is offset towards the back on Single Sided application. Offsetting the rail creates storage stackers flush to the back edge.

CONNECTING RAIL

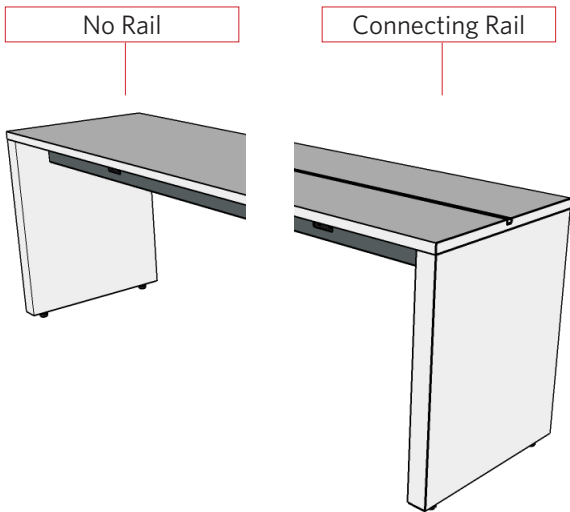

LEG OPTIONS

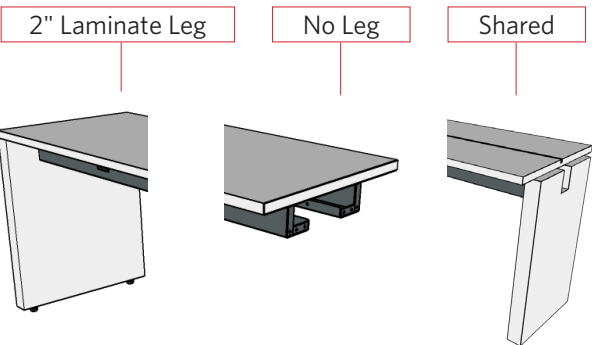

EXTENDED BEAM EXAMPLE

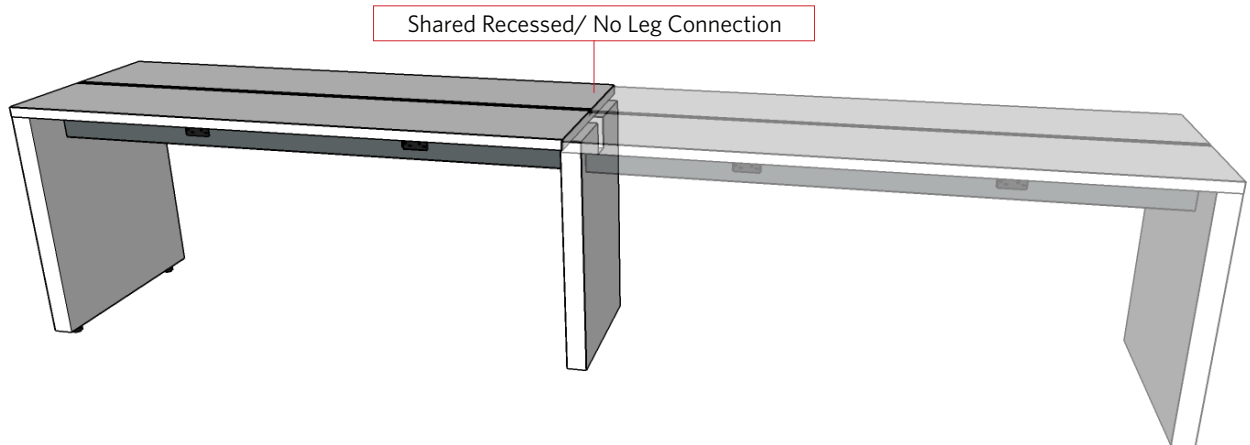

POWER/ DATA OPTIONS

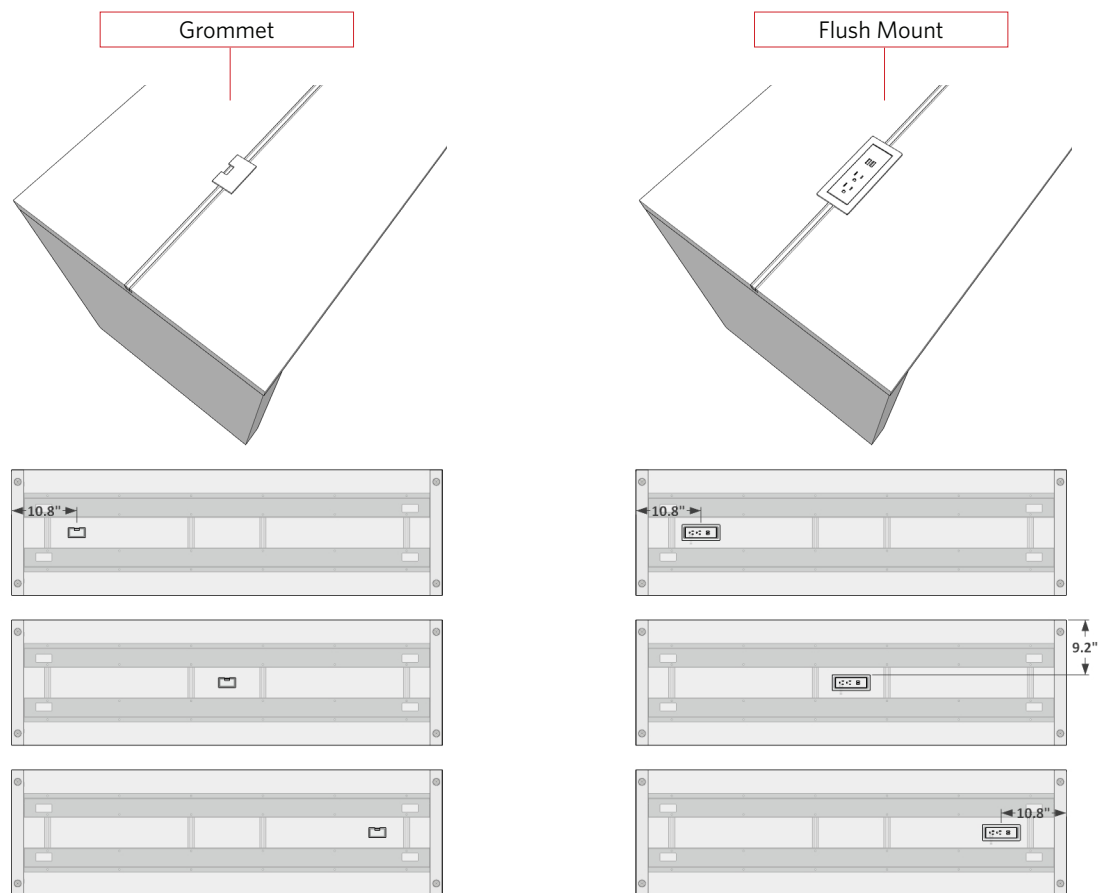

HOW POWER/ DATA WORKS INSIDE POWERSHELF

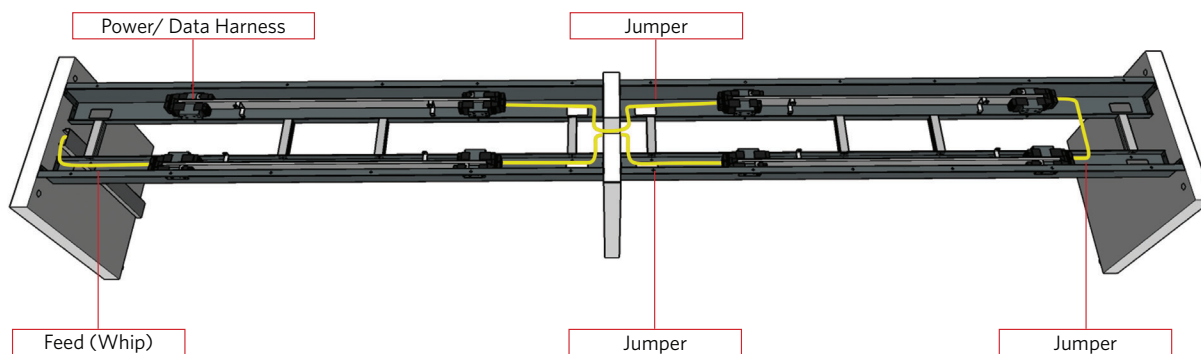

Powershelf is supported by one or two metal beams that hold the power/ data harness and cords. Outlets are exposed for easy access on the outside and more permanent power/ data outlets are located on the inside. Depending how your office is set up or where you are located different power options are available.

The feed (whip) MUST be on one of the "starter" Powershelf pieces. A Jumper is used to transfer power from one Powershelf to a "middle" or "end" Powershelf. Another Jumper is used to transfer power from one side of the Powershelf to the other if it is double sided.

Example: Ordering a standalone Powershelf requires one feed. One jumper is already included in the price.

Example 2: Ordering 2 Powershelves requires one feed and one jumper. 2 jumpers are already included on each Powershelf (see above example)

Example 3: Ordering a Single Sided standalone Powershelf requires 1 feed with one jumper already included. If ordering 2 Single Sided Powershelves to be attached; 1 jumper will be included in the 2nd Powershelf.

EASY ACCESS POWER

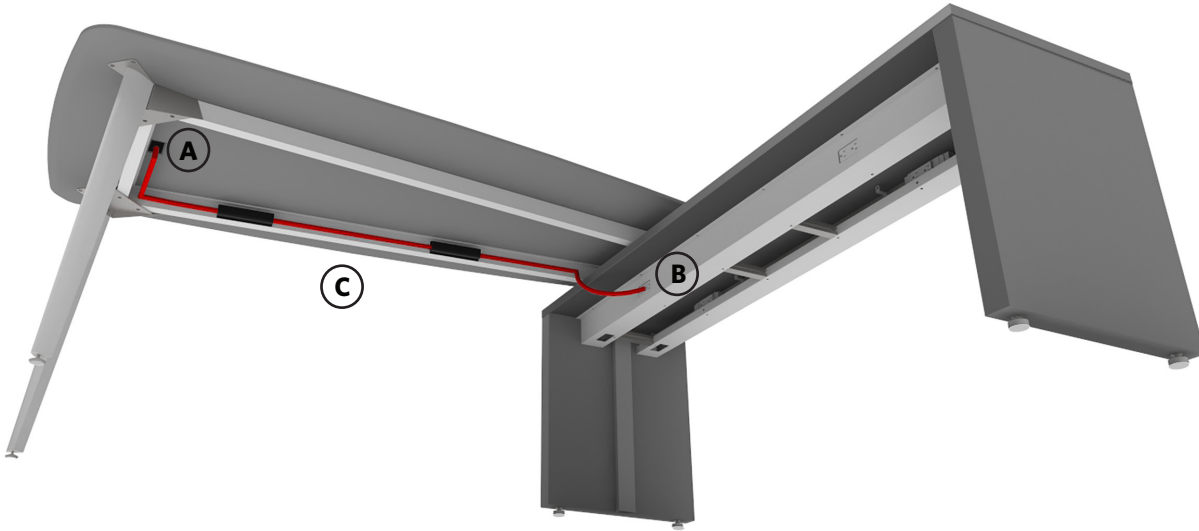

- A.** Worksurface Grommet
- B.** Easy Access Power Outlets
- C.** Self-Adhesive Wire Management Trays

The application above demonstrates how the wire management will work from Worksurface Grommet to Easy Access Power outlet. We use self-adhesive wire management trays which we use across all product lines. This helps to eliminate dangling cords even if it's a temporary power source such as a laptop.

PERMANENT POWER

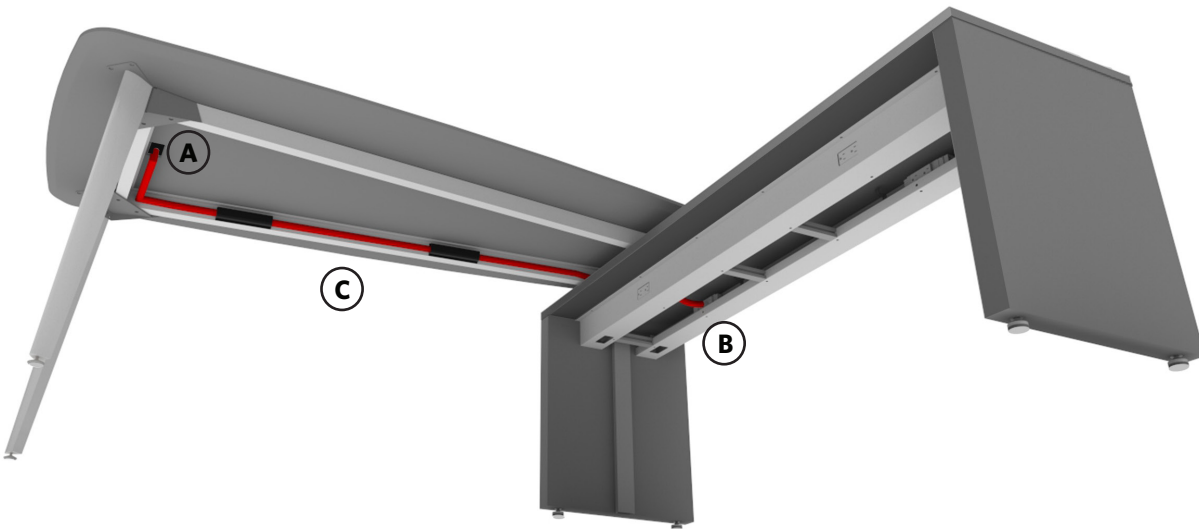

- A.** Worksurface Grommet
- B.** Permanent/ Semi-Permanent Power Outlets
- C.** Self-Adhesive Wire Management Trays

The application above demonstrates how the wire management will work from Worksurface Grommet to a more Permanent Power outlet. A Grommet is on the Powershelf for the cord to run from (A) to (B) through the top of the Powershelf Surface. This is for semi-permanent or permanent power such as a desktop computer.

PLUG & PLAY POWER OPTION

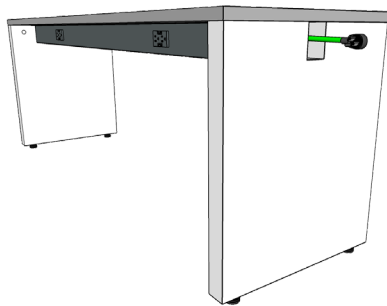
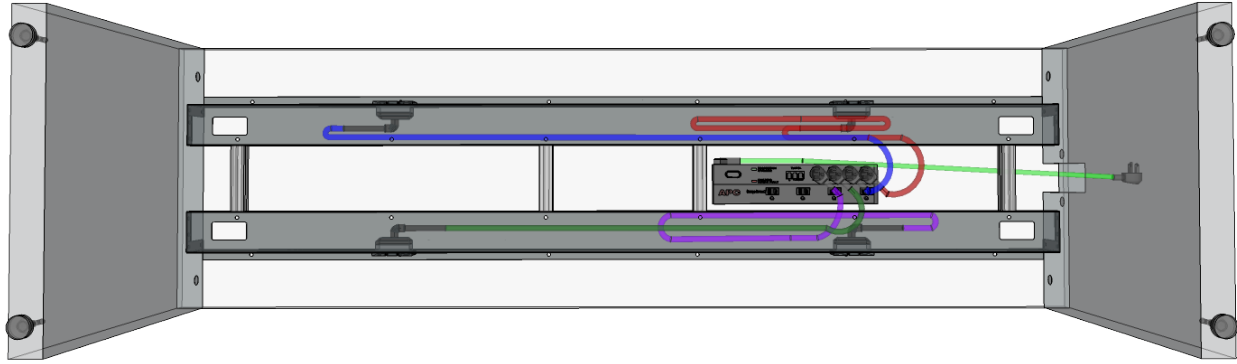

Plug & Play Power is wired differently than the regular power sources. The easy access outlets simply clip in to the beam with one wire to a power bar that is hidden/ fixed to the underside of the top.

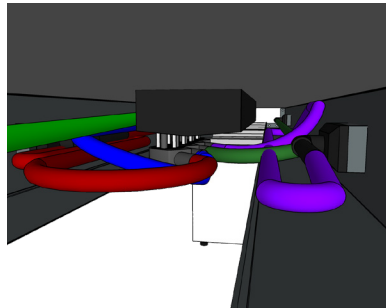

If you have a double sided Powershelf, you'll have 4 outlets and 4 connections going to the power bar. A single sided Powershelf will only have 2 outlets and 2 connections.

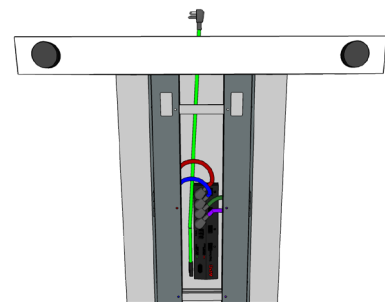

From the bottom of the table, your wires power and power source will look like this. The power bar is powered by 1 cable that will need to be plugged into an external outlet. A grommet in the leg is suggested.

WIRE MANAGEMENT

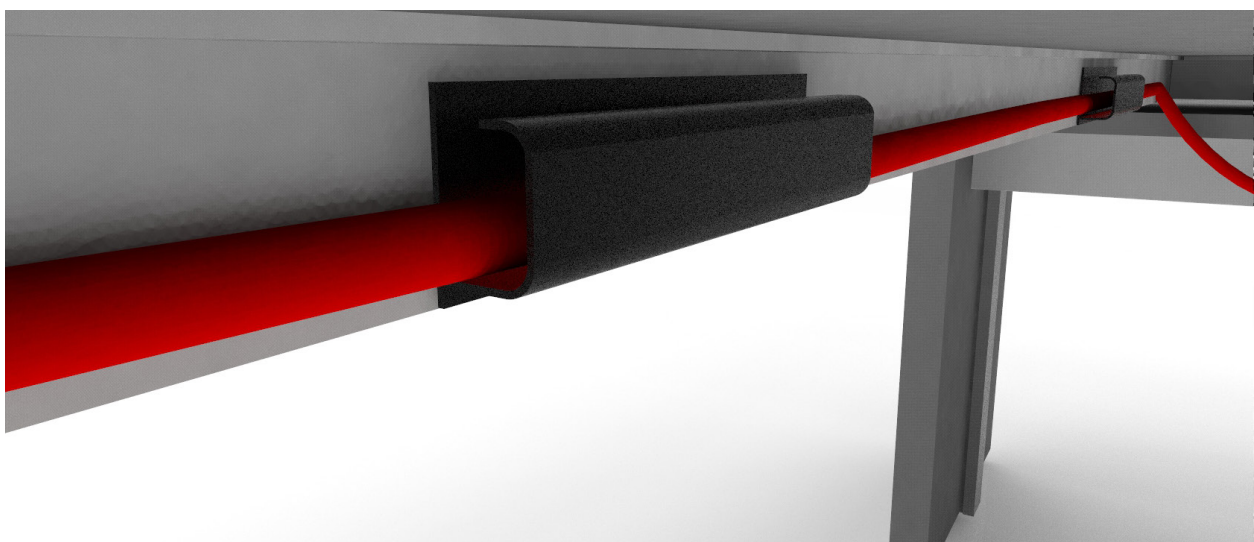

Wire Management is an important tool to having a tidy office space. We use black self-adhesive wire managers that can adhere to any surface.

MODESTY OPTIONS

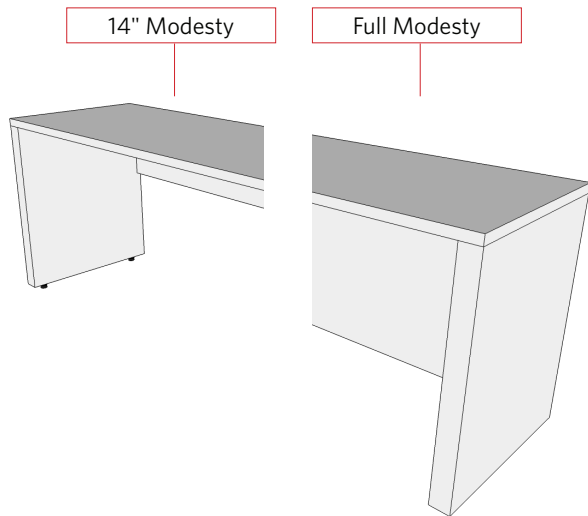

CONNECTING RAIL

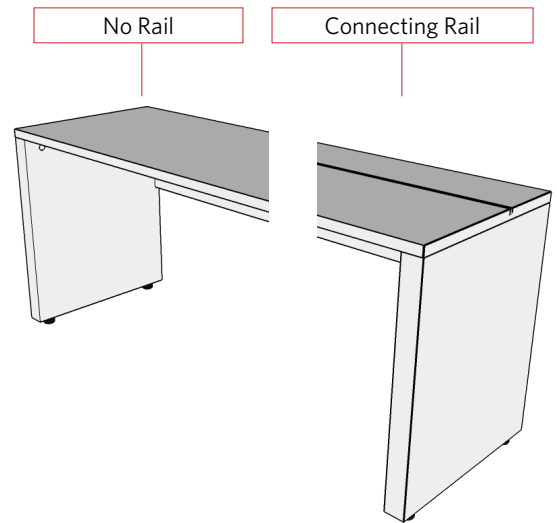

Connecting Rail is offset towards the back on returns.
Offsetting the rail creates storage stackers flush to the back edge.

LEG OPTIONS

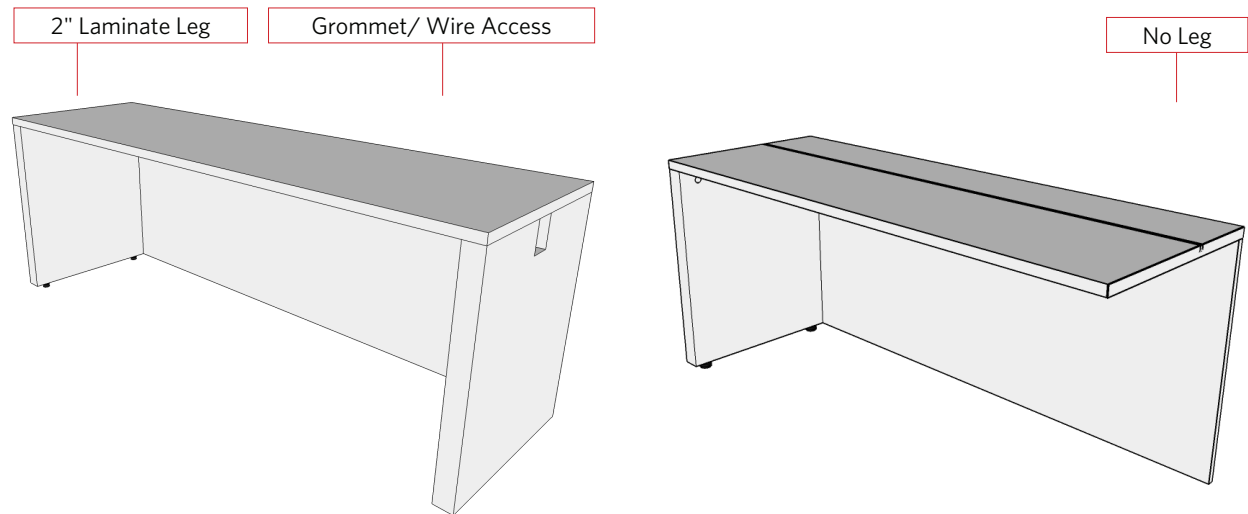

POWER OPTIONS

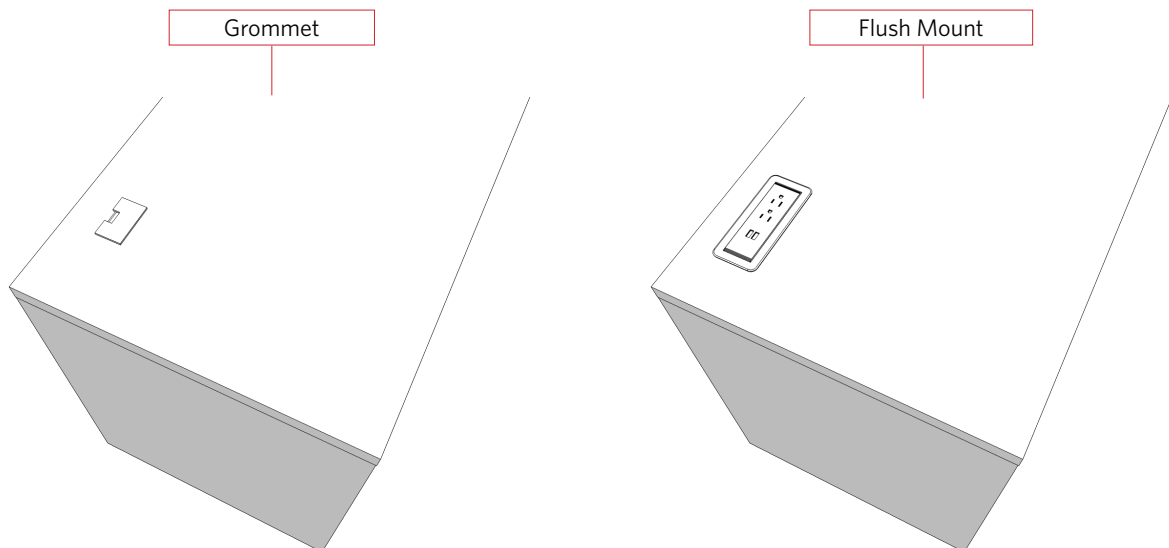

TOP STYLE

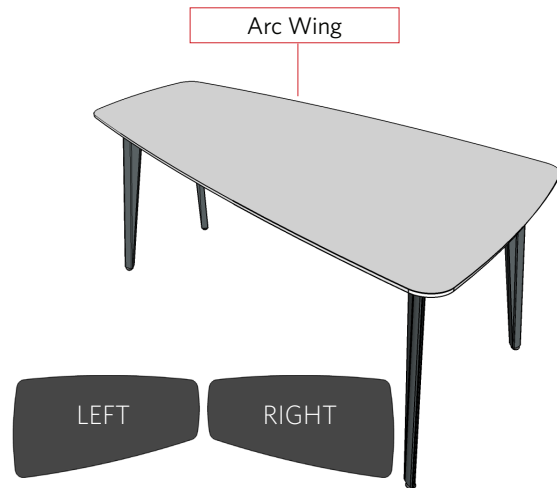
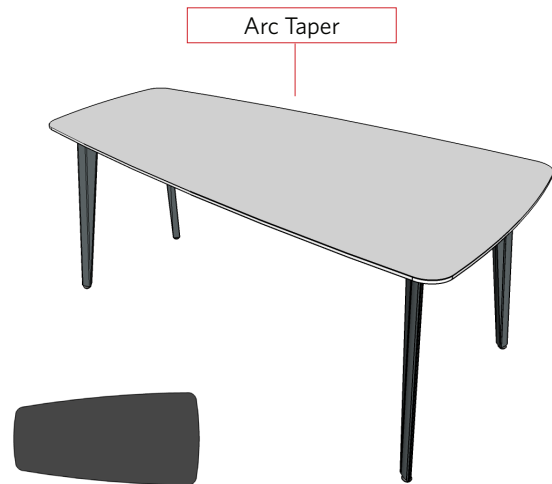
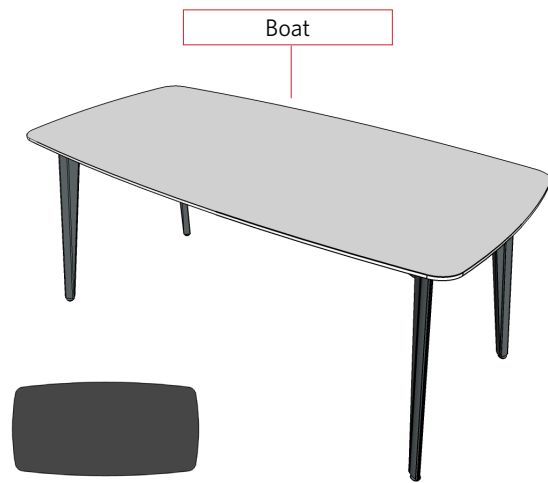
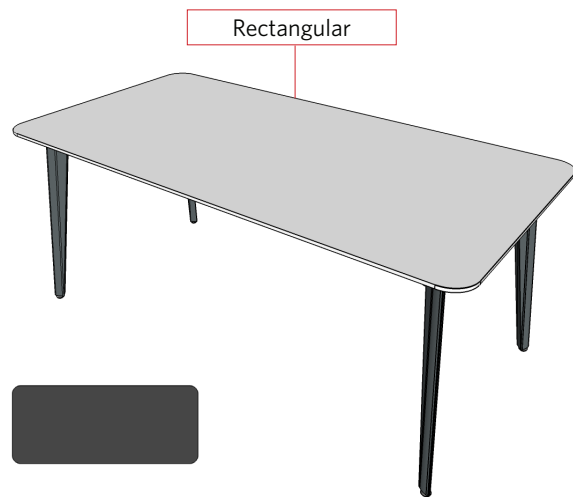

LEG STYLE

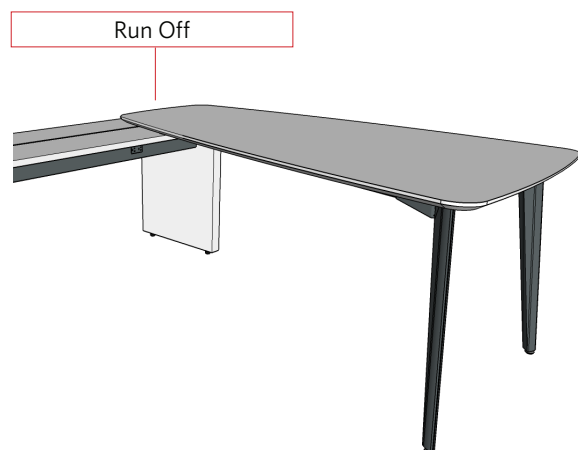

10.5" MODESTY FINISHES

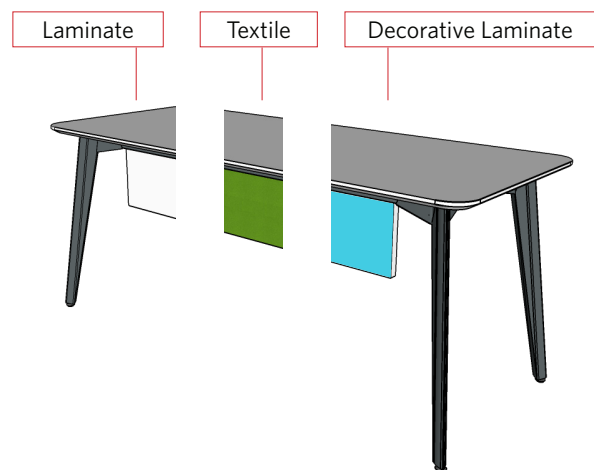

EDGE OPTIONS

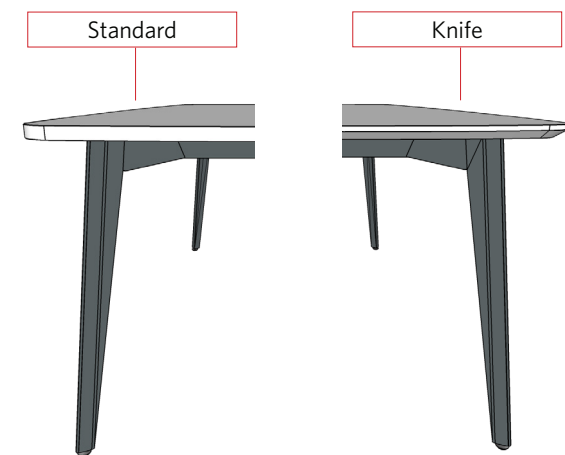

POWER OPTIONS

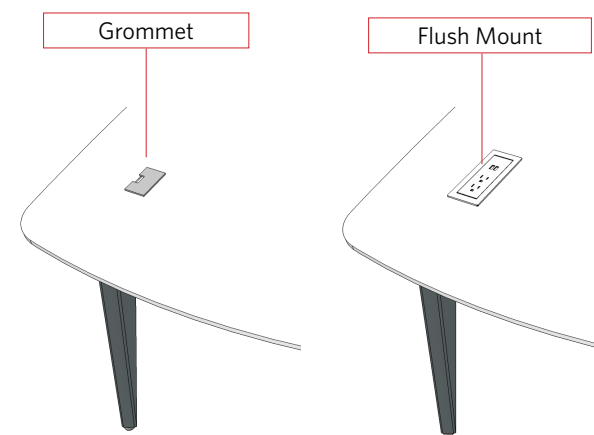

RUN-OFF BRACKET

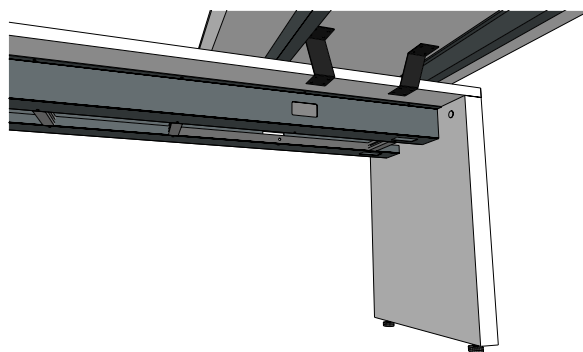

POWER POSITIONS

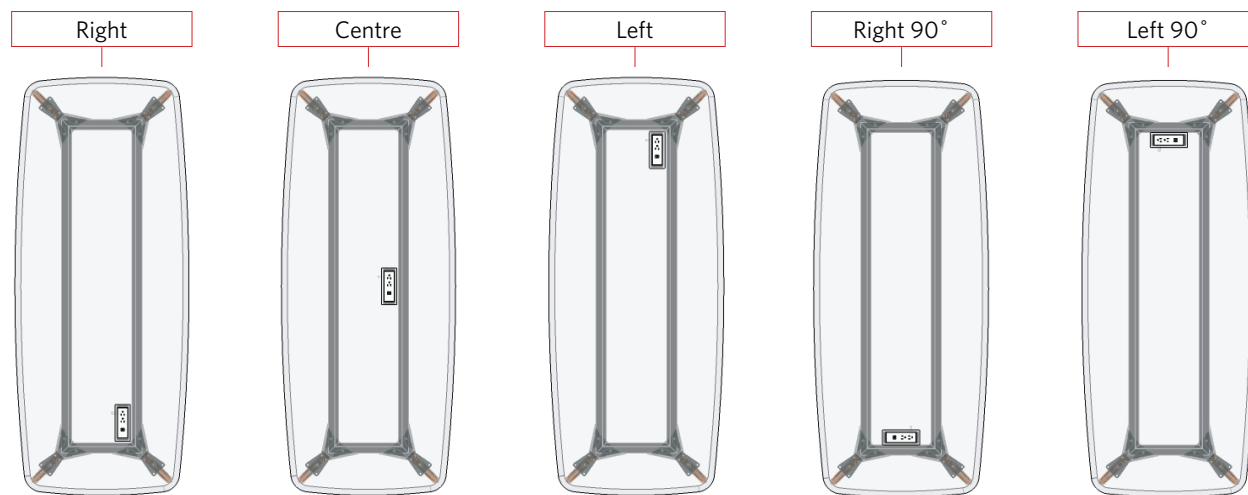



WIDTHS

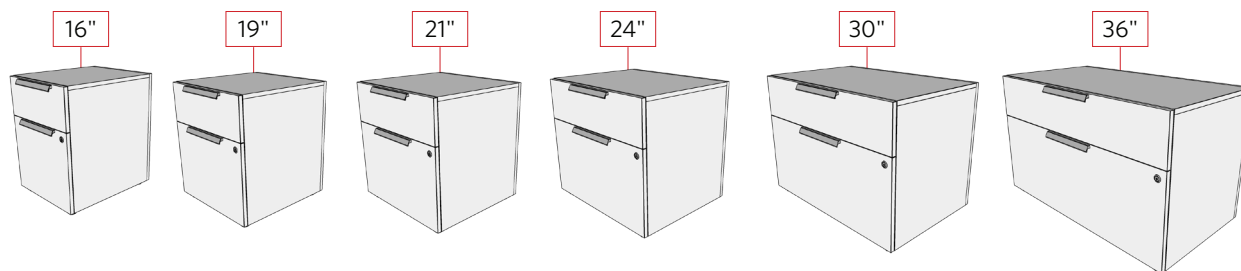

CONFIGURATIONS

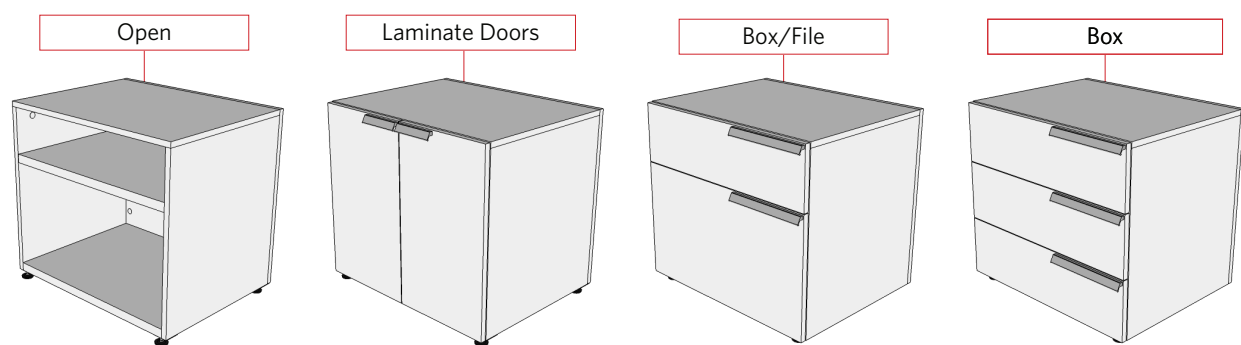

PULL POSITIONS

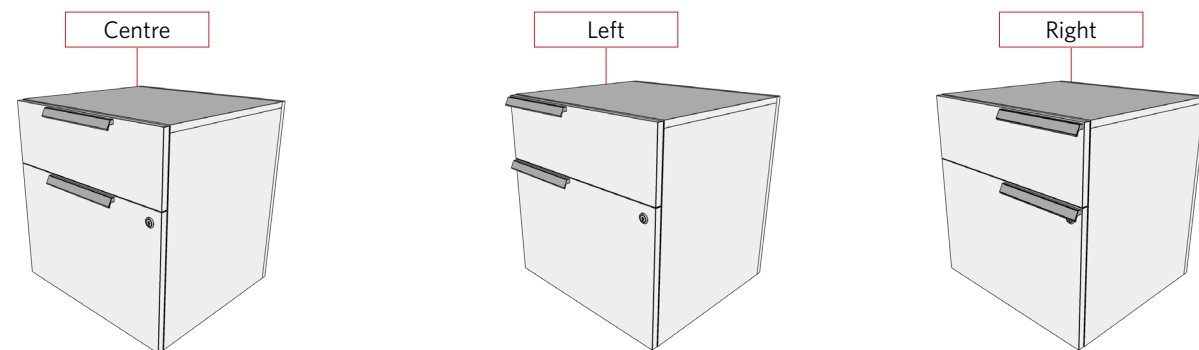

Centre pull position all widths

*Left & Right pull positions for 18", 21", 24" Widths only

WIDTHS

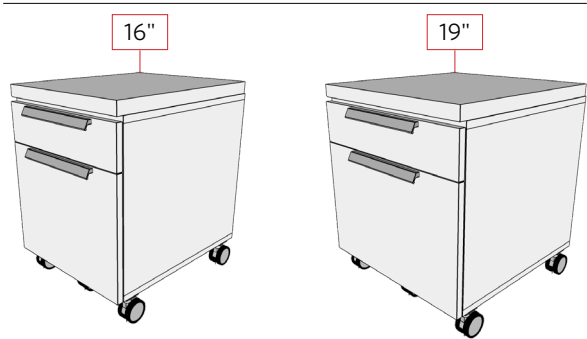

TOP OPTIONS

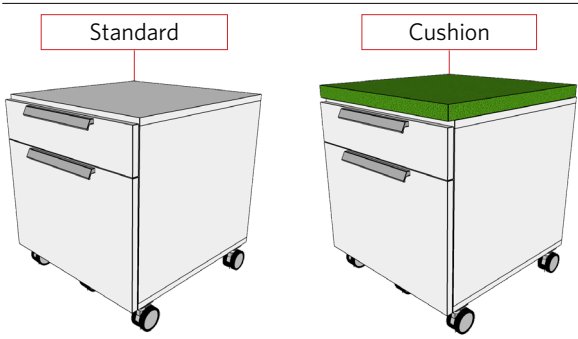

CONFIGURATIONS

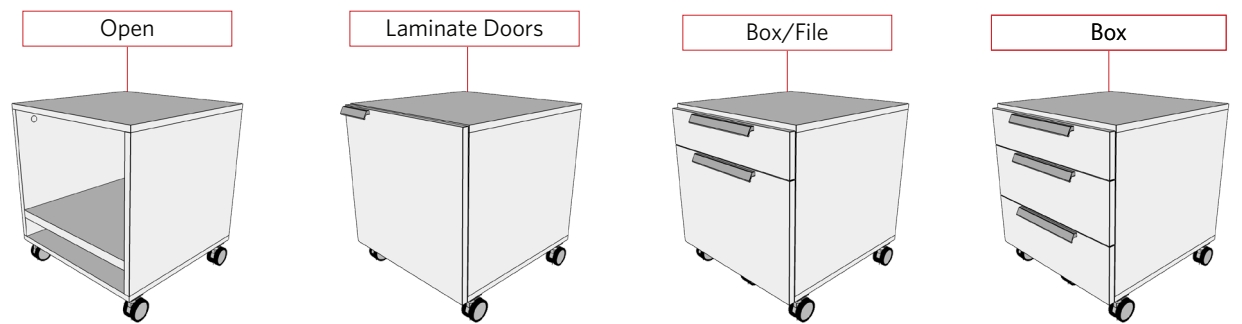

PULL POSITIONS

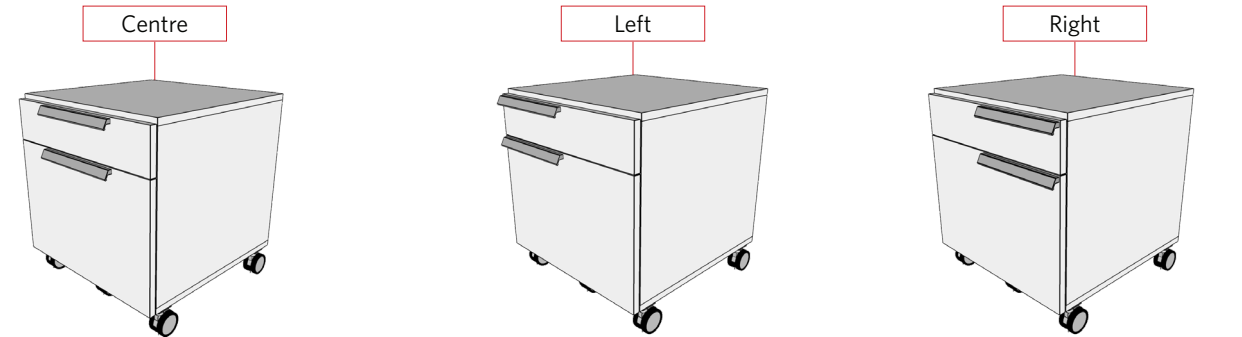

*Laminate door must be a left or right pull

HOW STORAGE STACKERS ARE USED

- ① **TOP STACKER**
LAMINATE DOORS + LAMINATE TOP
- ② **TOP STACKER**
OPEN + NO TOP
- ③ **MIDDLE STACKER**
SHELVES + SHELF STYLE TOP

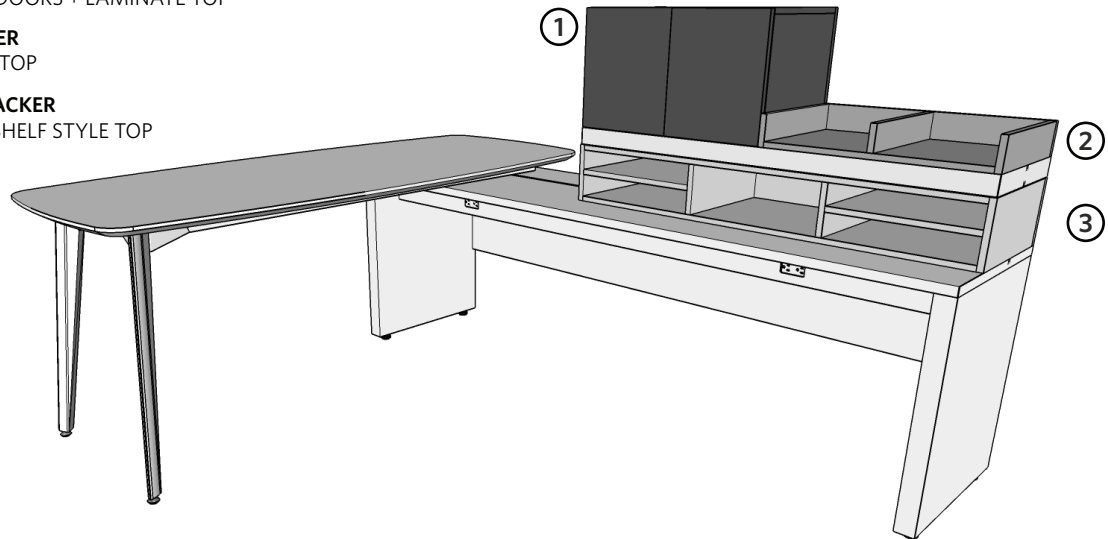

Depending on your configuration; the stackers will be 1 of 2 configurations: a **Top** or a **Middle**.

A Top Stacker can have a laminate top or no top (see Number 1 & 2 above). A Middle Stacker will always be 4 sided and constructed for use underneath or between Accessory Shelves (see Number 3 above).

The backs of the Stackers can be either Laminate, Whiteboard or Tackboard. Stackers are also available with no back for a shared storage option.

Decorative Laminate is available on Divides and Shelves. High Gloss Acrylic is available on the Doors.

Pages 23-26 show the Stackers with Decorative Laminate and High Gloss Acrylic where it is applicable. Regular Laminate can replace decorative and/or high gloss acrylic.

STACKER DETAILS

You can remove shelves from any stacker with a Back. No Back configurations use fixed shelves.

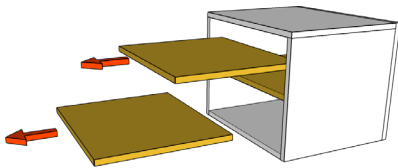

3.5"H	=	No shelves
7"H	=	1 shelf
10.5"H	=	2 shelves
14"H	=	3 shelves

For pricing on stackers without the standard amount of shelves please contact customer service.

The Stacker Shelves and/or Centre Divides can be accented with 1 of 5 Decorative Laminate Colours.

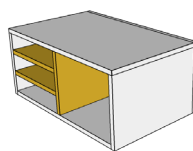

- =Honey Plantain
- =Summer Night Glow
- =Carmen Red
- =Kool Kiwi
- =French Blue
- =Standard Laminates

The Stacker Shelves Doors can be accented with 1 of 4 High Gloss Acrylic Colours.

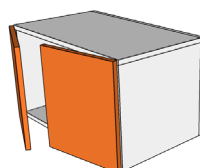

- =Acrylic Red
- =Acrylic Orange
- =Acrylic Grey
- =Acrylic White
- =Standard Laminates

7"H, 10.5"H & 14"H have the option for Whiteboard Back Style.

10.5"H & 14"H have the option for Tackboard Back Style.

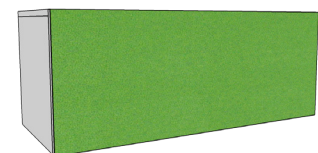

For pricing on stackers with Whiteboard or Tackboard Backs, please contact customer service.

12"W CONFIGURATIONS

Back+Top

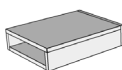

Back+No Top

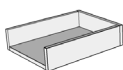

No Back+Top

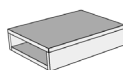

No Back+No Top

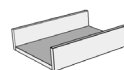

L Shape

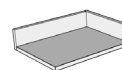

*Left or Right configuration

18"W CONFIGURATIONS

Back+Top

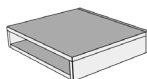

Back+No Top

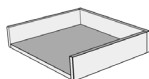

No Back+Top

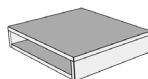

No Back+No Top

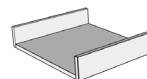

L Shape

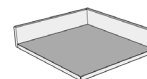

*Left or Right configuration

24"W CONFIGURATIONS

Back+Top

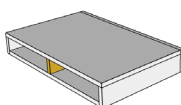

Back+No Top

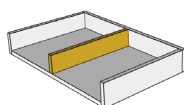

No Back+Top

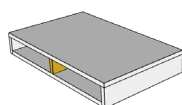

No Back+No Top

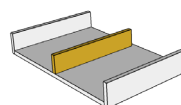

L Shape

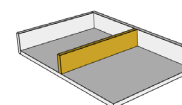

*Left or Right configuration

36"W CONFIGURATIONS

Back+Top

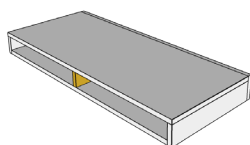

Back+No Top

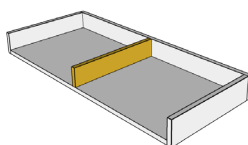

No Back+Top

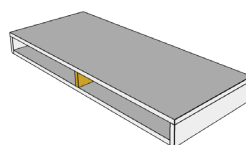

*A stacker with NO TOP can only be used as a TOP STACKER.

**When placing order, please ensure the stacker placement is clear.

***Yellow=Decorative Laminate**

Decorative Laminate can be replaced with regular laminate

12"W CONFIGURATIONS

Back+Top

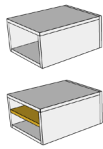

Back+No Top

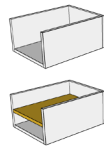

No Back+Top

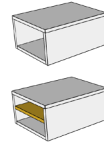

Flip Doors

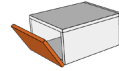

18"W CONFIGURATIONS

Back+Top

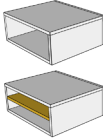

Back+No Top

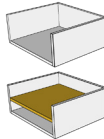

No Back+Top

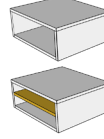

Flip Doors

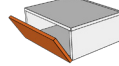

24"W CONFIGURATIONS

Back+Top

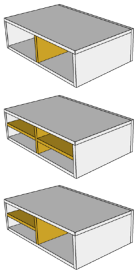

Back+No Top

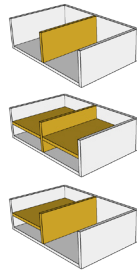

No Back+Top

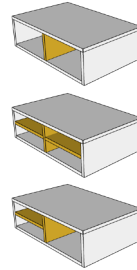

Flip Doors

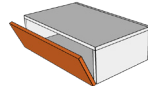

36"W CONFIGURATIONS

Back+Top

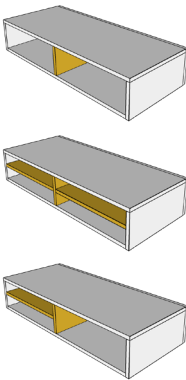

Back+No Top

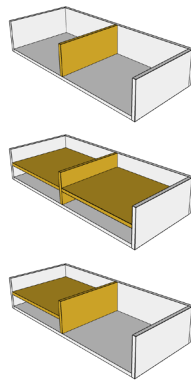

No Back+Top

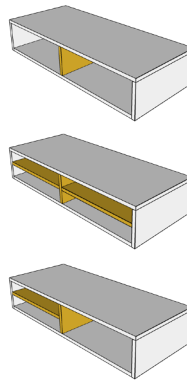

Flip Doors

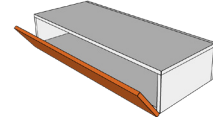

*A stacker with NO TOP can only be used as a TOP STACKER.

**When placing order, please ensure the stacker placement is clear.

***Yellow=Decorative Laminate**

Decorative Laminate can be replaced with regular laminate

***Orange=High Gloss Acrylic Doors**

High Gloss Acrylic can be replaced with regular laminate

12"W CONFIGURATIONS

Back+Top

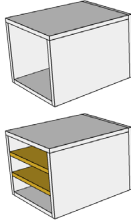

Back+No Top

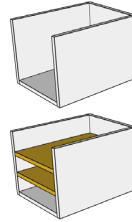

No Back+Top

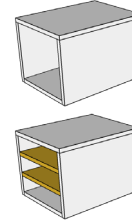

18"W CONFIGURATIONS

Back+Top

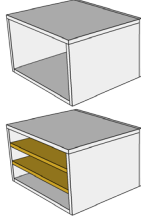

Back+No Top

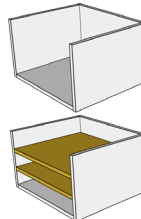

No Back+Top

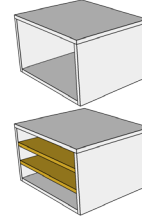

24"W CONFIGURATIONS

Back+Top

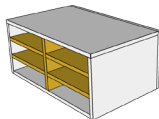
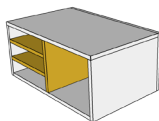
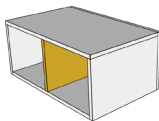

Back+No Top

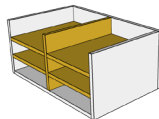
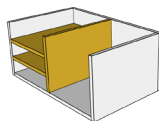
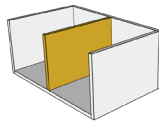

36"W CONFIGURATIONS

Back+Top

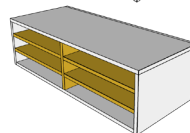
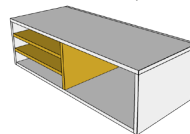
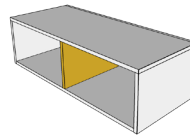

Back+No Top

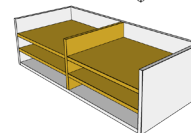
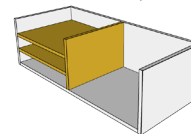
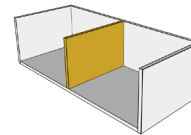

48"W CONFIGURATIONS

Back+Top

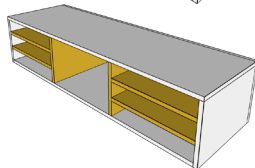
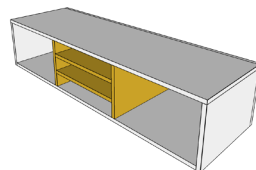
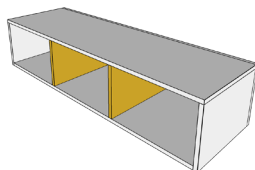

Back+No Top

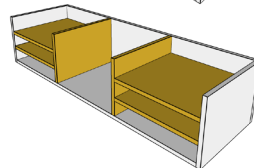
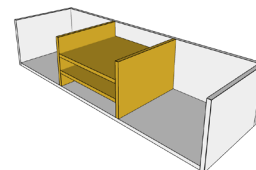
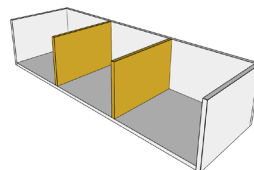

*A stacker with NO TOP can only be used as a TOP STACKER.

**When placing order, please ensure the stacker placement is clear.

***Yellow=Decorative Laminate**

Decorative Laminate can be replaced with regular laminate

6"W CONFIGURATIONS

Back+Top

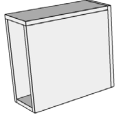

Back+No Top

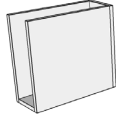

12"W CONFIGURATIONS

Back+Top

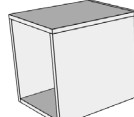

Back+No Top

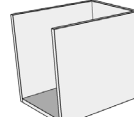

No Back+Top

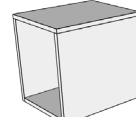

Door

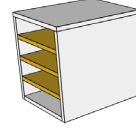
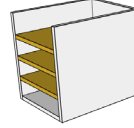
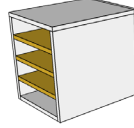
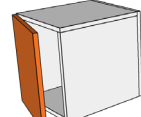

18"W CONFIGURATIONS

Back+Top

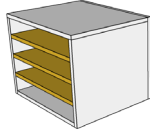
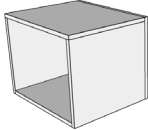

Back+No Top

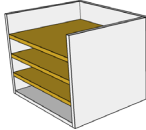
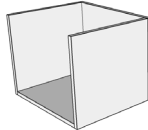

No Back+Top

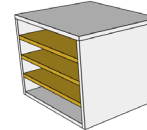
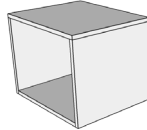

Doors

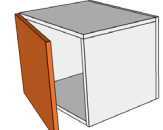

24"W CONFIGURATIONS

Back+Top

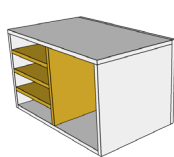
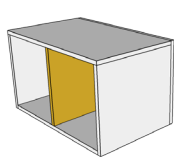

Back+No Top

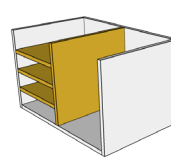
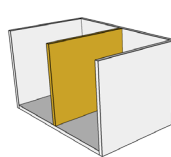

Doors

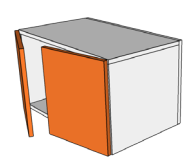

36"W CONFIGURATIONS

Back+Top

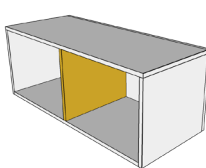

Back+No Top

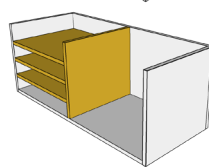
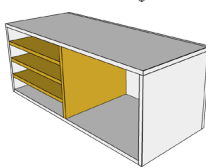
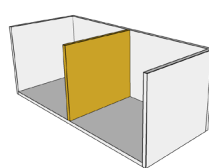

Doors

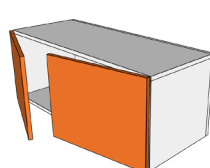

48"W CONFIGURATIONS

Back+Top

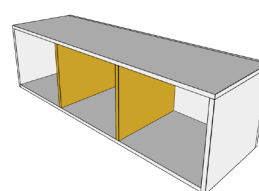

Back+No Top

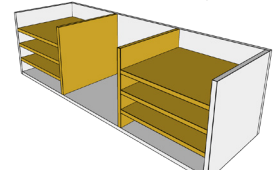
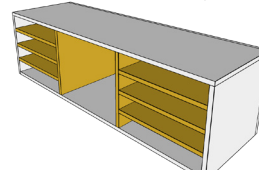
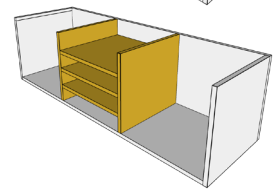
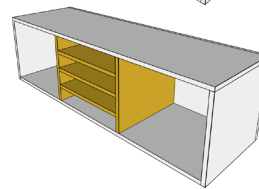
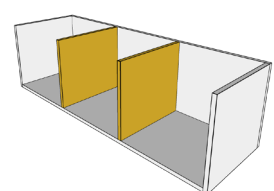

*A stacker with NO TOP can only be used as a TOP STACKER.

**When placing order, please ensure the stacker placement is clear.

***Yellow=Decorative Laminate**

Decorative Laminate can be replaced with regular laminate

***Orange=High Gloss Acrylic Doors**

High Gloss Acrylic can be replaced with regular laminate

HOW ACCESSORY SHELF IS USED

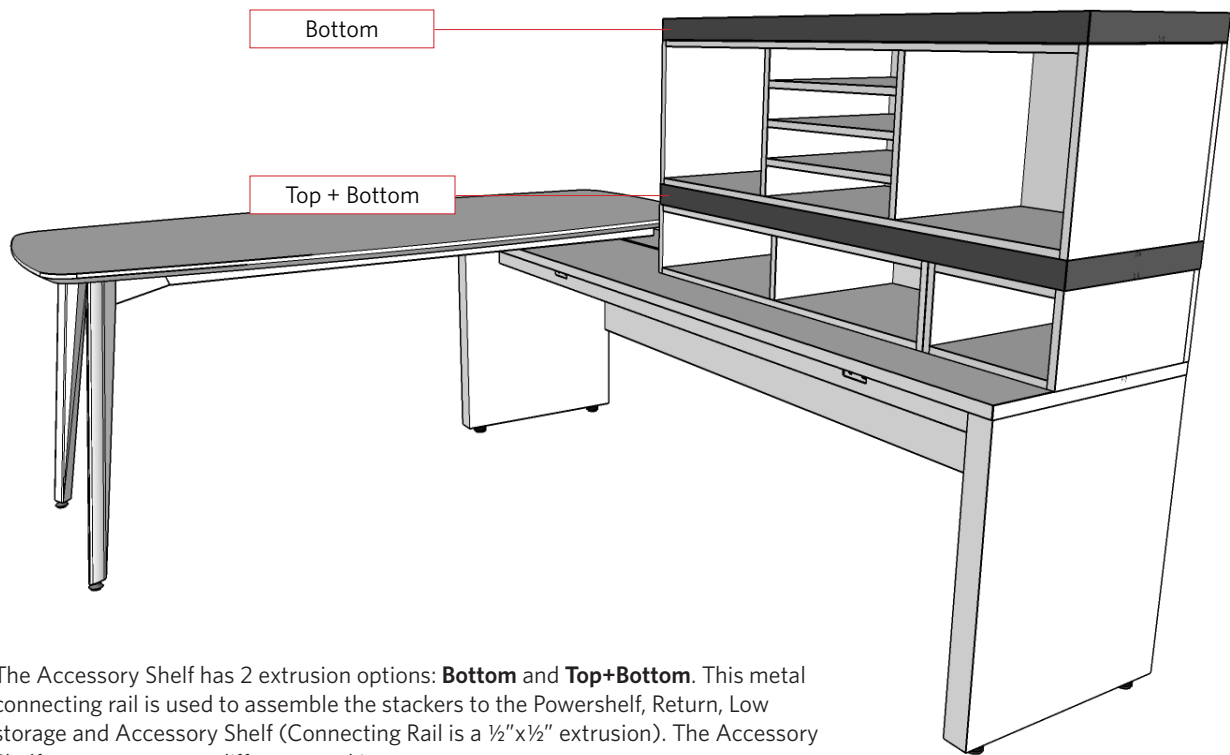

The Accessory Shelf has 2 extrusion options: **Bottom** and **Top+Bottom**. This metal connecting rail is used to assemble the stackers to the Powershelf, Return, Low storage and Accessory Shelf (Connecting Rail is a ½"x½" extrusion). The Accessory Shelf can create many different stacking arrangements.

Fixed dimensions: Height=2" / Depth=15"

Maximum of TWO Accessory Shelves per stack

LENGTHS

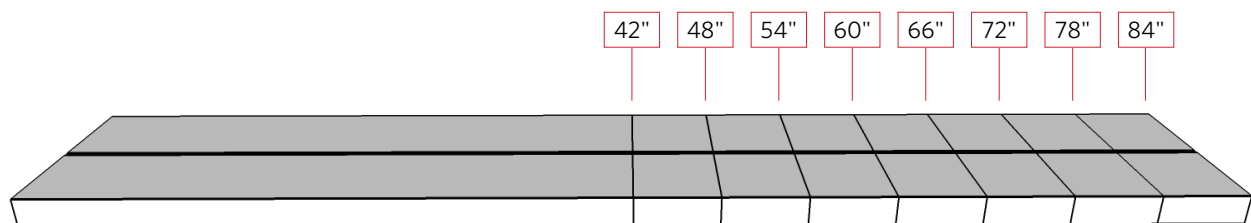

EXTRUSION OPTIONS

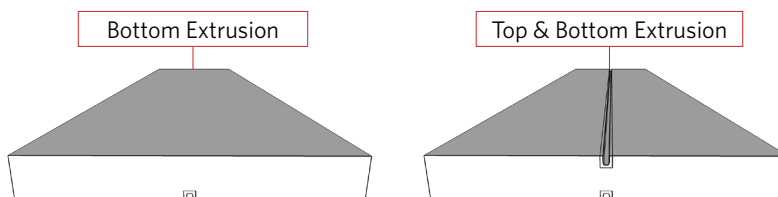

HOW ACCESSORY DIVIDERS ARE USED

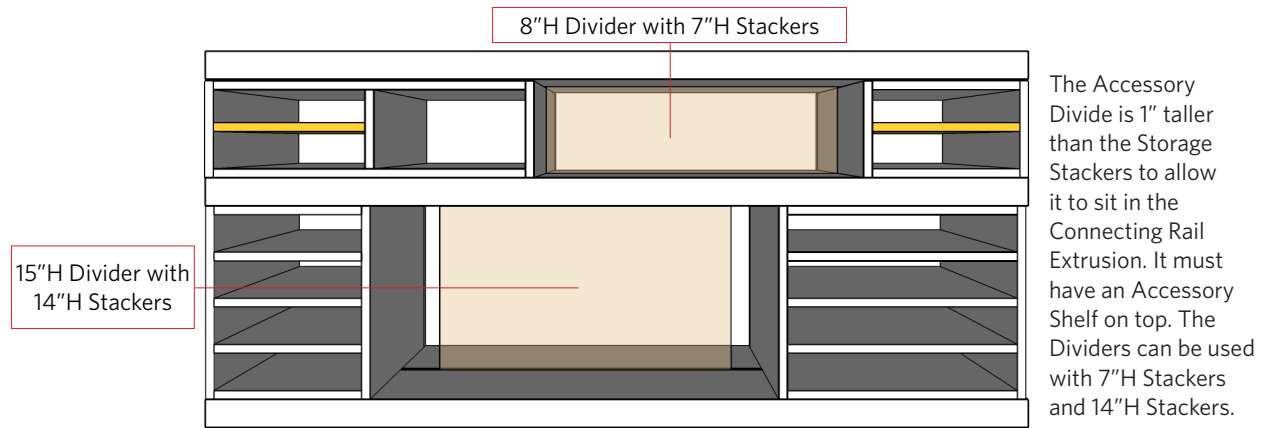

LENGTHS

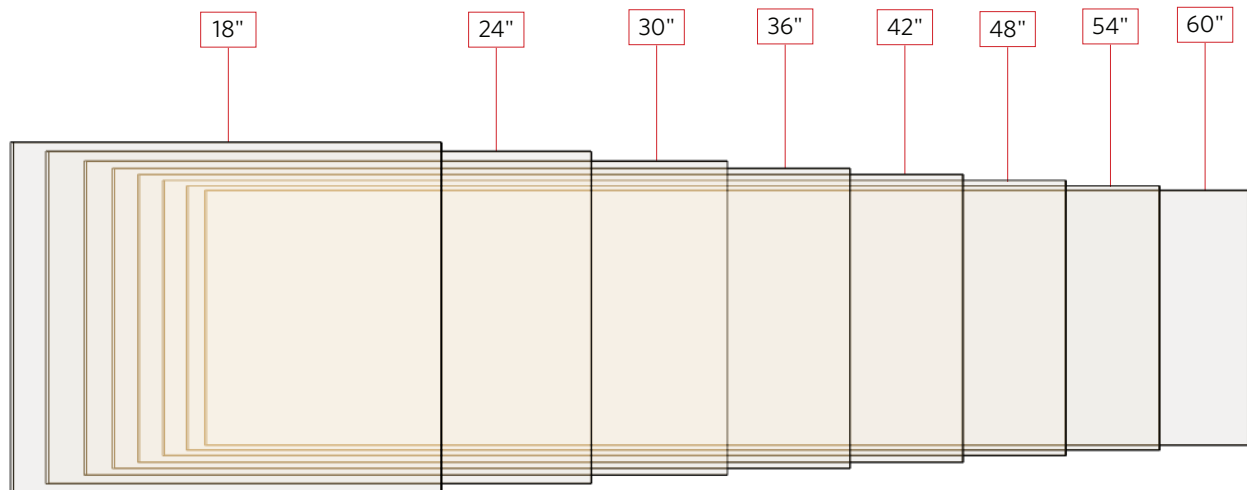

HEIGHTS

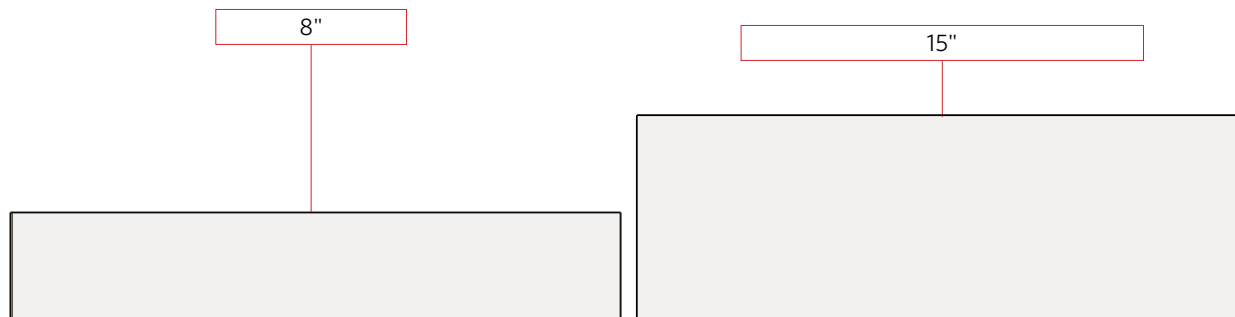

WIDTHS

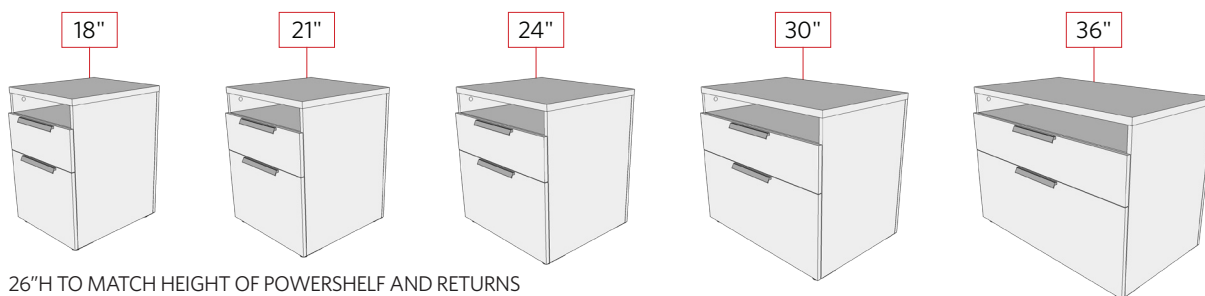

26"H TO MATCH HEIGHT OF POWERSHELF AND RETURNS

CONFIGURATIONS

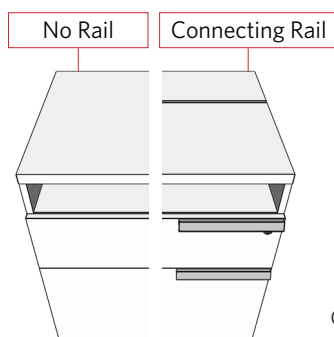
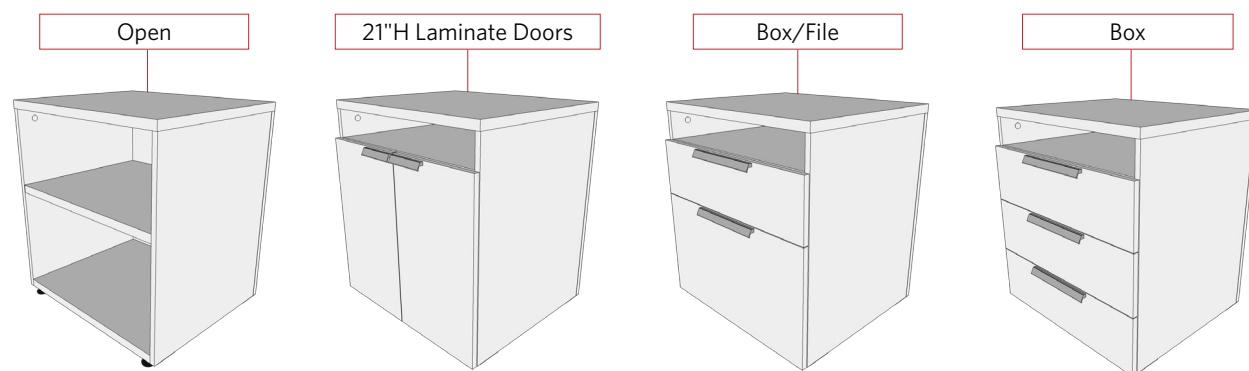

Connecting Rail is offset towards the back on Low Storage.
Offsetting the rail creates storage stackers flush to the back edge.

PULL POSITIONS

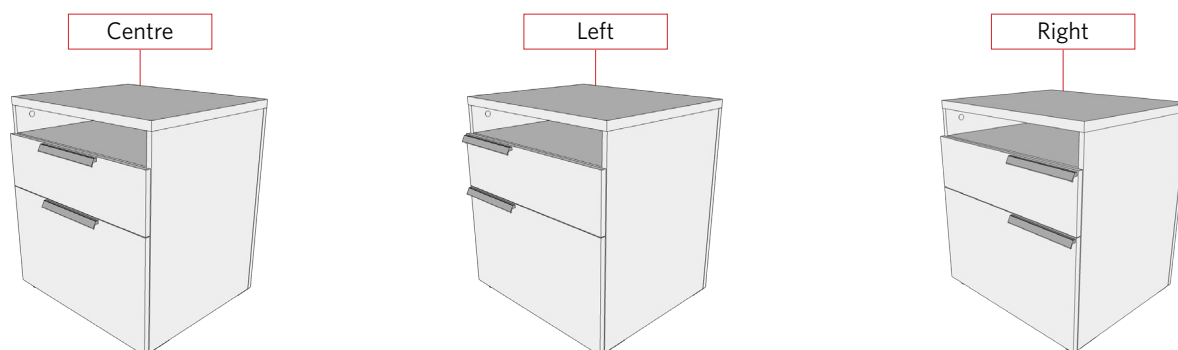

Centre pull position all widths

*Left & Right pull positions for 18", 21", 24" Widths only

WIDTHS

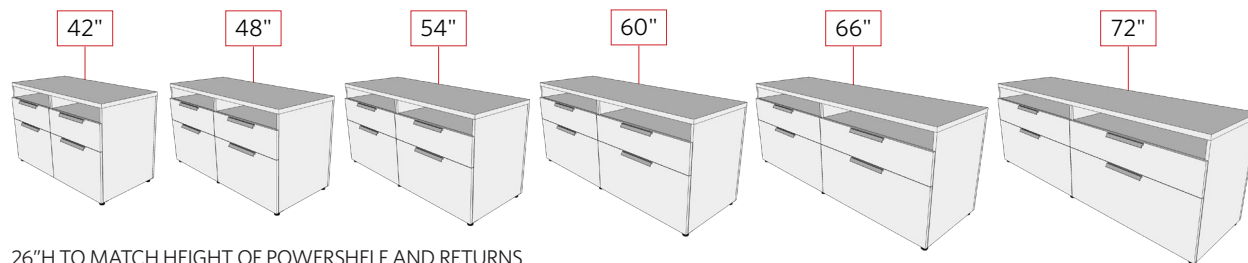

CONFIGURATIONS

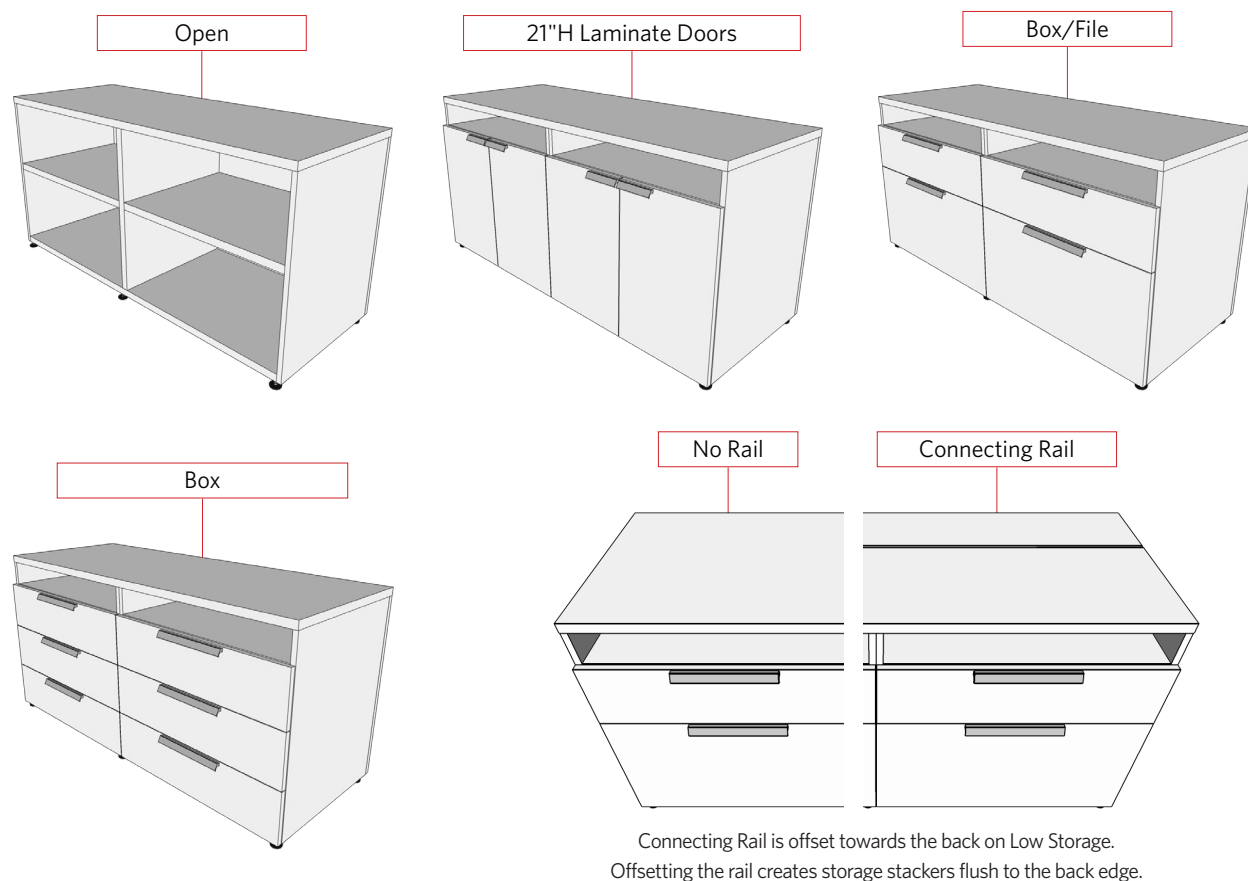

PULL POSITIONS

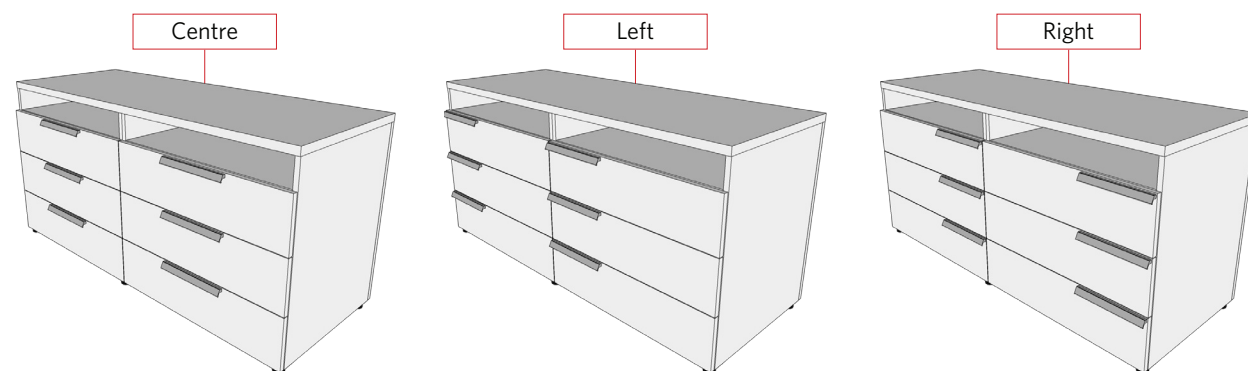

Centre pull position for all widths

*Left & Right pull positions for 42", 48" Credenza widths only

HEIGHTS

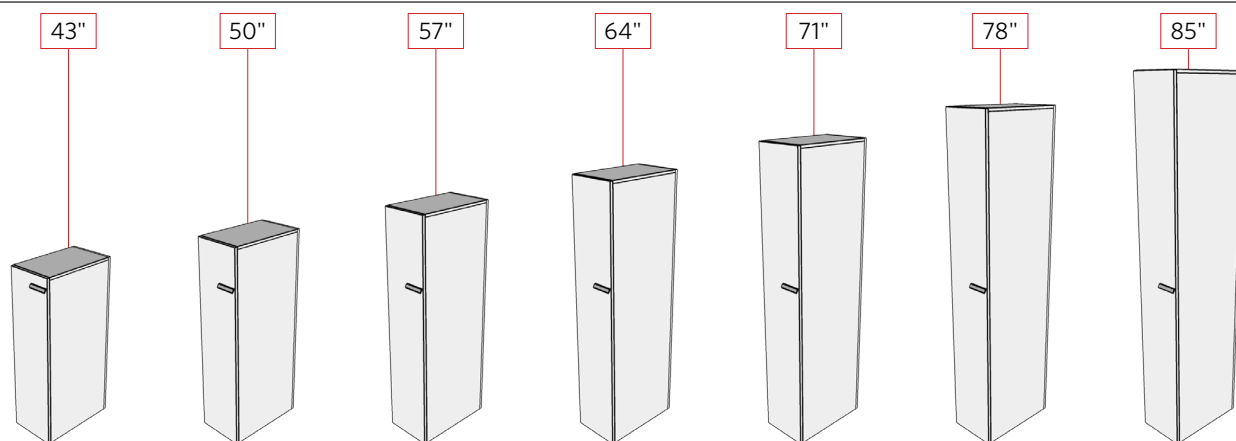

WIDTHS

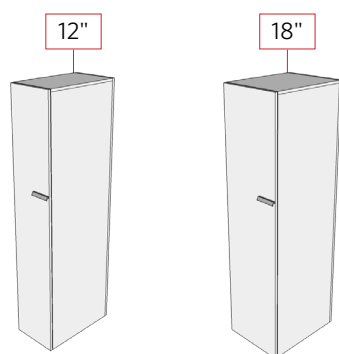

PULL POSITIONS

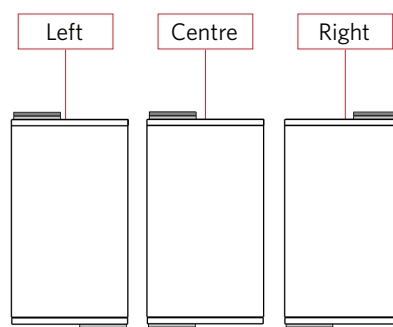

CONFIGURATIONS

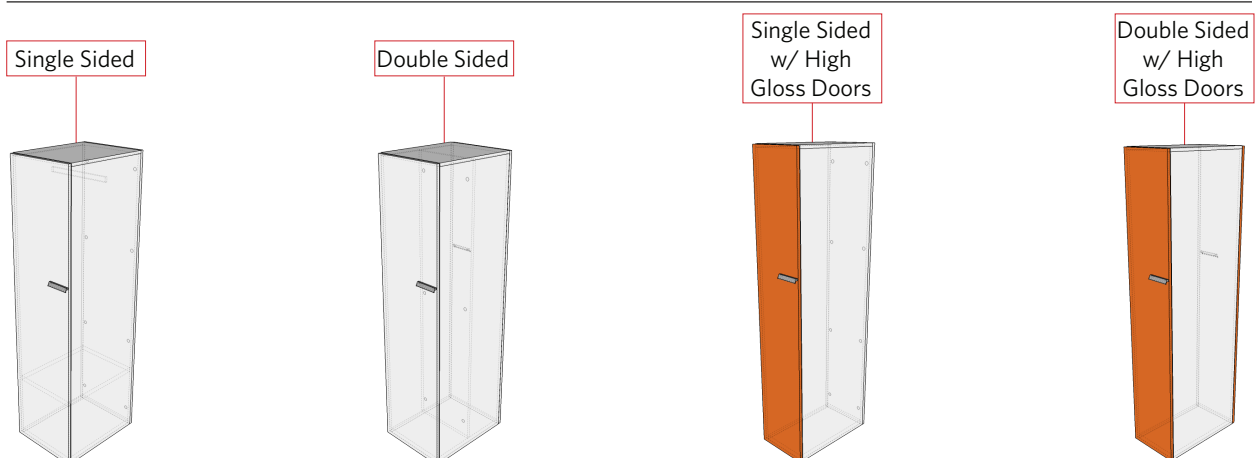

HEIGHTS

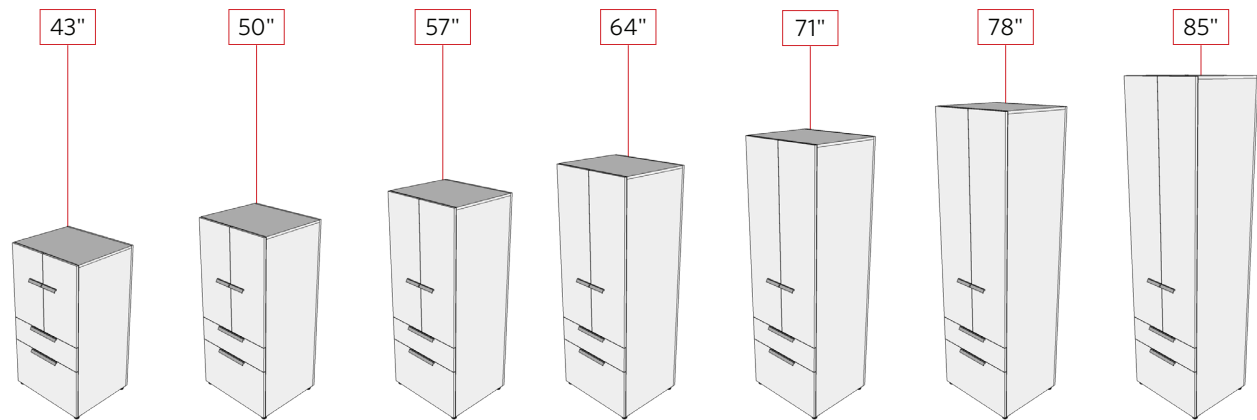

WIDTHS

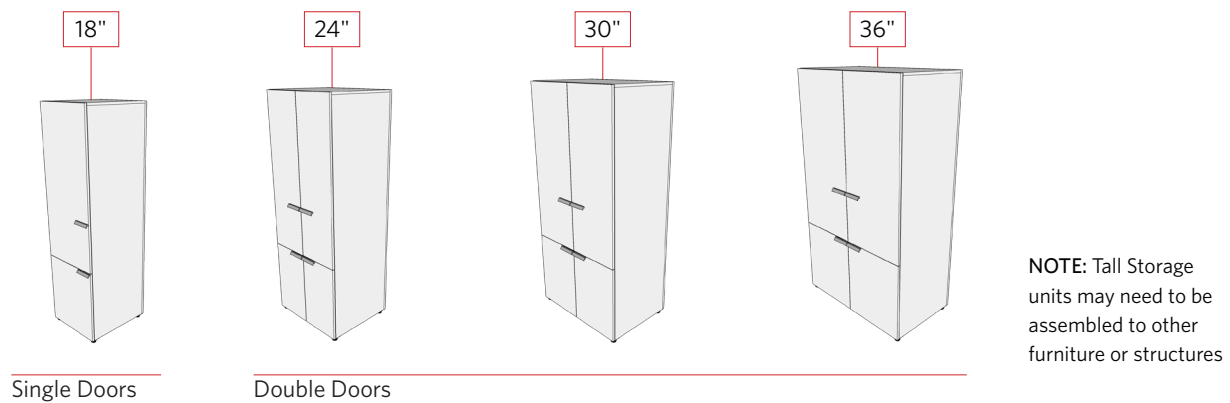

DEPTHS



CONFIGURATIONS

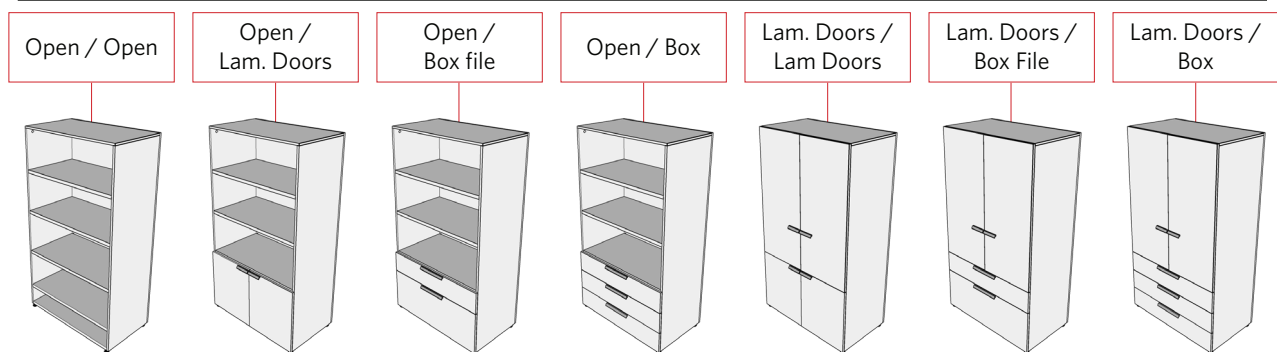

*Split point at 21" from base



WORKSHELF TYPICALS

378197



ITEM	L x D x H	QTY.
POWERSHELF Full Modesty, Single Sided	96 x 21 x 26	1
RETURN Full Modesty	72 x 21 x 26	1
WORKSURFACE Arc Wing Shape w/ Knife Edge	84 x 42 x 30	1
UNDER POWERSHELF STORAGE Box/File	21 x 19 x 21	1

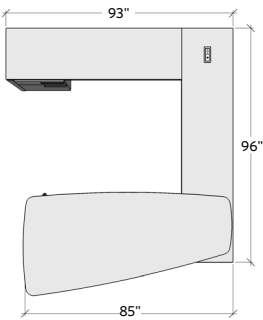

378198

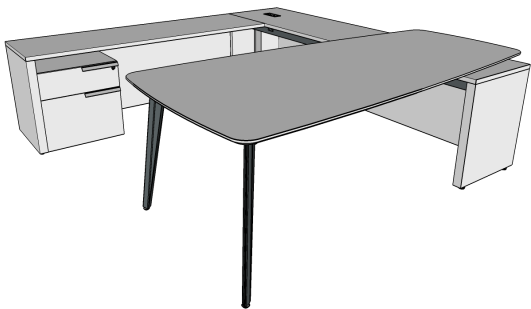

ITEM	L x D x H	QTY.
POWERSHELF Full Modesty, Single Sided	96 x 21 x 26	1
RETURN Full Modesty	72 x 21 x 26	1
WORKSURFACE Arc Taper Shape w/ Knife Edge	84 x 42 x 30	1
UNDER POWERSHELF STORAGE Box/File	21 x 19 x 21	1

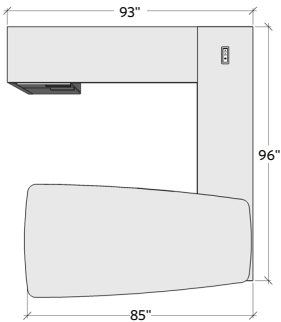

378199

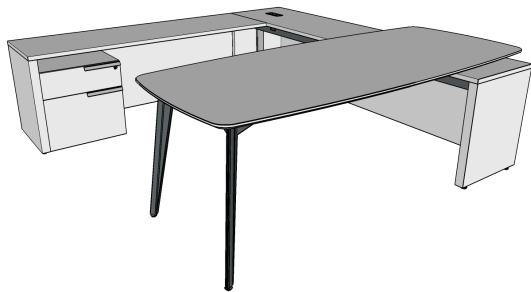

ITEM	L x D x H	QTY.
POWERSHELF Full Modesty, Single Sided	96 x 21 x 26	1
RETURN Full Modesty	72 x 21 x 26	1
WORKSURFACE Double Arc w/ Knife Edge	84 x 42 x 30	1
UNDER POWERSHELF STORAGE Box/File	21 x 19 x 21	1

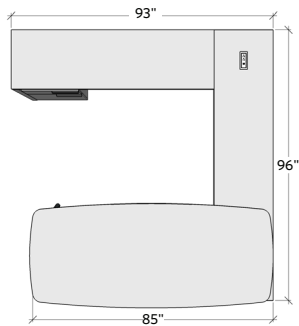

378200

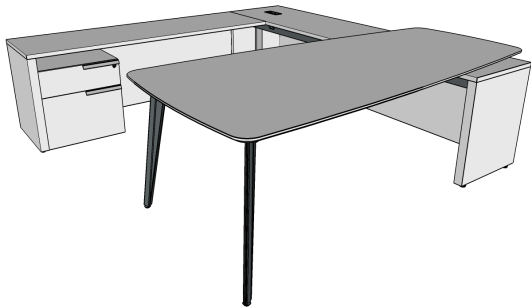

ITEM	L x D x H	QTY.
POWERSHELF Full Modesty, Single Sided	96 x 21 x 26	1
RETURN Full Modesty	72 x 21 x 26	1
WORKSURFACE Rectangular w/ Knife Edge	84 x 42 x 30	1
UNDER POWERSHELF STORAGE Box/File	30 x 19 x 21	1

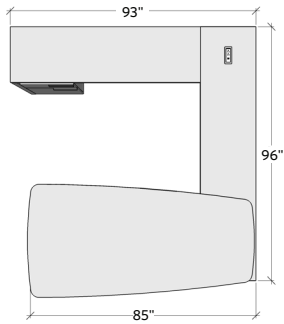
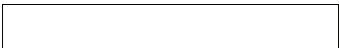

378201

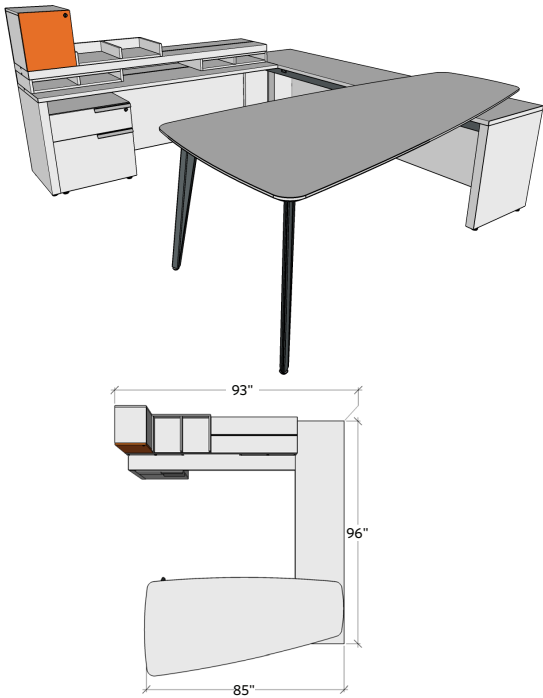

ITEM	L x D x H	QTY.
POWERSHELF Full Modesty, Single Sided	96 x 21 x 26	1
RETURN Full Modesty	72 x 21 x 26	1
WORKSURFACE Arc Wing w/ Knife Edge	84 x 42 x 30	1
UNDER POWERSHELF STORAGE Box/File	30 x 19 x 21	1
ACCESSORY SHELF Top & Bottom Rail	72 x 15 x 02	1
STORAGE STACK High Gloss Door Top Stacker	18 x 15 x 14	1
STORAGE STACK Open Middle Stacker	24 x 15 x 3.5	2
STORAGE STACK Open Top Stacker w/ no Top	24 x 15 x 3.5	1

378202

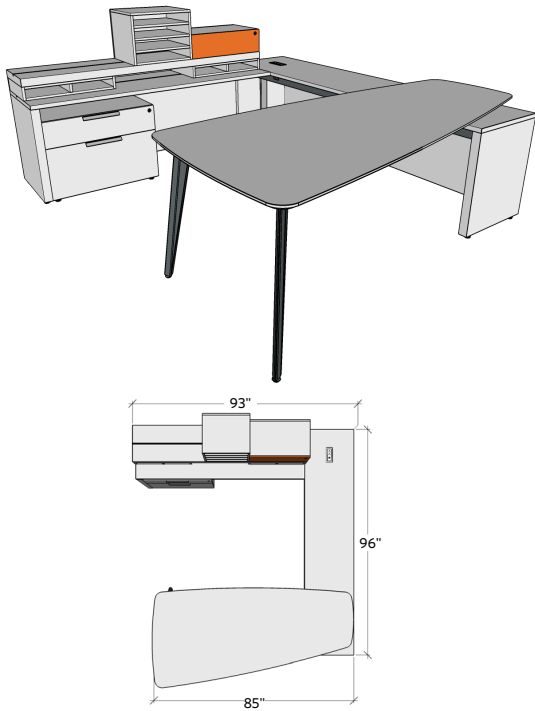

ITEM	L x D x H	QTY.
POWERSHELF Full Modesty, Single Sided	96 x 21 x 26	1
RETURN Full Modesty	72 x 21 x 26	1
WORKSURFACE Arc Wing w/ Knife Edge	84 x 42 x 30	1
UNDER POWERSHELF STORAGE Box/File	30 x 19 x 21	1
STORAGE WARDROBE Single Sided	12 x 21 x 57	1
ACCESSORY SHELF Top & Bottom Rail	72 x 15 x 02	1
STORAGE STACK Open Middle Stacker	24 x 15 x 3.5	2
STORAGE STACK 3 Shelves Top Stacker	18 x 15 x 14	1
STORAGE STACK High Gloss Flip Door Top Stacker	24 x 15 x 7	1

378203

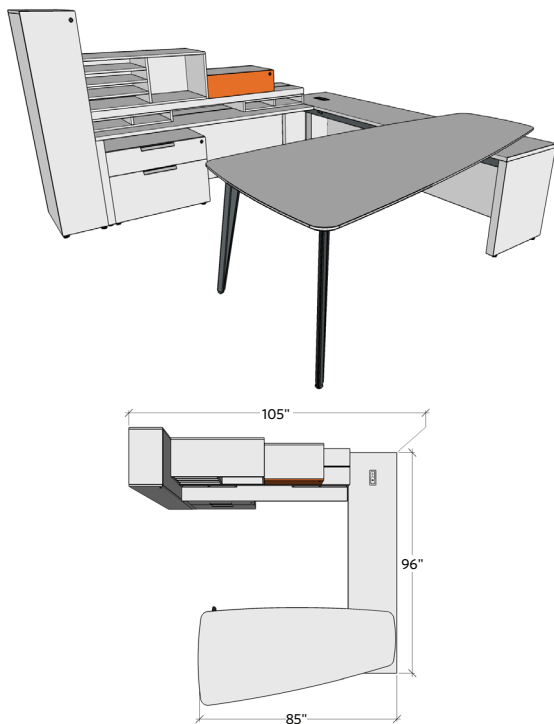

ITEM	L x D x H	QTY.
POWERSHELF Full Modesty, Single Sided	96 x 21 x 26	1
RETURN Full Modesty	72 x 21 x 26	1
WORKSURFACE Arc Wing w/ Knife Edge	84 x 42 x 30	1
UNDER POWERSHELF STORAGE Box/File	30 x 19 x 21	1
STORAGE WARDROBE Single Sided	12 x 21 x 57	1
ACCESSORY SHELF Top & Bottom Rail	72 x 15 x 02	1
STORAGE STACK High Gloss Flip Door Top Stacker	24 x 15D x 7	1
STORAGE STACK Open Middle Stacker	24 x 15 x 3.5	2
STORAGE STACK 3 Shelves/Open Top Stacker	36 x 15 x 14	1

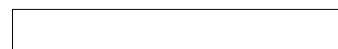

378204

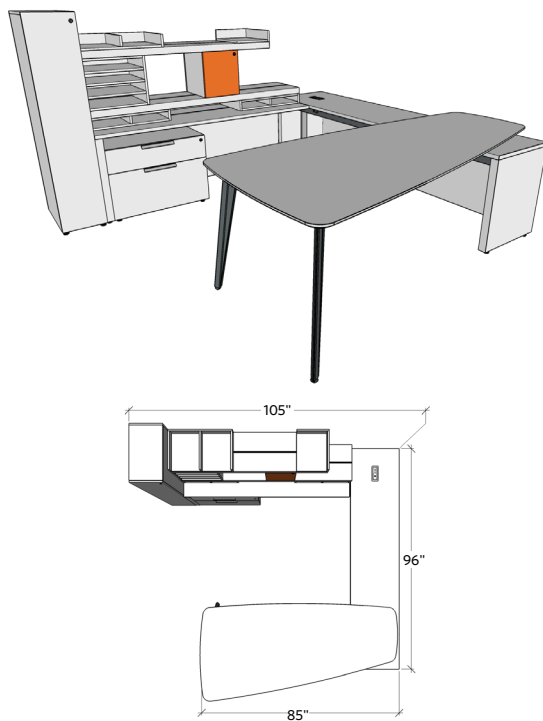

ITEM	L x D x H	QTY.
POWERSHELF Full Modesty, Single Sided	96 x 21 x 26	1
RETURN Full Modesty	72 x 21 x 26	1
WORKSURFACE Arc Wing w/ Knife Edge	84 x 42 x 30	1
UNDER POWERSHELF STORAGE Box/File	30 x 19 x 21	1
STORAGE WARDROBE Single Sided	12 x 21 x 57	1
ACCESSORY SHELF Top & Bottom Rail	60 x 15 x 02	1
ACCESSORY SHELF Top & Bottom Rail	72 x 15 x 02	1
STORAGE STACK L Shape Top Stacker w/ No Top	12 x 15 x 3.5	1
STORAGE STACK Open Top Stacker w/ No Top	24 x 15 x 3.5	1
STORAGE STACK Open Middle Stacker	24 x 15 x 3.5	2
STORAGE STACK 3 Shelves Middle Stacker	18 x 15 x 14	1
STORAGE STACK High Gloss Door Middle Stacker	12 x 15 x 14	1



378205

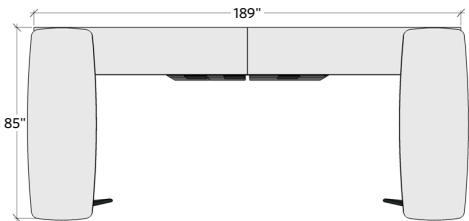

ITEM	L x D x H	QTY.
POWERSHELF Full Modesty, Single Sided	96 x 21 x 26	2
WORKSURFACE Double Arc w/ Knife Edge	84 x 30 x 30	2
UNDER POWERSHELF STORAGE Box/File	21 x 19 x 21	2
UNDER POWERSHELF STORAGE Box/File	36 x 19 x 21	1



378206

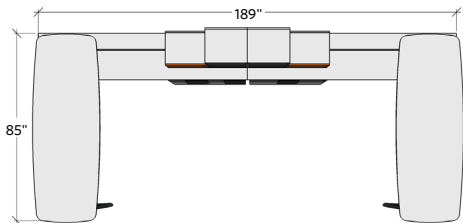
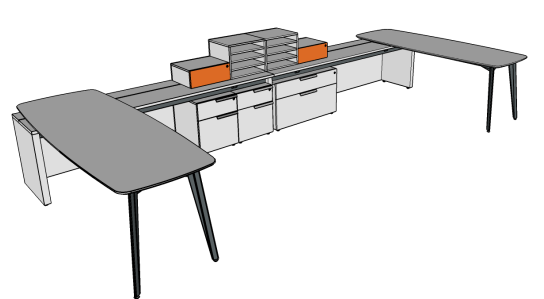

ITEM	L x D x H	QTY.
POWERSHELF Full Modesty, Single Sided	96 x 21 x 26	2
WORKSURFACE Double Arc w/ Knife Edge	84 x 30 x 30	2
UNDER POWERSHELF STORAGE Box/File	21 x 19 x 21	2
UNDER POWERSHELF STORAGE Box/File	36 x 19 x 21	1
STORAGE STACK 3 Shelves Top Stacker	18 x 15 x 14	2
STORAGE STACK High Gloss Flip Door Top Stacker	18 x 15 x 14	2



378207

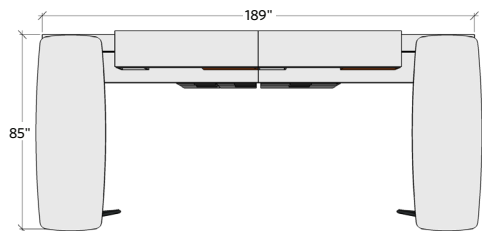
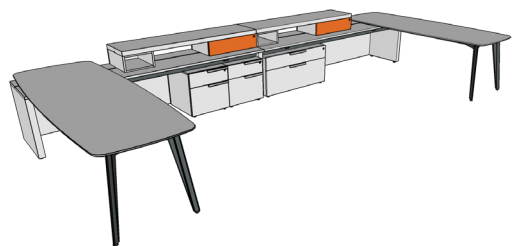

ITEM	L x D x H	QTY.
POWERSHELF Full Modesty, Single Sided	96 x 21 x 26	2
WORKSURFACE Double Arc w/ Knife Edge	84 x 30 x 30	2
UNDER POWERSHELF STORAGE Box/File	21 x 19 x 21	2
UNDER POWERSHELF STORAGE Box/File	36 x 19 x 21	1
STORAGE STACK High Gloss Flip Door Middle Stacker	24 x 15 x 7	2
STORAGE STACK Open Middle Stacker	12 x 15 x 7	2
ACCESSORY SHELF Bottom Rail	60 x 15 x 02	2



378208

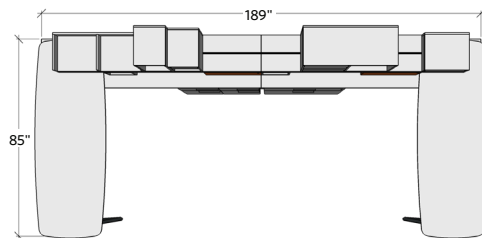
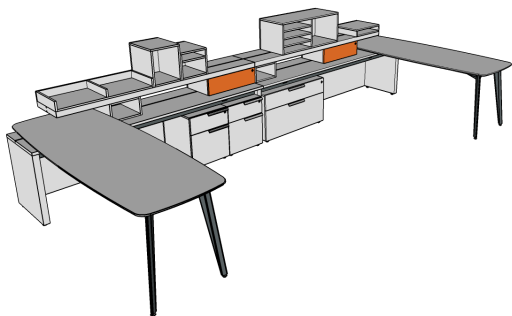

ITEM	L x D x H	QTY.
POWERSHELF Full Modesty, Single Sided	96 x 21 x 26	2
WORKSURFACE Double Arc w/ Knife Edge	84 x 30 x 30	2
UNDER POWERSHELF STORAGE Box/File	21 x 19 x 21	2
UNDER POWERSHELF STORAGE Box/File	36 x 19 x 21	1
STORAGE STACK High Gloss Flip Door Middle Stacker	24 x 15 x 7	2
STORAGE STACK Open Middle Stacker	12 x 15 x 7	2
ACCESSORY SHELF Top & Bottom Rail	84 x 15 x 02	2
STORAGE STACK 1 Shelf Top Stacker	12 x 15 x 10.5	1
STORAGE STACK Open Top Stacker	12 x 15 x 14	1
STORAGE STACK Open Top Stacker	18 x 15 x 3.5	1
STORAGE STACK Open Top Stacker w/ No Top	36 x 15 x 3.5	1
STORAGE STACK 3 Shelves/ Open Top Stacker	36 x 15 x 14	1

378209

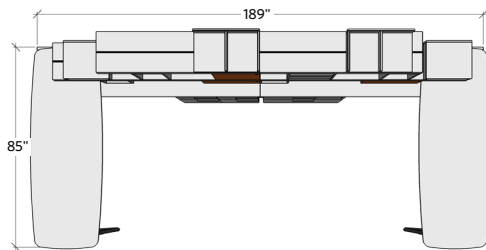
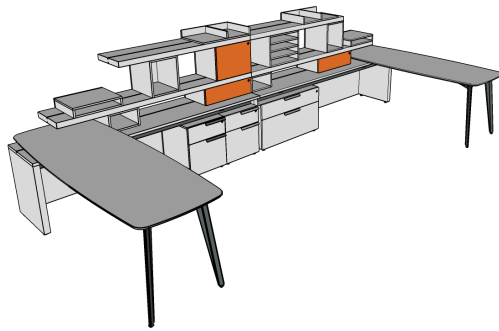

ITEM	L x D x H	QTY.
POWERSHELF Full Modesty, Single Sided	96 x 21 x 26	2
WORKSURFACE Double Arc w/ Knife Edge	84 x 30 x 30	2
UNDER POWERSHELF STORAGE Box/File	21 x 19 x 21	2
UNDER POWERSHELF STORAGE Box/File	36 x 19 x 21	1
STORAGE STACK High Gloss Flip Door Middle Stacker	24 x 15 x 7	2
STORAGE STACK Open Middle Stacker	12 x 15 x 7	2
ACCESSORY SHELF Top & Bottom Rail	84 x 15 x 02	2
STORAGE STACK 3 Shelves Middle Stacker	18 x 15 x 14	1
STORAGE STACK Open Middle Stacker	12 x 15 x 14	2
STORAGE STACK Door Middle Stacker	18 x 15 x 14	2
ACCESSORY SHELF Top & Bottom Rail	60 x 15 x 02	2
STORAGE STACK L Shape Top Stacker w/ No Top	24 x 15 x 3.5	2

378210

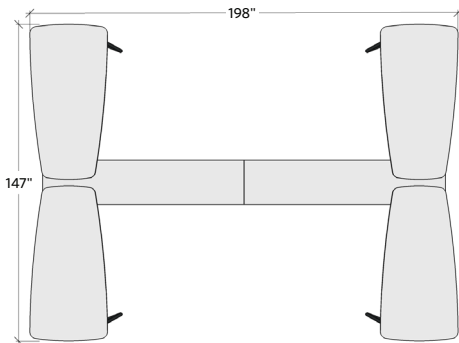
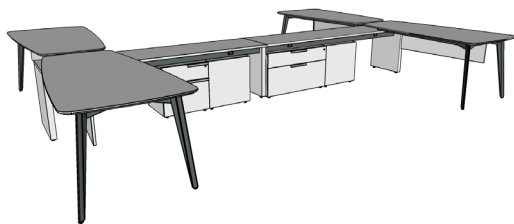

ITEM	L x D x H	QTY.
POWERSHELF No Modesty, Double Sided	96 x 21 x 26	2
WORKSURFACE Arc Taper w/ Knife Edge	72 x 36 x 30	4
UNDER POWERSHELF STORAGE Box/File	21 x 19 x 21	3
UNDER POWERSHELF STORAGE Box/File	36 x 19 x 21	1

378211

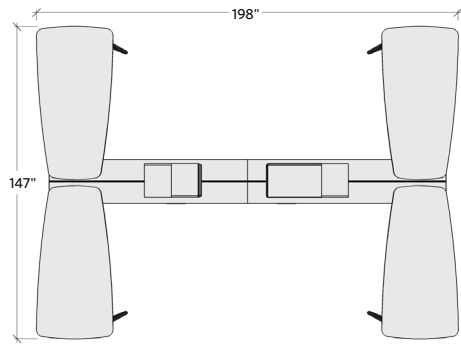

ITEM	L x D x H	QTY.
POWERSHELF No Modesty, Double Sided	96 x 21 x 26	2
WORKSURFACE Arc Taper w/ Knife Edge	72 x 36 x 30	4
UNDER POWERSHELF STORAGE Box/File	21 x 19 x 21	3
UNDER POWERSHELF STORAGE Box/File	36 x 19 x 21	1
STORAGE STACK 3 Shelves Top Stacker	12 x 15 x 14	3
STORAGE STACK 2 Shelves/ Open Top Stacker	24 x 15 x 14	1

378212

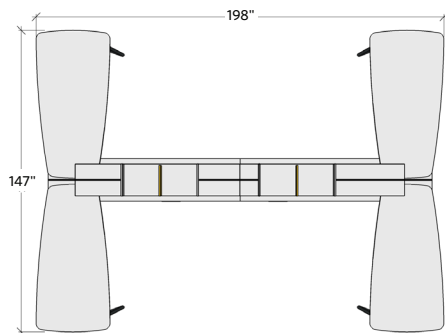
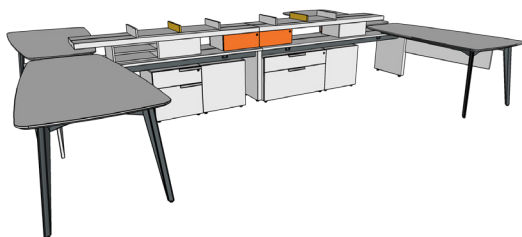

ITEM	L x D x H	QTY.
POWERSHELF No Modesty, Double Sided	96 x 21 x 26	2
WORKSURFACE Arc Taper w/ Knife Edge	72 x 36 x 30	4
UNDER POWERSHELF STORAGE Box/File	21 x 19 x 21	3
UNDER POWERSHELF STORAGE Box/File	36 x 19 x 21	1
STORAGE STACK High Gloss Flip Door Middle Stacker	18 x 15 x 7	4
STORAGE STACK 1 Shelf Middle Stacker, No Back	18 x 15 x 7	1
ACCESSORY SHELF Top & Bottom Connection	78 x 15 x 02	2
STORAGE STACK Open Top Stacker w/ No Top	36 x 15 x 3.5	2

378213

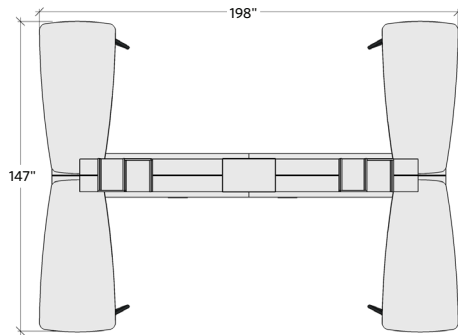
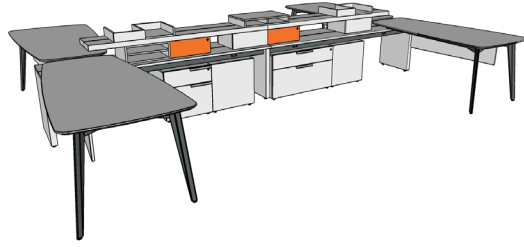

ITEM	L x D x H	QTY.
POWERSHELF No Modesty, Double Sided	96 x 21 x 26	2
WORKSURFACE Arc Taper w/ Knife Edge	72 x 36 x 30	4
UNDER POWERSHELF STORAGE Box/File	21 x 19 x 21	3
UNDER POWERSHELF STORAGE Box/File	36 x 19 x 21	1
STORAGE STACK High Gloss Flip Door Middle Stacker	12 x 15 x 7	4
STORAGE STACK 1 Shelf Middle Stacker, No Back	18 x 15 x 7	1
ACCESSORY SHELF Top & Bottom Connection	78 x 15 x 02	2
STORAGE STACK Open Top Stacker	24 x 15 x 3.5	1
STORAGE STACK L Shape Top Stacker w/ No Top	12 x 15 x 3.5	4

378214

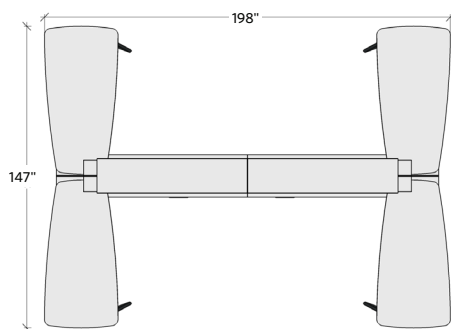

ITEM	L x D x H	QTY.
POWERSHELF No Modesty, Double Sided	96 x 21 x 26	2
WORKSURFACE Arc Taper w/ Knife Edge	72 x 36 x 30	4
UNDER POWERSHELF STORAGE Box/File	21 x 19 x 21	3
UNDER POWERSHELF STORAGE Box/File	36 x 19 x 21	1
STORAGE STACK High Gloss Flip Door Middle Stacker	12 x 15 x 7	4
STORAGE STACK 1 Shelf Middle Stacker No Back	18 x 15 x 7	1
ACCESSORY SHELF Top & Bottom Connection	78 x 15 x 02	2
STORAGE STACK High Gloss Door Middle Stacker	18 x 15 x 14	4
ACCESSORY SHELF Bottom Connection	66 x 15 x 02	2

378215

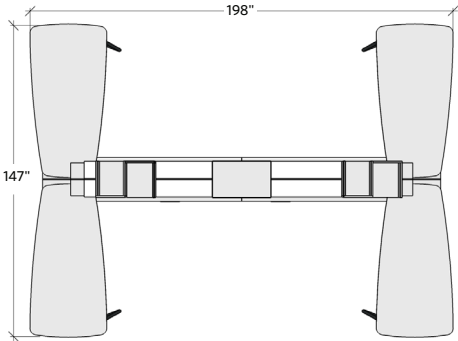

ITEM	L x D x H	QTY.
POWERSHELF No Modesty, Double Sided	96 x 21 x 26	2
WORKSURFACE Arc Taper w/ Knife Edge	72 x 36 x 30	4
UNDER POWERSHELF STORAGE Box/File	21 x 19 x 21	3
UNDER POWERSHELF STORAGE Box/File	36 x 19 x 21	1
STORAGE STACK High Gloss Flip Door Middle Stacker	12 x 15 x 7	4
STORAGE STACK 1 Shelf Middle Stacker No Back	18 x 15 x 7	1
ACCESSORY SHELF Top & Bottom Connection	78 x 15 x 02	2
STORAGE STACK High Gloss Door Middle Stacker	18 x 15 x 14	4
ACCESSORY SHELF Bottom Connection	66 x 15 x 02	2
STORAGE STACK Open Top Stacker, No Top	12 x 15 x 3.5	4
STORAGE STACK Open Top Stacker, No Back	24 x 15 x 3.5	1

378216

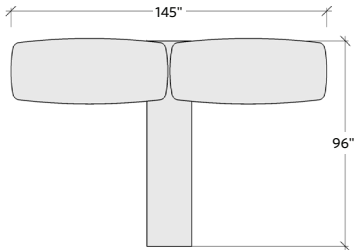
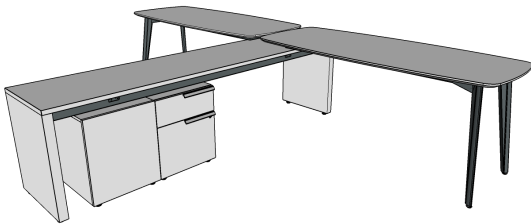

ITEM	L x D x H	QTY.
POWERSHELF No Modesty, Double Sided	96 x 21 x 26	1
WORKSURFACE Double Arc w/ Knife Edge	72 x 30 x 30	2
UNDER POWERSHELF STORAGE Box/File	21 x 19 x 21	2

378217

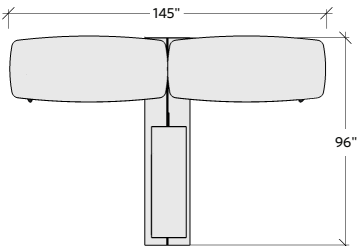
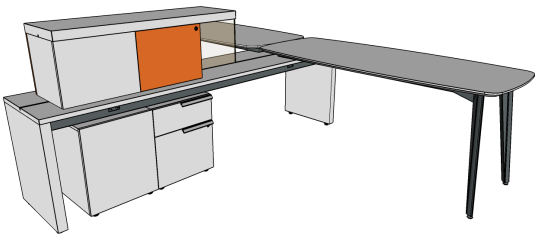

ITEM	L x D x H	QTY.
POWERSHELF No Modesty, Double Sided	96 x 21 x 26	1
WORKSURFACE Double Arc w/ Knife Edge	72 x 30 x 30	2
UNDER POWERSHELF STORAGE Box/File	21 x 19 x 21	2
STORAGE STACK High Gloss Door Middle Stacker	18 x 15 x 14	2
ACCESSORY DIVIDE Smoked Acrylic	18L x 15H	1
ACCESSORY SHELF Bottom Rail	48 x 15 x 02	1

378218

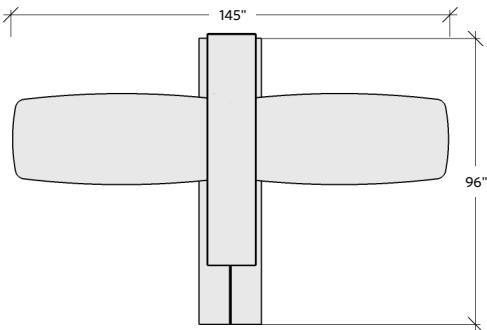
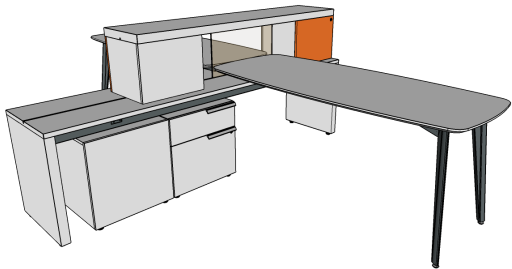

ITEM	L x D x H	QTY.
POWERSHELF No Modesty, Double Sided	96 x 21 x 26	1
WORKSURFACE Double Arc w/ Knife Edge	72 x 30 x 30	2
UNDER POWERSHELF STORAGE Box/File	21 x 19 x 21	2
STORAGE STACK High Gloss Door Middle Stacker	18 x 15 x 14	2
ACCESSORY DIVIDE Smoked Acrylic	24L x 15H	1
ACCESSORY SHELF Bottom Rail	78 x 15 x 02	1

378219

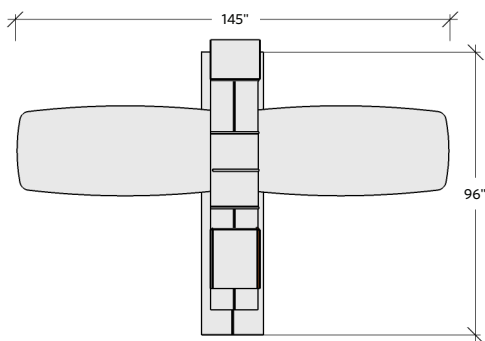
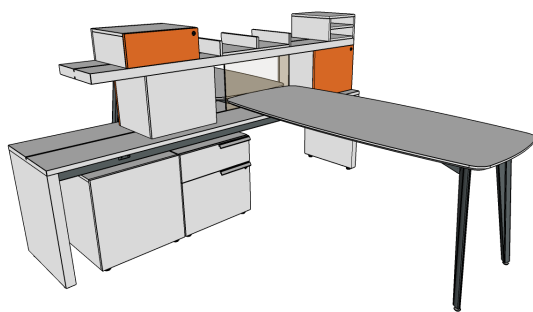

ITEM	L x D x H	QTY.
POWERSHELF No Modesty, Double Sided	96 x 21 x 26	1
WORKSURFACE Double Arc w/ Knife Edge	72 x 30 x 30	2
UNDER POWERSHELF STORAGE Box/File	21 x 19 x 21	2
STORAGE STACK High Gloss Door Middle Stacker	18 x 15 x 14	2
ACCESSORY DIVIDE Smoked Acrylic	24L x 15H	1
ACCESSORY SHELF Top & Bottom Rail	84 x 15 x 02	1
STORAGE STACK High Gloss Flip Door Top Stacker	24 x 15 x 7	1
STORAGE STACK Open Top Stacker w/ No Back	12 x 15 x 7	1
STORAGE STACK Open Top Stacker w/ No Top + No Back	24 x 15 x 3.5	1

378220

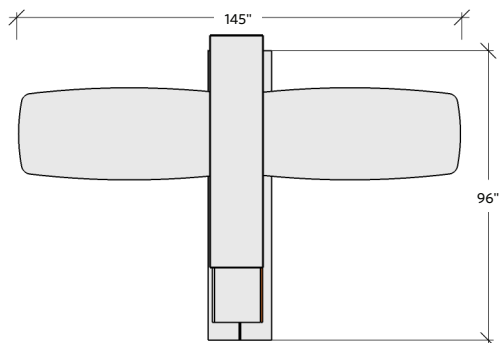
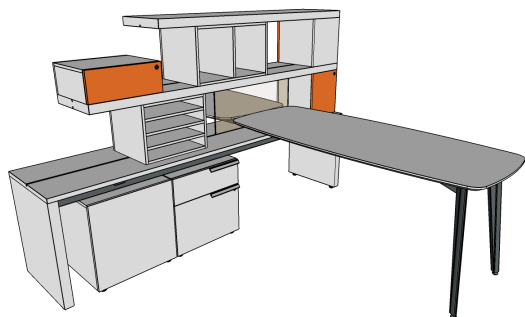

ITEM	L x D x H	QTY.
POWERSHELF No Modesty, Double Sided	96 x 21 x 26	1
WORKSURFACE Double Arc w/ Knife Edge	72 x 30 x 30	2
UNDER POWERSHELF STORAGE Box/File	21 x 19 x 21	2
STORAGE STACK High Gloss Door Middle Stacker	12 x 15 x 14	2
STORAGE STACK 3 Shelves Middle Stacker	18 x 15 x 14	1
ACCESSORY DIVIDE Smoked Acrylic	30L x 15H	1
ACCESSORY SHELF Top & Bottom Rail	84 x 15 x 02	1
STORAGE STACK High Gloss Flip Door Top Stacker	18 x 15 x 7	1
STORAGE STACK Open Middle Stacker	24 x 15 x 14	1
ACCESSORY SHELF Bottom Rail	66 x 15 x 02	1

378221

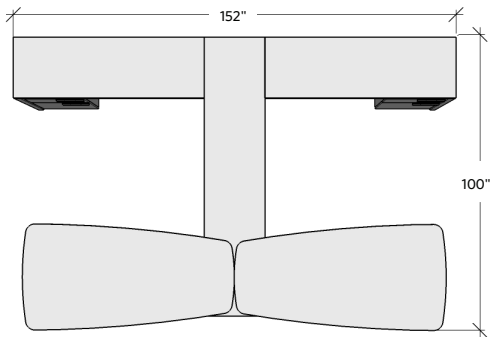
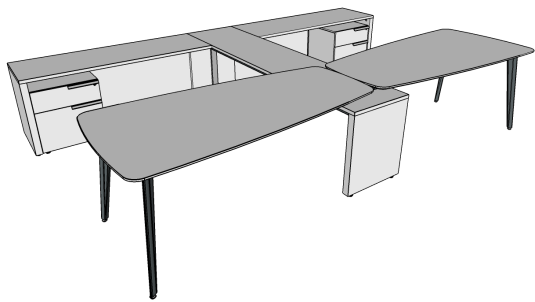

ITEM	L x D x H	QTY.
POWERSHELF No Modesty, Double Sided	96 x 21 x 26	1
WORKSURFACE Arc Taper w/ Knife Edge	72 x 36 x 30	2
RETURN Full Modesty	66 x 21 x 26	2
UNDER POWERSHELF STORAGE Box/File	21 x 19 x 21	2

378222

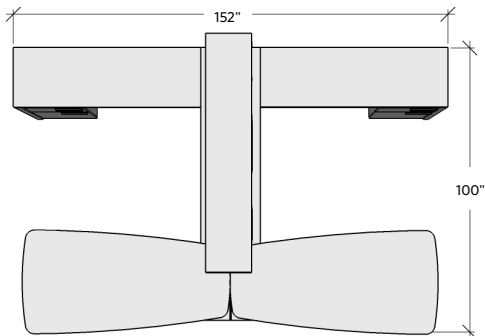
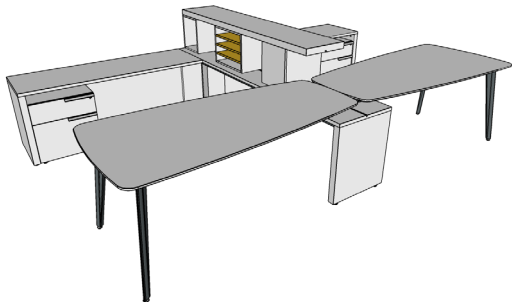

ITEM	L x D x H	QTY.
POWERSHELF No Modesty, Double Sided	96 x 21 x 26	1
WORKSURFACE Arc Taper w/ Knife Edge	72 x 36 x 30	2
RETURN Full Modesty	66 x 21 x 26	2
UNDER POWERSHELF STORAGE Box/File	21 x 19 x 21	2
STORAGE STACK Open Middle Stacker	12 x 15 x 14	2
STORAGE STACK 3 Decorative Shelves Middle Stacker	18 x 15 x 14	1
ACCESSORY SHELF Bottom Rail	78 x 15 x 02	1

378223

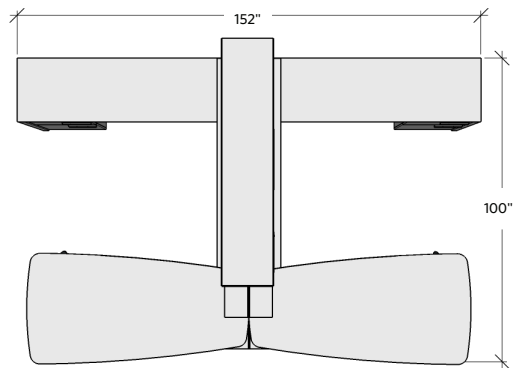
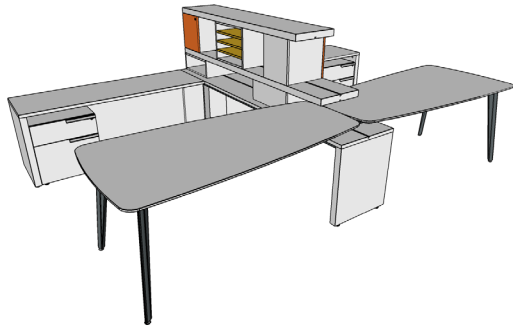

ITEM	L x D x H	QTY.
POWERSHELL No Modesty, Double Sided	96 x 21 x 26	1
WORKSURFACE Arc Taper w/ Knife Edge	72 x 36 x 30	2
RETURN Full Modesty	66 x 21 x 26	2
UNDER POWERSHELL STORAGE Box/File	21 x 19 x 21	2
STORAGE STACK High Gloss Door Middle Stacker	12 x 15 x 14	2
STORAGE STACK 3 Decorative Shelves Middle Stacker	18 x 15 x 14	1
ACCESSORY SHELF Top & Bottom Rail	84 x 15 x 02	1
ACCESSORY SHELF Bottom Rail	72 x 15 x 02	1
STORAGE STACK Open Middle Stacker	18 x 15 x 7	2

378224

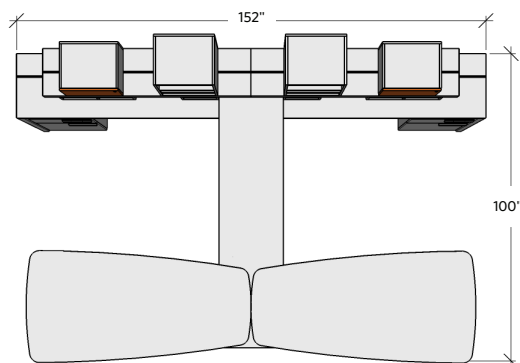
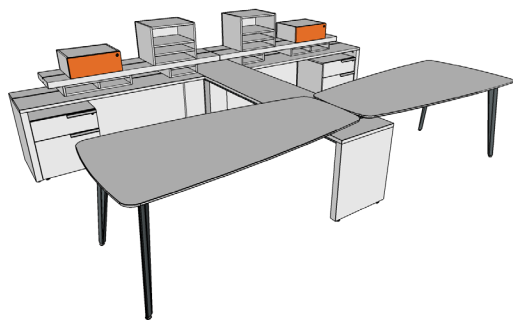

ITEM	L x D x H	QTY.
POWERSHELL No Modesty, Double Sided	96 x 21 x 26	1
WORKSURFACE Arc Taper w/ Knife Edge	72 x 36 x 30	2
RETURN Full Modesty	66 x 21 x 26	2
UNDER POWERSHELL STORAGE Box/File	21 x 19 x 21	2
STORAGE STACK Open Middle Stacker	24 x 15 x 3.5	2
STORAGE STACK Open Middle Stacker	12 x 15 x 3.5	2
ACCESSORY SHELF Top & Bottom Rail	66 x 15 x 02	2
STORAGE STACK High Gloss Flip Door Middle Stacker	18 x 15 x 7	2
STORAGE STACK 2 Shelves Top Stacker	18 x 15 x 7	2

378225

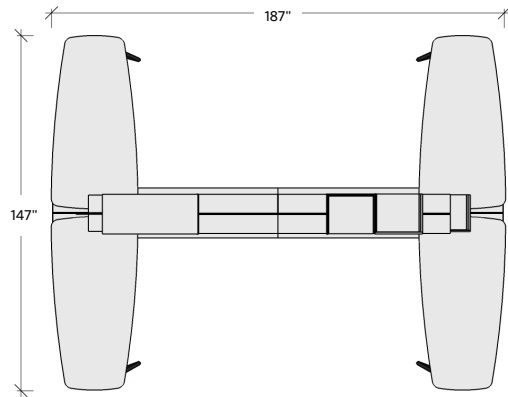
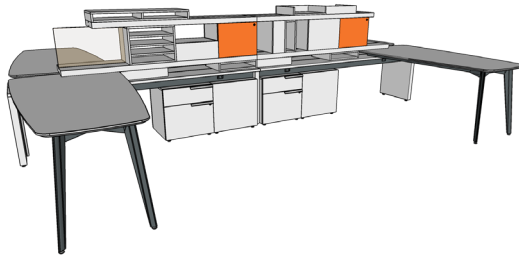

ITEM	L x D x H	QTY.
POWERSHELF No Modesty, Double Sided	96 x 21 x 26	2
WORKSURFACE Arc Taper w/ Knife Edge	72 x 36 x 30	4
UNDER POWERSHELF STORAGE Box File	21 x 19 x 21	4
STORAGE STACK Open Middle Stacker	18 x 15 x 3.5	4
STORAGE STACK Open Middle Stacker	6 x 15 x 14	2
STORAGE STACK High Gloss Door Middle Stacker	24 x 15 x 3.5	3
STORAGE STACK Open Top Stacker w/ No Top	18 x 15 x 3.5	2
STORAGE STACK Open Top Stacker	18 x 15 x 3.5	1
STORAGE STACK High Gloss Flip Door Top Stacker	18 x 15 x 7	1
STORAGE STACK 3 Shelves Middle Stacker w/ No Back	18 x 15 x 14	1
STORAGE STACK Open Top Stacker w/ No Back	36 x 15 x 3.5	1
ACCESSORY DIVIDE Smoked Acrylic	24 x 15 x 15	1
ACCESSORY SHELF Top & Bottom Rail	66 x 15 x 02	2
ACCESSORY SHELF Top & Bottom Rail	78 x 15 x 02	2

378226

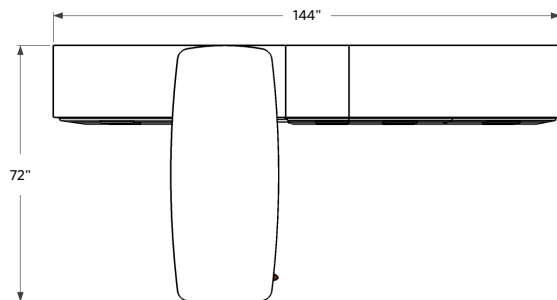
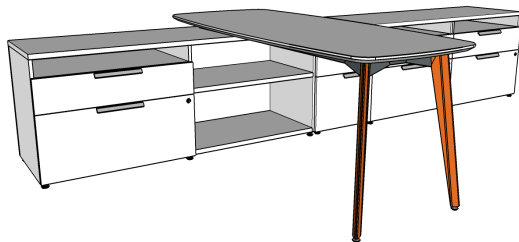

ITEM	L x D x H	QTY.
LOW STORAGE, DOUBLE BAY File/ Box + File/ Box	60 x 21 x 26	1
LOW STORAGE, DOUBLE BAY File/ Box + Open	66 x 21 x 26	1
LOW STORAGE, SINGLE BAY File/ Box	18 x 21 x 26	1
WORKSURFACE Double Arc w/ Knife Edge	72 x 30 x 30	1

378937

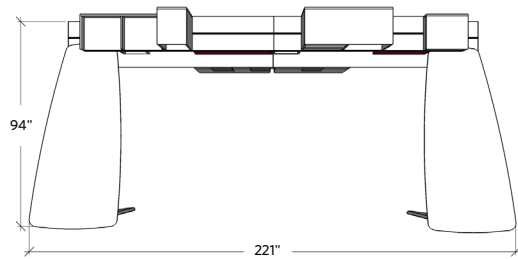
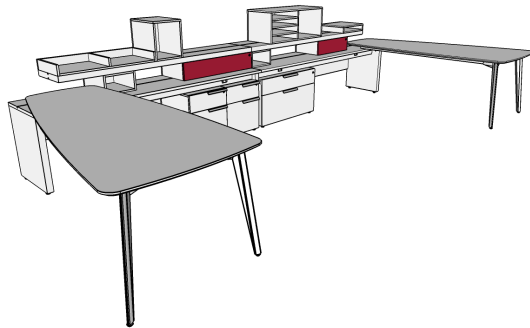

ITEM	L x D x H	QTY.
POWERSHELF 14"H Modesty, Single Sided	96 x 21 x 26	2
WORKSURFACE Arc Wing w/ Knife Edge	84 x 42 x 30	2
UNDER POWERSHELF STORAGE Box File	21 x 19 x 21	2
UNDER POWERSHELF STORAGE Box File	36 x 19 x 21	1
STORAGE STACK Open Middle Stacker	12 x 15 x 7	2
STORAGE STACK Open Top Stacker	12 x 15 x 14	1
STORAGE STACK Open Top Stacker	18 x 15 x 3.5	1
STORAGE STACK High Gloss Flip Door Middle Stacker	24 x 15 x 7	1
STORAGE STACK Open Top Stacker w/ No Top	36 x 15 x 3.5	1
STORAGE STACK High Gloss Flip Door Middle Stacker	36 x 15 x 7	1
STORAGE STACK 3 Shelves/ Open Top Stacker	36 x 15 x 14	1
ACCESSORY SHELF Top & Bottom Rail	84 x 15 x 02	2

378938

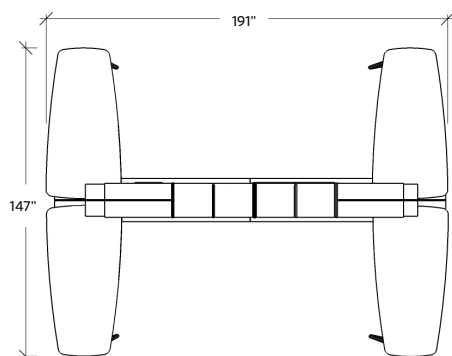
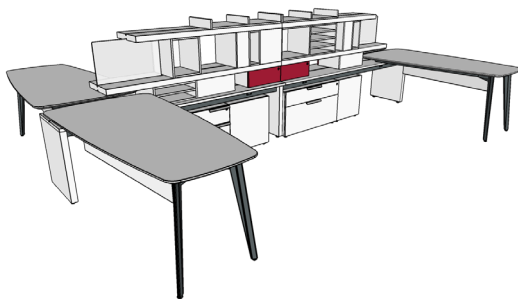

ITEM	L x D x H	QTY.
POWERSHELF No Modesty, Double Sided	96 x 21 x 26	2
WORKSURFACE Arc Taper w/ Knife Edge	72 x 36 x 30	4
UNDER POWERSHELF STORAGE Box File	16 x 19 x 21	1
UNDER POWERSHELF STORAGE Box File	21 x 19 x 21	2
UNDER POWERSHELF STORAGE Box File	36 x 19 x 21	1
STORAGE STACK Open Middle Stacker	6 x 15 x 14	4
STORAGE STACK Open Middle Stacker	12 x 15 x 14	2
STORAGE STACK 1 Shelf Middle Stacker, No Back	18 x 15 x 7	1
STORAGE STACK High Gloss Flip Door Middle Stacker	18 x 15 x 7	4
STORAGE STACK Open Top Stacker w/ No Top	36 x 15 x 3.5	2
STORAGE STACK Open/ 3 Shelves Middle Stacker	36 x 15 x 14	1
ACCESSORY SHELF Top & Bottom Rail	66 x 15 x 02	2
ACCESSORY SHELF Top & Bottom Rail	78 x 15 x 02	2
ACCESSORY DIVIDE Frosted Acrylic	24 x 15	2

378939

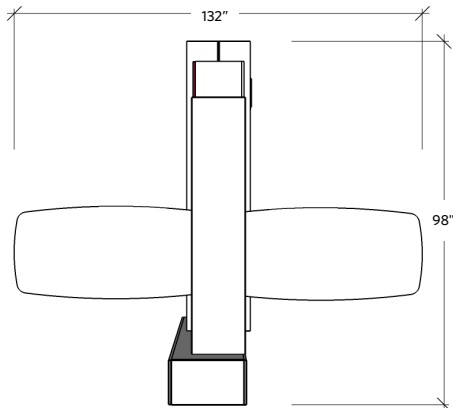
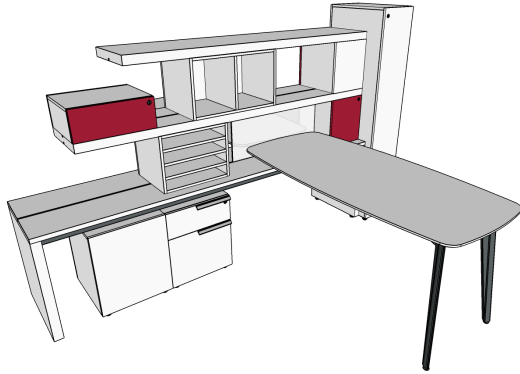

ITEM	L x D x H	QTY.
POWERSHELF No Modesty, Double Sided	96 x 21 x 26	1
WORKSURFACE Double Arc w/ Knife Edge	66 x 30 x 30	2
UNDER POWERSHELF STORAGE Box File	16 x 19 x 21	2
STORAGE STACK 3 Shelves Middle Stacker	18 x 15 x 14	1
STORAGE STACK High Gloss Door Middle Stacker	12 x 15 x 14	2
STORAGE STACK High Gloss Flip Door Top Stacker	18 x 15 x 7	1
STORAGE STACK Open Middle Stacker	24 x 15 x 14	1
ACCESSORY DIVIDE Frosted Acrylic	30L x 15H	1
ACCESSORY SHELF Top & Bottom Rail	84 x 15 x 02	1
ACCESSORY SHELF Bottom Rail	72 x 15 x 02	1
STORAGE WARDROBE Single Sided	12 x 21 x 64	1

378940

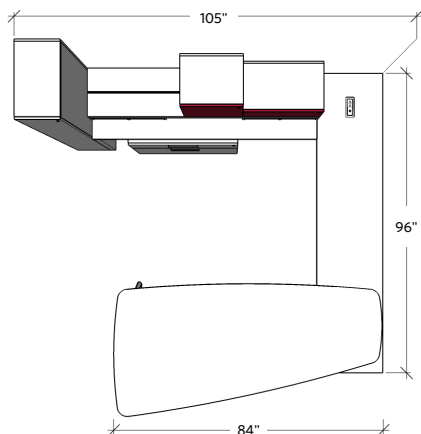
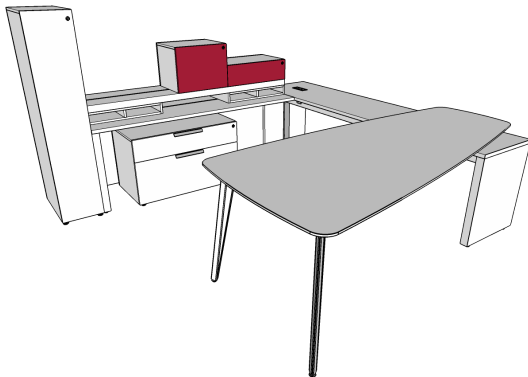

ITEM	L x D x H	QTY.
POWERSHELF No Modesty, Double Sided	96 x 21 x 26	1
RETURN Full Modesty, Single Sided	72 x 21 x 26	1
WORKSURFACE Arc Wing w/ Knife Edge	84 x 42 x 30	1
UNDER POWERSHELF STORAGE Box File	36 x 19 x 21	1
STORAGE WARDROBE Single Sided	12 x 21 x 57	1
STORAGE STACK Open Middle Stacker	24 x 15 x 3.5	2
STORAGE STACK High Gloss Flip Door Top Stacker	24 x 15 x 7	1
STORAGE STACK High Gloss Door Top Stacker	18 x 15 x 14	1
ACCESSORY SHELF Top & Bottom Rail	72 x 15 x 02	1

378941

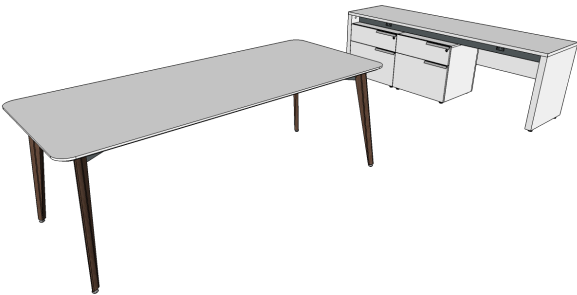

ITEM	L x D x H	QTY.
UNDER POWERSHELF STORAGE Box File	24 x 19 x 21	2
POWERSHELF 14"H Modesty, Single Sided	84 x 21 x 26	1
WORKSURFACE Rectangular w/ Knife Edge	84 x 36 x 30	1

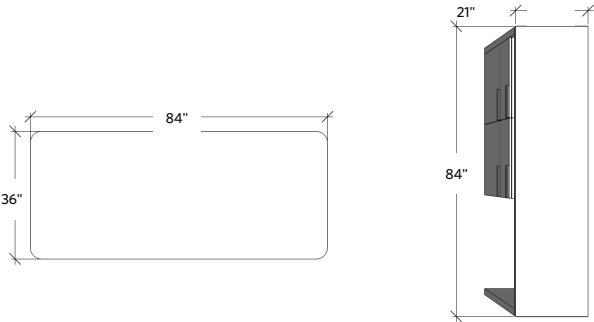

378942

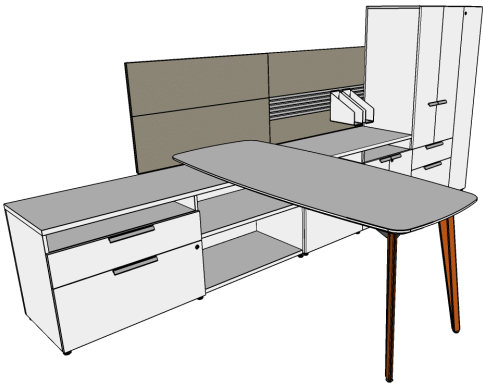

ITEM	L x D x H	QTY.
WORKSURFACE Double Arc w/ Knife Edge	72 x 30 x 30	1
LOW STORAGE, DOUBLE BAY Box File/ Laminate Doors	48 x 21 x 26	1
LOW STORAGE, DOUBLE BAY Box File/ Open	66 x 21 x 26	1
TALL STORAGE Box File Lower/ Laminate Doors Upper	24 x 21 x 64	1
STORAGE WARDROBE Single Sided	12 x 21 x 64	1
WALL BOARD Premiere Line Tackboard/ Toolrail	42L x 27H	1
WALL BOARD Premiere Line Tackboard	42L x 27H	1
RAIL ACCESSORY Binder Bin	4 x 10 x 8.5	2

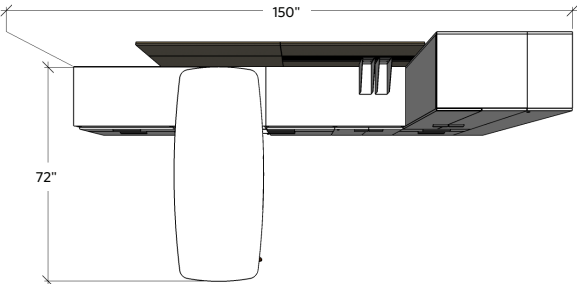

380280

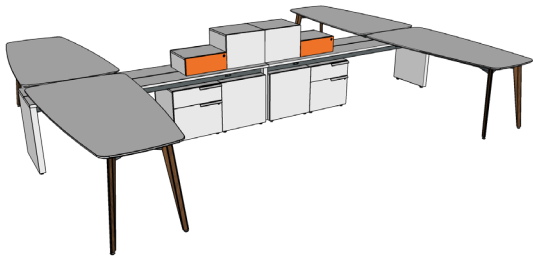

ITEM	L x D x H	QTY.
POWERSHELF No Modesty, Double Sided	96 x 21 x 26	2
WORKSURFACE Arc Taper w/ Knife Edge	72 x 36 x 30	4
UNDER POWERSHELF STORAGE Box File	21 x 19 x 21	4
STORAGE STACK Open Top Stacker	18 x 15 x 14	2
STORAGE STACK High Gloss Flip Door Top Stacker	18 x 15 x 7	2

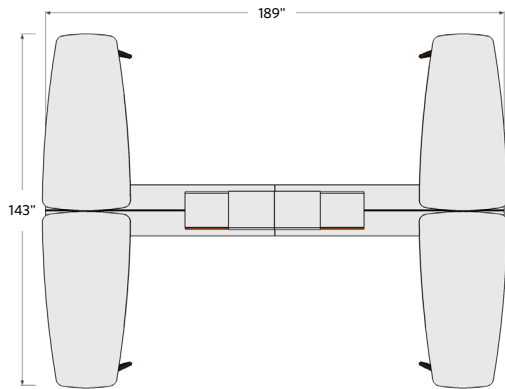

380281

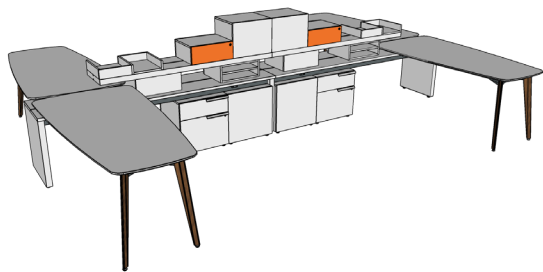

ITEM	L x D x H	QTY.
POWERSHELF No Modesty, Double Sided	96 x 21 x 26	2
WORKSURFACE Arc Taper w/ Knife Edge	72 x 36 x 30	4
UNDER POWERSHELF STORAGE Box File	21 x 19 x 21	4
STORAGE STACK 1 Shelf Middle Stacker	18 x 15 x 7	2
STORAGE STACK Open Middle Stacker	18 x 15 x 7	2
ACCESSORY SHELF Top & Bottom Rail	72 x 15 x 02	2
STORAGE STACK L Shape Top Stacker, No Top	12 x 15 x 3.5	4
STORAGE STACK High Gloss Flip Door Top Stacker	18 x 15 x 7	2
STORAGE STACK Open Top Stacker	18 x 15 x 14	2

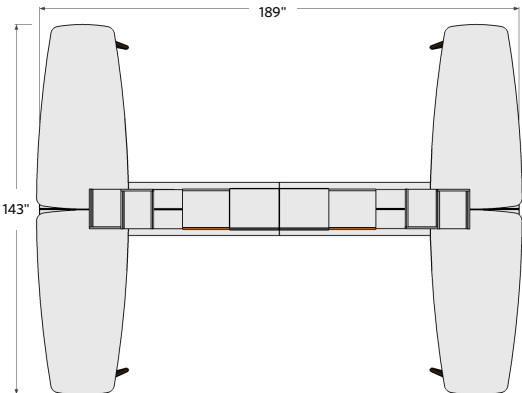

380282

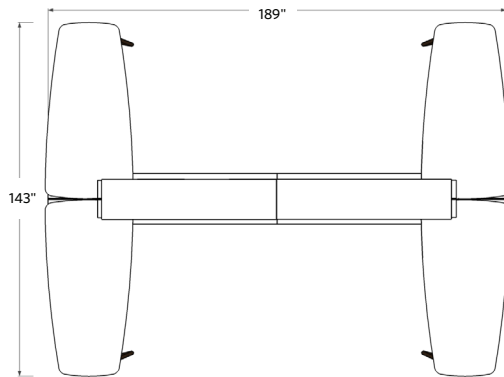
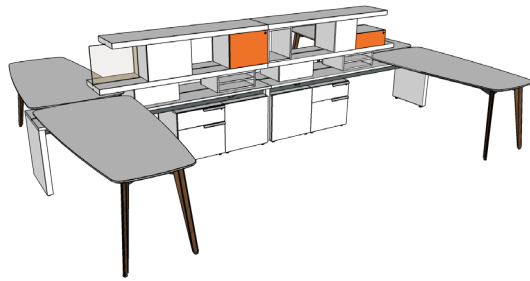

ITEM	L x D x H	QTY.
POWERSHELF No Modesty, Double Sided	96 x 21 x 26	2
WORKSURFACE Arc Taper w/ Knife Edge	72 x 36 x 30	4
UNDER POWERSHELF STORAGE Box File	21 x 19 x 21	4
STORAGE STACK 1 Shelf Middle Stacker	18 x 15 x 7	2
STORAGE STACK Open Middle Stacker	18 x 15 x 7	2
ACCESSORY SHELF Top & Bottom Rail	72 x 15 x 02	2
STORAGE STACK High Gloss Flip Door Top Stacker	18 x 15 x 7	1
STORAGE STACK High Gloss Door Middle Stacker	12 x 15 x 14	1
STORAGE STACK Open Middle Stacker	12 x 15 x 14	1
STORAGE STACK High Gloss Door Middle Stacker	18 x 15 x 14	2
ACCESSORY SHELF Bottom Rail	66 x 15 x 02	2
ACCESSORY DIVIDE Smoked Acrylic	18L x 15H	1

380283

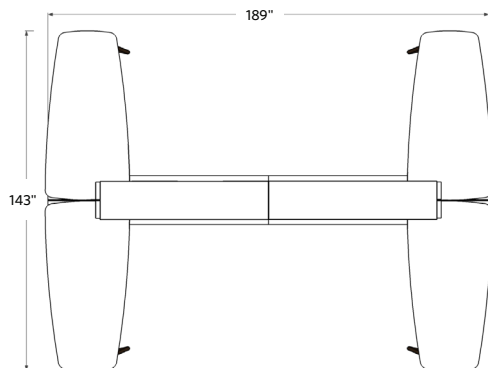
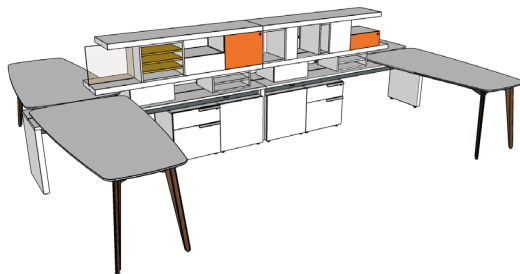

ITEM	L x D x H	QTY.
POWERSHELF No Modesty, Double Sided	96 x 21 x 26	2
WORKSURFACE Arc Taper w/ Knife Edge	72 x 36 x 30	4
UNDER POWERSHELF STORAGE Box File	21 x 19 x 21	4
STORAGE STACK 1 Shelf Middle Stacker	18 x 15 x 7	2
STORAGE STACK Open Middle Stacker	18 x 15 x 7	2
ACCESSORY SHELF Top & Bottom Rail	72 x 15 x 02	2
STORAGE STACK High Gloss Flip Door Top Stacker	18 x 15 x 7	1
STORAGE STACK High Gloss Door Middle Stacker	12 x 15 x 14	1
STORAGE STACK Open Middle Stacker	12 x 15 x 14	1
STORAGE STACK High Gloss Door Middle Stacker	18 x 15 x 14	2
ACCESSORY SHELF Bottom Rail	66 x 15 x 02	2
ACCESSORY DIVIDE Smoked Acrylic	18L x 15H	1
STORAGE STACK Open Middle Stacker	6 x 15 x 14	2
STORAGE STACK 3 Accent Shelves Middle Stacker	18 x 15 x 14	1

380284

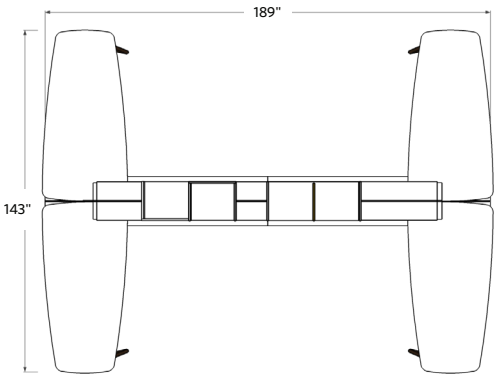
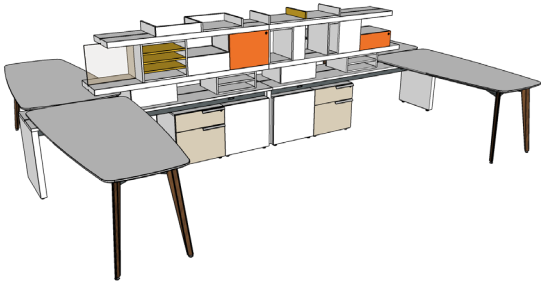

ITEM	L x D x H	QTY.
POWERSHELF No Modesty, Double Sided	96 x 21 x 26	2
WORKSURFACE Arc Taper w/ Knife Edge	72 x 36 x 30	4
UNDER POWERSHELF STORAGE Box File	21 x 19 x 21	4
STORAGE STACK 1 Shelf Middle Stacker	18 x 15 x 7	2
STORAGE STACK Open Middle Stacker	18 x 15 x 7	2
ACCESSORY SHELF Top & Bottom Rail	72 x 15 x 02	2
STORAGE STACK High Gloss Flip Door Top Stacker	18 x 15 x 7	1
STORAGE STACK Acrylic Door Middle Stacker	12 x 15 x 14	1
STORAGE STACK Open Middle Stacker	12 x 15 x 14	1
STORAGE STACK High Gloss Door Middle Stacker	18 x 15 x 14	2
ACCESSORY SHELF Top & Bottom Rail	66 x 15 x 02	2
ACCESSORY DIVIDE Smoked Acrylic	18L x 15H	1
STORAGE STACK Open Middle Stacker	6 x 15 x 14	2
STORAGE STACK 3 Accent Shelves Middle Stacker	18 x 15 x 14	1
STORAGE STACK Open Top w/ No Top & No Side	18 x 15 x 3.5	2
STORAGE STACK Open Top w/ No Top & No Back	36 x 15 x 3.5	1

Three H Furniture Systems Limited

156462 Clover Valley Rd.
New Liskeard, ON
Canada POJ 1P0

T. 1.800.767.5374

F. 1.888.484.5786

customer.service@three-h.com

www.three-h.com



Revision 3, June 2021

©2021 Three H Furniture Systems Limited. All rights reserved.